

Type	Size	Description	Part No.
Incandescent	T6 (T-1¾)	Midget Grooved Lamp	(see table)

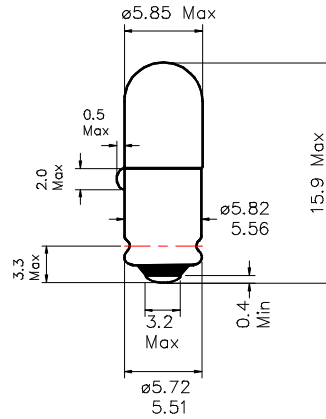

Drawing not to scale
All dimensions in mm

PHOTOMETRY DATA

Farnell Part No.	SLI P/N	Lamp Rating	Test Volts	Current (mA)			Light Output (Lm)			Fil Shape	Life (Hrs)
				Min	Nom	Max	Min	Nom	Max		
328790	379	6.3V 1.26W	6.3	180	200	220	3.8	5.0	6.2	C-2R	20000
653688	386	14V 1.12W	14	72	80	88	2.8	3.8	4.8	C-2F	15000
328807	336	14V 1.12W	14	72	80	88	4.7	6.3	7.9	C-2F	1000
328819	334	28V 1.12W	28	36	40	44	3.2	4.3	5.4	C-2F	4000
653690	388	28V 1.12W	28	36	40	44	2.8	3.8	4.8	C-2F	7000
265329	788	36V 1.08W	36	27	30	33	2.6	3.5	4.4	C-2F	5000
328820	790	48V 1.2W	48	22	25	28	1.7	2.5	3.3	CC-2F	5000
328832	799	60V 1.2W	60	18	20	22	1.6	2.2	2.8	CC-2F	5000

NOTES:

- 1) S5.7s midget grooved cap in accordance with IEC 61-1, (BS EN 60061-1), sheet 7004-62-x.
- 2) Metal base to be durably marked with rating and trademark.