

CML3901 Series Ordering Information

Part	Height	Base	Seq #
CML3901-	20	- 3	- 101
CML3901-	25	- 3	- 101
CML3901-	30	- 3	- 101
CML3901-	35	- 3	- 101

LED Heat Sink Specification

- 1. Material: Al 6063
- 2. Dimension:
Foot print: Ø39mm
- 3. Finish: Black Anodize

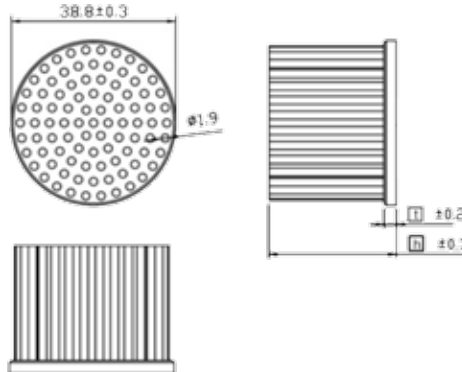

Performance

Results Based On Natural Convection	
Height	oC/W
CML3901-20-3-101	7.67
CML3901-25-3-101	7.10
CML3901-30-3-101	6.61
CML3901-35-3-101	6.31