

TOOLS & ACCESSORIES

Crimp Tools



CT4L (RECOMMENDED)

CRIMP TOOL (Die not included, for crimp dies see below)
FRAME CT4L (BLACK W/ LONGER ERGONOMIC HANDLE)

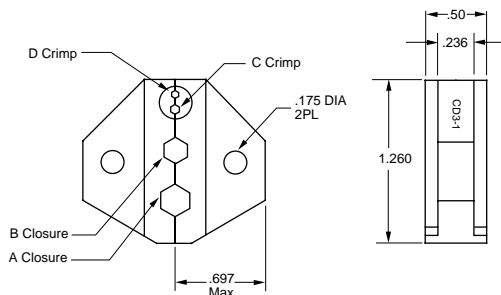

Outer Sleeve	A	Embosses	B	Embosses
CD3-1	.213	1A	.178	1B
CD3-2	.324	2A	.255	2B
CD3-3	.344	3A	.290	3B
CD3-5	-	-	.197	5B
CD3-21	.290	290	.255	255
CD3-22	.404	404	.068	-

For crimp dies not listed, call the factory.



TWINAX/TRIAX CRIMP TOOL FOR BUSHING/SHIELD

CRIMP TOOL ONLY **M22520/5-01**
 CRIMP TOOL WITH DIE **M22520/5-01/CD5-#**

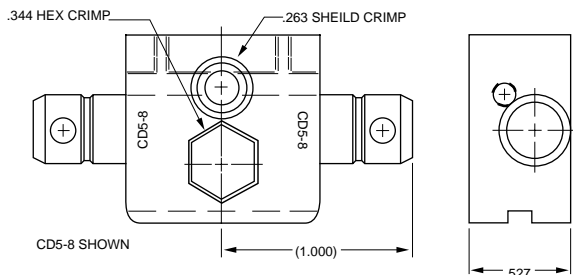

(Daniels HX4 or equivalent)

For Standard and Miniature Twinax/Triax patching: 70 Series: TRB/TRT, 150 Series: TRS/TTM, 450 Series: 2-lug/3-lug/threaded connectors.

Connector Series	Cable Type	Cable Group#	Bushing/Shield Crimp Die	Center Contact Crimp Tool Part #	Center Contact Positioner Part #
70C PLR70C PLR155AC	Twinax	201-225	CD5-8 (Daniels Y778)	M22520/1-01 (Daniels AF8 or equivalent)	010-0044 Pin (TP837)
	Triax	301-309	CD5-10 (Daniels Y776)		010-0045 Socket (TP838)
Small Body 150AC	Twinax	201-206, 208, 209, 217-223	CD5-9 (Daniels Y687)	M22520/2-01 (Daniels AFM8 or equivalent)	010-0041
	Triax	301-304, 309	CD5-11 (Daniels Y777)		
Large Body 150AC	Twinax	207, 210, 211-216, 224-225	CD5-8 (Daniels Y778)	M22520/2-01 (Daniels AFM8 or equivalent)	010-0043
	Triax	305-306, 308	CD5-13 (Daniels Y803)		
	Triax	307	CD5-10 (Daniels Y776)		M22520/1-01
PL75MC	Twinax	201-225	CD5-14	M22520/2-01 (Daniels AFM8 or equiv)	010-0096
		226	CD5-15		M22520/2-01
450AC	Twinax	201-206, 208, 209, 212, 217-223	CD5-9 (Daniels Y687)	M22520/2-01	010-0041
PLR450	Twinax	201-206, 208, 209, 212, 217-223	CD5-120 (Daniels Y789(F))	M22520/2-01 (Daniels AFM8 or equivalent)	010-0041
M39029/90-529 SPC8P- M39029/91-530 SPC8S-	Twinax	201-205, 217, 218, 221,222	CD5-4 (Daniels Y631)	M22520/2-01 (Daniels AFM8 or equivalent)	Daniels K709
	Triax	301-303	CD5-7 (Daniels Y775)		

* Note: Dies imprint either cavity (A/B) or hex size onto crimp sleeve. Custom dies are available for special imprints.