

Accessories – Specific functions and variations

Screen plug (LS)

A screen plug (LS) is available for many terminals in the W-Series. The bar can be used to continue the shielding over the terminals as an interface. There is no direct connection to earth potential.

Assembly

The screen plug is placed flat in the bottom of the terminal in the recess provided. At the ends, the shield can be plugged in with a 2.8 mm Faston connector or also soldered on.

Reduced rated voltage

The smaller clearance and creepage sections result in a reduced voltage rating in the terminal when using the screen plug.

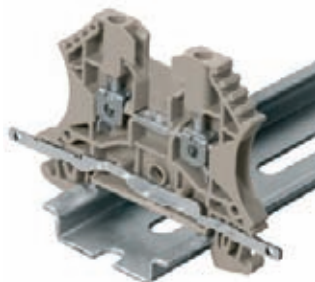

LS 2.8

| Type             | Qty. | Order No.  |
|------------------|------|------------|
| LS 2.8 WDU2.5-10 | 50   | 1056400000 |

Reduced voltage

| For standard terminal | Reduced voltage |
|-----------------------|-----------------|
| WDU 1.5/ZZ            | 400 V           |
| WDU 2.5/1.5/ZR        | 400 V           |
| WDU 2.5               | 400 V           |
| WDU 4                 | 400 V           |
| WDU 6                 | 400 V           |
| WDU 10                | 400 V           |
| WDK 2.5 ZQV           | 250 V           |
| WDK 2.5 (WQV)         | 250 V           |
| WTR 2.5...            | 250 V           |

| For compact terminal | Reduced voltage |
|----------------------|-----------------|
| WDK 2.5N             | 250 V           |
| WDK 4N               | 250 V           |

Short-circuit plug (WDS)

Short-circuit plugs (cross-connection plugs) are used together with sockets (diameter 2.3 mm) for easily disconnected cross-connection of terminals.

In the real world, this connector is used very often with test-disconnect terminals. Thanks to its insulated grip, the WDS is touch-safe.

Assembly

The plug is simply plugged onto the socket and locks automatically.

For terminal width 5.1 mm



WDS

| Type  | Qty. | Order No.  |
|-------|------|------------|
| WDS 2 | 20   | 1069900000 |

Reduced voltage

| For terminal     |
|------------------|
| WDU 1.5/ZZ       |
| WDU 2.5/1.5/ZR   |
| WDU 2.5          |
| WDK 2.5... (WQV) |
| WTR 2.5...       |
| WDU 2.5 F...     |

Extension connector (WZAD)

Assembly

This connector consists of a metal part which is pushed into the terminal and lodges behind the clamping yoke. The WZAD extension connector is connected to the "main" conductor in the terminal. Another conductor of up to 4 mm<sup>2</sup> and 32A can be screwed to the outer end of the extension connector using a ring cable lug.



An extension connector (WZAD) is offered for feed-through terminals from 70 mm<sup>2</sup>.



Exception WZAD WDU 240

The extension connector for WDU 240 is separately plugged into the terminal above the wire entry and locks automatically. The conductor is connected with a fully insulated screw connection.



WZAD

| Type          | Clamped conductor        | Rated current | Qty. | Order No.  | For terminal |
|---------------|--------------------------|---------------|------|------------|--------------|
| WZAD 70/95    | up to 4 mm <sup>2</sup>  | 32 A          | 10   | 1066000000 | WDU 70/95    |
| WZAD 120/150  | up to 4 mm <sup>2</sup>  | 32 A          | 10   | 1066100000 | WDU 120/150  |
| WZAD 240      | up to 10 mm <sup>2</sup> | 57 A          | 5    | 1802810000 | WDU 240      |
| WZAD 50N      | up to 10 mm <sup>2</sup> | 40 A          | 5    | 1872720000 | WDU 50N      |
| WZAD 70N      | up to 4 mm <sup>2</sup>  | 32 A          | 10   | 9512280000 | WDU 50N/70N  |
| WZAD 95N/120N | up to 10 mm <sup>2</sup> | 41 A          | 5    | 1959580000 | WDU 95N/120N |

WZAD

| Type     | Clamped conductor | Rated current | Qty. | Order No.  | For terminal |
|----------|-------------------|---------------|------|------------|--------------|
| WZAF 35  | 4 mm <sup>2</sup> | 32 A          | 10   | 1070500000 | WFF 35       |
| WZAF 70  | 4 mm <sup>2</sup> | 32 A          | 10   | 1066200000 | WFF 70       |
| WZAF 120 | 4 mm <sup>2</sup> | 32 A          | 10   | 1066300000 | WFF 120      |
| WZAF 185 | 4 mm <sup>2</sup> | 32 A          | 10   | 1066400000 | WFF 185      |
| WZAF 300 | 4 mm <sup>2</sup> | 32 A          | 10   | 1066500000 | WFF 300      |