

ALUSTAR 1W | 110°

- Verschiedene Abstrahlwinkel
- Anschlussfertige Modultechnik
- Stabiles Wärmemanagement
- Schutzklasse IP65
- Many different angles
- Ready to use modular technology
- Stable thermal management
- Ingress protection IP65

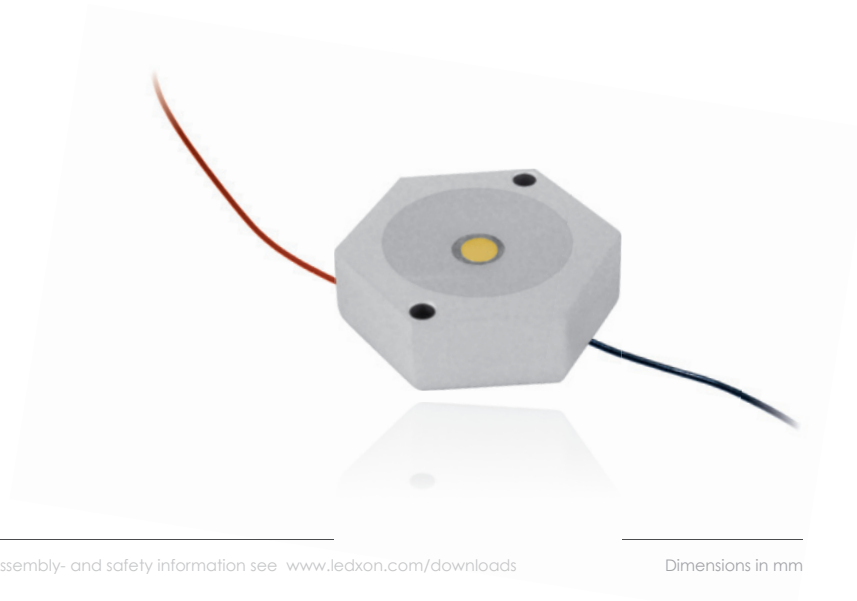

Für Montage- und Sicherheitshinweise siehe www.ledxon.de/downloads / For assembly- and safety information see www.ledxon.com/downloads

Dimensions in mm

Betriebsstrom DC / Operating current	350mA
Typ. Leistung / Wattage	1 W
Elektrischer Anschluss / Electrical source	only use with 350mA current source
LED Typ / LED type	Edison® Edixeon®
Abstrahlwinkel / Angle	110°
Schutzart / Ingress protection	IP65
Dimmung / Dimming	Current reduction / PWM
max. Sperrspannung / Reverse voltage	5V
Betriebstemperatur / Operating temperature	-20°C - +40°C

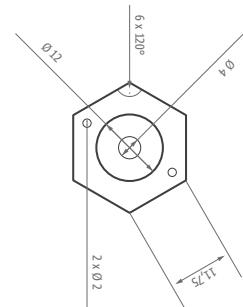
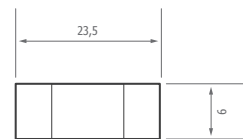

Artikelbez. Discription	Art.-Nr. Part.-No.	Lichtfarbe Light colour	Color temp. (K)* Wavelength (nm)*	Lumen* Luminance	Spannung Voltage		CRI*
					min.	max.	
Alustar 1W 110°	9008003	ww	2700K	66lm	2.8V	3.5V	75
Alustar 1W 110°	9008200	nw	4300K	66lm	2.8V	3.5V	75
Alustar 1W 110°	9008001	cw	6000K	100lm	2.8V	3.5V	75
Alustar 1W 110°	9008057	red	623nm	51.2lm	2.0V	3.0V	-
Alustar 1W 110°	9008059	yellow	592nm	60lm	2.0V	3.0V	-
Alustar 1W 110°	9008060	green	525nm	86.5lm	2.8V	3.5V	-
Alustar 1W 110°	9008058	blue	470nm	23.3lm	2.8V	3.5V	-

* Werte können durch Schwankungen im Herstellungsprozess abweichen / Technical variations possible. based on production tolerances