

Centre horizontal rail, type ST



Part no.:
34561-
084

Features:

- For indirect backplane mounting with insulation strip

Standard pack quantity 10



Technical information:

Usable length	Length
84 HP	431,8 mm



Indirect backplane mounting
(with insulation strips)

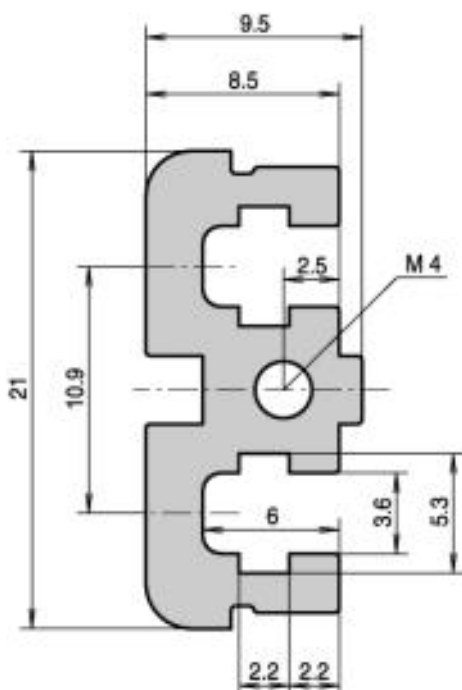

Delivery comprises:

Item	Qty	Description
1	1	Horizontal rail, Al-Profile, anodised

Accessories:

Part no.	Description	

Product illustrations are exemplary illustrations and can deviate from supplied products.	24560-130	Panhead screw with torx M4 x 14, St, zinc plated, PU 100 pieces	
	<p>Note:</p> <ul style="list-style-type: none">• Delivery is exclusively in standard pack quantity• Without printing		