

INTERCONNECTION

High Temperature Resistant Connection Blocks

- Porcelain body rated to 1000°C
- Inserts rated to 350°C
- 1 to 4 poles available
- 3, 3.5, 4.4 and 6mm insert diameter sizes
- CE marked



SPECIFICATION

Voltage (max)	450V AC
Working temperature	5°C to 350°C
Insulating body	Porcelain (DIN 40685)
Insert	Nickel-plated brass
Screws	Zinc-plated steel CQ-15

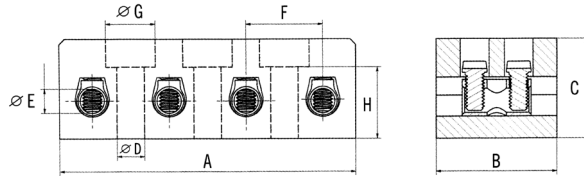

TYPE NO.	POLES	MAX. CURRENT	INSERT DIAMETER	MAX. CONDUCTOR:		LENGTH	WIDTH	HEIGHT	MOUNTING HOLE SIZE:		TERMINAL:	
				RIGID	FLEXIBLE				DIAMETER	SCREW HEAD	PITCH	SCREWS
CHTB4/1N	1	32A	3mm	4mm ²	4mm ²	10mm	18mm	17mm	-	-	-	M2.6
CHTB4/2N	2	32A	3mm	4mm ²	4mm ²	21.5mm	18mm	17mm	4.5mm	6.9mm	11.5mm	M2.6
CHTB4/3N	3	32A	3mm	4mm ²	4mm ²	33mm	18mm	17mm	4.5mm	6.9mm	11.5mm	M2.6
CHTB4/4N	4	32A	3mm	4mm ²	4mm ²	44.5mm	18mm	17mm	4.5mm	6.9mm	11.5mm	M2.6
CHTB6/1N	1	41A	3.5mm	6mm ²	4mm ²	11mm	20mm	17.5mm	-	-	-	M3
CHTB6/2N	2	41A	3.5mm	6mm ²	4mm ²	23.5mm	20mm	17.5mm	4.5mm	7.5mm	12.5mm	M3
CHTB6/3N	3	41A	3.5mm	6mm ²	4mm ²	36mm	20mm	17.5mm	4.5mm	7.5mm	12.5mm	M3
CHTB6/4N	4	41A	3.5mm	6mm ²	4mm ²	48.5mm	20mm	17.5mm	4.5mm	7.5mm	12.5mm	M3
CHTB10/1N	1	57A	4.4mm	10mm ²	6mm ²	12mm	22mm	18mm	-	-	-	M3.5
CHTB10/2N	2	57A	4.4mm	10mm ²	6mm ²	26mm	22mm	18mm	5mm	8.5mm	14mm	M3.5
CHTB10/3N	3	57A	4.4mm	10mm ²	6mm ²	40mm	22mm	18mm	5mm	8.5mm	14mm	M3.5
CHTB10/4N	4	57A	4.4mm	10mm ²	6mm ²	54mm	22mm	18mm	5mm	8.5mm	14mm	M3.5
CHTB16/1N	1	76A	6mm	16mm ²	10mm ²	16mm	30mm	23mm	-	-	-	M4
CHTB16/2N	2	76A	6mm	16mm ²	10mm ²	34mm	30mm	23mm	5mm	9mm	17.5mm	M4
CHTB16/3N	3	76A	6mm	16mm ²	10mm ²	52mm	30mm	23mm	5mm	9mm	17.5mm	M4
CHTB16/4N	4	76A	6mm	16mm ²	10mm ²	70mm	30mm	23mm	5mm	9mm	17.5mm	M4

PCB
TERMINAL
BLOCKS

INTER-
CONNECTION

FUSES &
FUSE-
HOLDERS

LEDs &
INDICATORS

MINIATURE
SWITCHES

LIMIT &
SAFETY
SWITCHES

CONTROL
PRODUCTS

INTERFACE
MODULES &
SUPPORTS

RELAY
BASES

ENCLOSURES

BATTERIES

TRANS-
FORMERS



+44 (0)1638 716101
info@camdenboss.com
www.camdenboss.com

We operate a constant improvement policy,
our products are subject to change without notice.

Ver 1.0

CAMDENBOSS
ELECTRONICS & ENCLOSURES