

# TOROIDAL FERRITE CLAMP/TFC•TFCM



Split cores with plastic housing for easy installation on wired cables

## Usage

- Harness guide provides easy harness winding and prevents pinching. TFC-\*\*\*\*\* excluded.
- New hinge allows no protrusion. TFC-\*\*\*\*\* excluded.

## Material

- Housing / Nylon 66 (Light gray / UL94V-0)
- Plate spring / Stainless steel (TFC-\*\*\*\*\* type only)
- Core / Soft ferrite

### TFC-\*\*\*\*\*

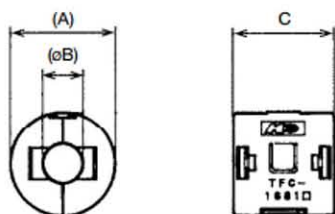

#### [Feature]

Space-saving simple configuration without protrusion of hinge part.

Unit: mm

Part No.	(A)	(B)	C	Applicable cable diameter	Impedance* Ω/100MHz (1 turn)
TFC-16813	19.8	7.6	18.9	ø7.2max	≥60
TFC-16816	19.8	7.6	21.9	ø7.2max	≥75

\*Contact us for the measurement conditions.

### TFCM-\*\*\*\*\*

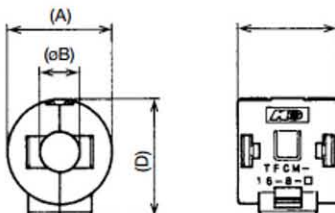

#### [Feature]

- Optional fixture available (refer to P 31-TFP)

Unit: mm

Part No.	(A)	(oB)	C	(D)	Applicable cable diameter	Impedance* /100MHz (1 turn)
TFCM-16-8-13	19.8	7.6	18.9	22.3	ø7.2max	60
TFCM-16-8-16	19.8	7.6	21.9	22.3	ø7.2max	75

\*Contact us for the measurement conditions.

### TFCM-41-27-16

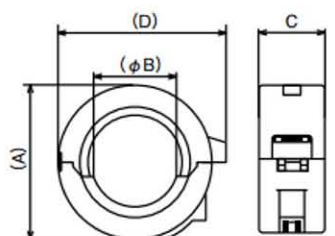

#### [Feature]

- Suitable for bundle diameter up to ø26mm.
- TFCM series come with pre-attached fixture for on enclosure, etc.

Unit: mm

Part No.	(A)	(oB)	C	(D)	Applicable cable diameter	Impedance* Ω/100MHz (1 turn)
TFCM-41-27-16	44	26.6	19.6	48.2	ø26max	≥60

\*Contact us for the measurement conditions.

### TFC-\*\*\*\*\*

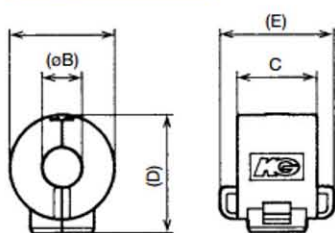

#### [Feature]

- Optional fixture available (refer to P 31-TFP).
- Incorporated with a metal spring.

Unit: mm

Part No.	(A)	(oB)	C	(D)	(E)	Applicable cable diameter	Impedance* Ω/100MHz (1 turn)
TFC-20-10-10	24.2	8.8	13.5	26.7	19.9	ø8.5max	≥50
TFC-23-11-14	27.4	10.8	17.5	29.9	23.9	ø10.5max	≥70
TFC-25-15-12A	28.2	13.6	13.7	30.9	20.1	ø13.0max	≥40

\*Contact us for the measurement conditions.