



REGULATORY AGENCY APPROVALS



Manufactured to meet the requirements of ANSI/IEEE C57.13.
Classified by U.L. in accordance with IEC 44-1



APPLICATION:
Metering.

FREQUENCY:
50-400 Hz.

INSULATION LEVEL:
600 Volts, 10 kV BIL full wave.

INSULATION SYSTEM:
Temperature Class H (180°C.)

**CONTINUOUS THERMAL
CURRENT RATING FACTOR:**
1.33 at 30°C. amb., 1.0 at 55°C. amb.

Terminals are brass studs No. 10-32 with one flatwasher, lockwasher and regular nut.

Approximate weight 6 lbs.

4

| CATALOG NUMBER | CURRENT RATIO | ANSI METERING CLASS AT 60HZ | | | | | SECONDARY WINDING RESISTANCE (OHMS @ 75°C) |
|----------------|---------------|-----------------------------|------|------|------|------|--|
| | | BO.1 | BO.2 | BO.5 | BO.9 | B1.8 | |
| 560-101 | 100:5 | 2.4 | — | — | — | — | 0.012 |
| 560-151 | 150:5 | 1.2 | 2.4 | — | — | — | 0.017 |
| 560-201 | 200:5 | 1.2 | 1.2 | — | — | — | 0.023 |
| 560-251 | 250:5 * | 0.6 | 1.2 | 2.4 | — | — | 0.038 |
| 560-301 | 300:5 * | 0.6 | 0.6 | 1.2 | — | — | 0.045 |
| 560-401 | 400:5 * | 0.6 | 0.6 | 1.2 | 2.4 | — | 0.095 |
| 560-501 | 500:5 * | 0.3 | 0.3 | 0.6 | 1.2 | 2.4 | 0.118 |
| 560-601 | 600:5 * | 0.3 | 0.3 | 0.6 | 1.2 | 1.2 | 0.142 |
| 560-751 | 750:5 * | 0.3 | 0.3 | 0.3 | 0.6 | 1.2 | 0.178 |
| 560-801 | 800:5 * | 0.3 | 0.3 | 0.3 | 0.6 | 0.6 | 0.190 |
| 560-102 | 1000:5 * | 0.3 | 0.3 | 0.3 | 0.6 | 0.6 | 0.211 |
| 560-122 | 1200:5 * | 0.3 | 0.3 | 0.3 | 0.3 | 0.6 | 0.253 |
| 560-152 | 1500:5 * | 0.3 | 0.3 | 0.3 | 0.3 | 0.6 | 0.368 |
| 560-162 | 1600:5 * | 0.3 | 0.3 | 0.3 | 0.3 | 0.6 | 0.262 |
| 560-202 | 2000:5 * | 0.3 | 0.3 | 0.3 | 0.3 | 0.6 | 0.328 |
| 560-252 | 2500:5 * | 0.3 | 0.3 | 0.3 | 0.3 | 0.3 | 0.410 |
| 560-302 | 3000:5 * | 0.3 | 0.3 | 0.3 | 0.3 | 0.3 | 0.347 |
| 560-322 | 3200:5 * | 0.3 | 0.3 | 0.3 | 0.3 | 0.3 | 0.370 |
| 560-402 | 4000:5 * | 0.3 | 0.3 | 0.3 | 0.3 | 0.3 | 0.462 |

Approved for revenue metering by Industry Canada No. AE-0659 (*)

Model 560

EXCITATION CURVE

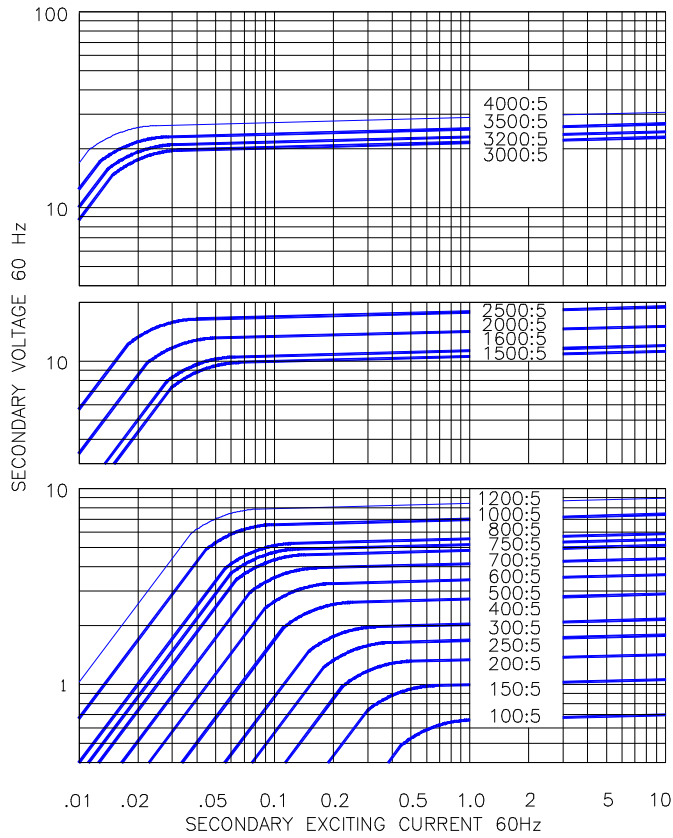

4

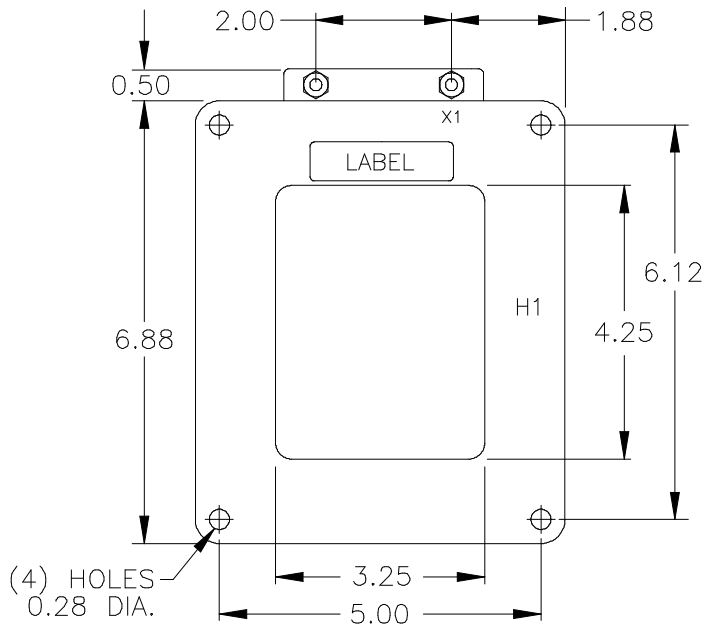
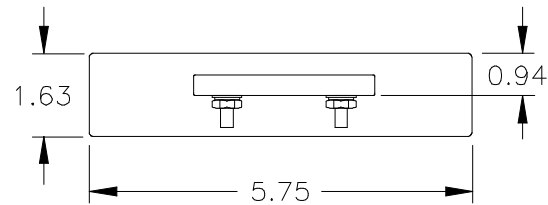

USA, Canada, Asia, Latin America

Tel: +1-800-547-8629

Fax: +1-905-201-2455

e-mail: sales.multilin@ge.com

Europe, Middle East, Africa

Tel: +34-94-485-88-00

Fax: +34-94-485-88-45

e-mail: gemultilin.euro@ge.com