

MALE END VIEW

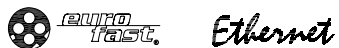

SPECIFICATIONS

CONTACT MATERIAL/PLATING	BRASS/GOLD
HOUSING MATERIAL/PLATING	BRASS/NICKEL
RATED CURRENT [A]	4.0 A
RATED VOLTAGE [V]	250 V
MAXIMUM WIRE SIZE	20 AWG
CABLE GRIP RANGE	4-6mm
TEMPERATURE RATING	-40°C to +85°C (-40°F to +185°F)
PROTECTION CLASS	IEC IP67
WIRE TERMINATION	SCREW TERMINAL

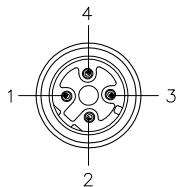
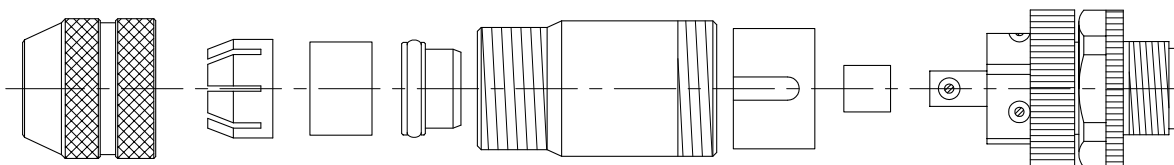

EXPLODED VIEW

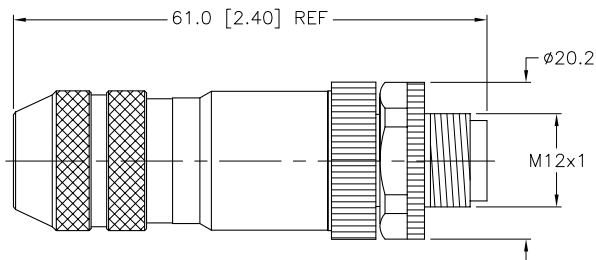

ASSEMBLED VIEW

SOURCE DRAWING - FOR REFERENCE ONLY

NOTES:

1. ALL METAL SHIELDED FIELD WIREABLE CONNECTOR.

RELATED DOCUMENTS 1. NOTE 2. PRELIMINARY SPECIFICATIONS 3. 4.		3RD ANGLE PROJECTION 	THIS DRAWING IS PROPERTY OF TURCK INC. USE OF THIS DOCUMENT WITHOUT WRITTEN PERMISSION IS PROHIBITED.		TURCK INC <i>High Technology Sensors and Automation Controls</i> 3000 CAMPUS DRIVE MINNEAPOLIS, MN 55441 1-800-544-7769 (763) 553-7300 (763) 553-0708 fax turck.com	
MATERIAL	SEE SPECIFICATIONS	DRFT	RDS	DATE	DESCRIPTION	
FINISH	SEE SPECIFICATIONS	DSGN		01/03/11	CMBSD 8141-0	
		UNIT OF MEASUREMENT		SCALE	IDENTIFICATION NO.	REV
		MILLIMETER [INCH]		1=1.0	U2-18483	P1
		CONTACT TURCK FOR MORE INFORMATION		DO NOT SCALE THIS DRAWING	FILE: U2-18483	SHEET 1 OF 1

P1		RDS	01/03/11	
REV	DESCRIPTION	BY	DATE	ECO NO.