

P0625

Lift Off Hinge

Material: Steel

Part Number	Finish	Description
P0625K	Black	
P0625Z	Zinc	

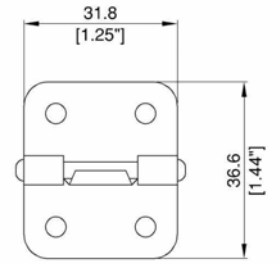

FIXING HOLES 4.3mm/.17"

P0644

Lift Off Hinge.

Material: 1.2mm/ 18 gauge Steel

Part Number	Finish	Description
P0644N	Nickel	

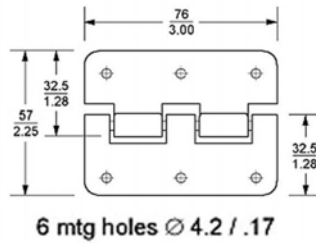

1993

Large Lift Off Hinge.
Special Order outside USA & China

Material: Steel

Part Number	Finish	Description
1993	Zinc	
1993BK	Black	

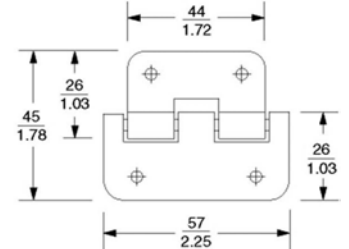
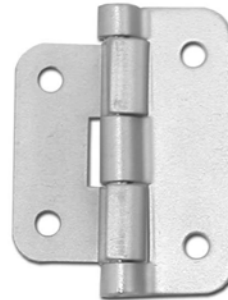

4 mtg holes Ø 4.8 / .19

1519

Lift Off Hinge.
Special Order outside USA & China

Material: Steel

Part Number	Finish	Description
1519	Zinc	
1519BK	Black	
1519N	Nickel	

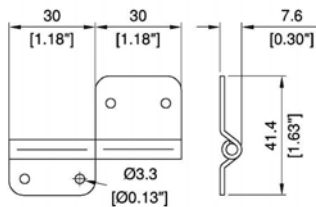

1460-1463

Slip Hinge. Allows for Easy Removal of Doors.
Available with Different Pin Lengths.
Special Order outside USA & China

Material: Steel

Part Number	Finish	Orientation	Pin
1460YZ	Yellow Zinc	Right	54mm/ 2.1"
1461YZ	Yellow Zinc	Left	54mm/ 2.1"
1462	Zinc		60mm/ 2.4"
1462YZ	Yellow Zinc	Right	60.5mm/ 2.4"
1463YZ	Yellow Zinc	Left	60.5mm/ 2.4"

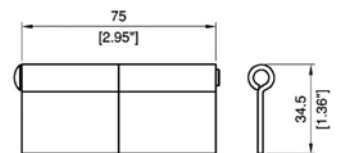

8389

Heavy Duty Stainless Steel Slip Hinge. Allows for Easy Removal of Doors.
Common on Stainless Steel Food Service Equipment.
Special Order outside USA & China

Material: Stainless Steel

Part Number	Finish	Description
8389SS	Stainless Steel	