

# QUICK CONNECT PLUGS



## QUICK CONNECT<sup>®</sup>

### Plug with Cable Sleeve

- Moulded cable sleeve
- 4-point (quarter turn) locking system
- Screwless terminals



### IP44 *Splashproof*

A CURRENT	V VOLTAGE	Hz FREQUENCY		EARTH HR POS.		EARTH HR POS.		EARTH HR POS.
			2P+E		3P+E		3P+N+E	
16 IP44	110	50-60	210100	4				
	240	50-60	210094	6				
	415	50-60			210095	6	212001	6
32 IP44	110	50-60	210330	4				
	240	50-60	210096	6				
	415	50-60			210097	6	212002	6

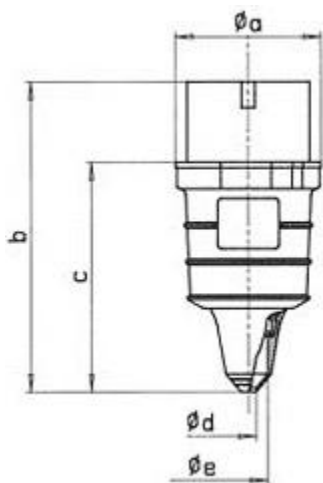

Amperes	16			32		
	3	4	5	3	4	5
Poles						
Ø a	53	59	66	70	70	75
b	125.5	133	141	165	165	165
c	86.5	96.5	104.5	119	119	119
Ø d	5	5	7	8	8	8.5
Ø e	14.5	15.5	17.5	23.5	23.5	26
Conductor mm <sup>2</sup> min	1	1	1	2.5	2.5	2.5
Conductor mm <sup>2</sup> max	2.5	2.5	2.5	6	6	6