

Data Sheet

SP043xxVBNN

Page 1/4

P/N

ASP043xx

xx=number of poles

2013/12/05

Illustration

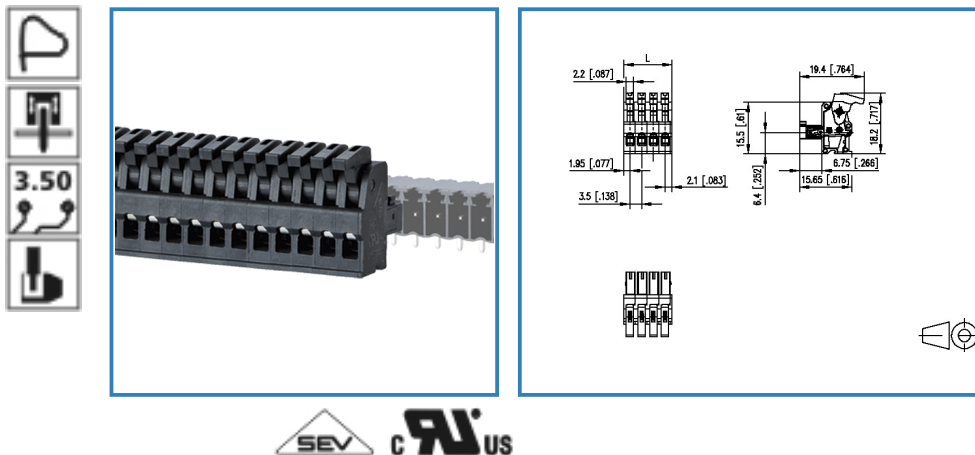

see enlarged drawing at the end of the document

Product specification

- spring clamp terminal block, pluggable
- centerline 3.50 mm, direction of connection vertical 0°
- color black
- eccentric lever, wire entry uncodeable side parallel to plug direction
- Connection data

CRIUS V / A / AWG 150 / 10 / 28 - 16

SEV 10 A / 130 V / 2.5 kV / 3 / IEC 61984 / 0.08 - 1.5 mm²

Data Sheet

SP043xxVBNN

Page 2/4

P/N

ASP043xx

xx=number of poles

2013/12/05

Technical Data

General Data

min. number of poles	2		
max. number of poles	12		
Insulating material class	CTI 400		
clearance/creepage dist.	2.3 mm		
protection category	IP 20		
Overvoltage category	III	III	II
Pollution degree	3	2	2
Rated voltage	160 V	320 V	320 V
Rated test voltage	2.5 kV	2.5 kV	2.5 kV

Connection data

 V / A / AWG	150 / 10 / 28 - 16		
--	--------------------	--	--

	10 A / 130 V / 2.5 kV / 3 / IEC 61984 / 0.08 - 1.5 mm ²		
--	--	--	--

Material

insulating material	PA46		
flammability class	V0		

Climatic properties

upper limit temperature	105 °C		
lower limit temperature	-40 °C		

General

Tolerance	ISO 2768 -mH		
-----------	--------------	--	--

Data Sheet

SP043xxVBNN

Page 3/4

P/N

ASP043xx

xx=number of poles

2013/12/05

Matching Part

P/N	Product name
311881	PR043xxHBBN Typ 188
311891	PR043xxVBBN Typ 189
313421	PT093xxHBBN Typ 342
313431	PT093xxVBBN Typ 343

Accessories

P/N	Product name
700025-01-9	700025



Data Sheet

SP043xxVBNN

Page 4/4

P/N

ASP043xx

xx=number of poles

2013/12/05

Illustration

Drawing

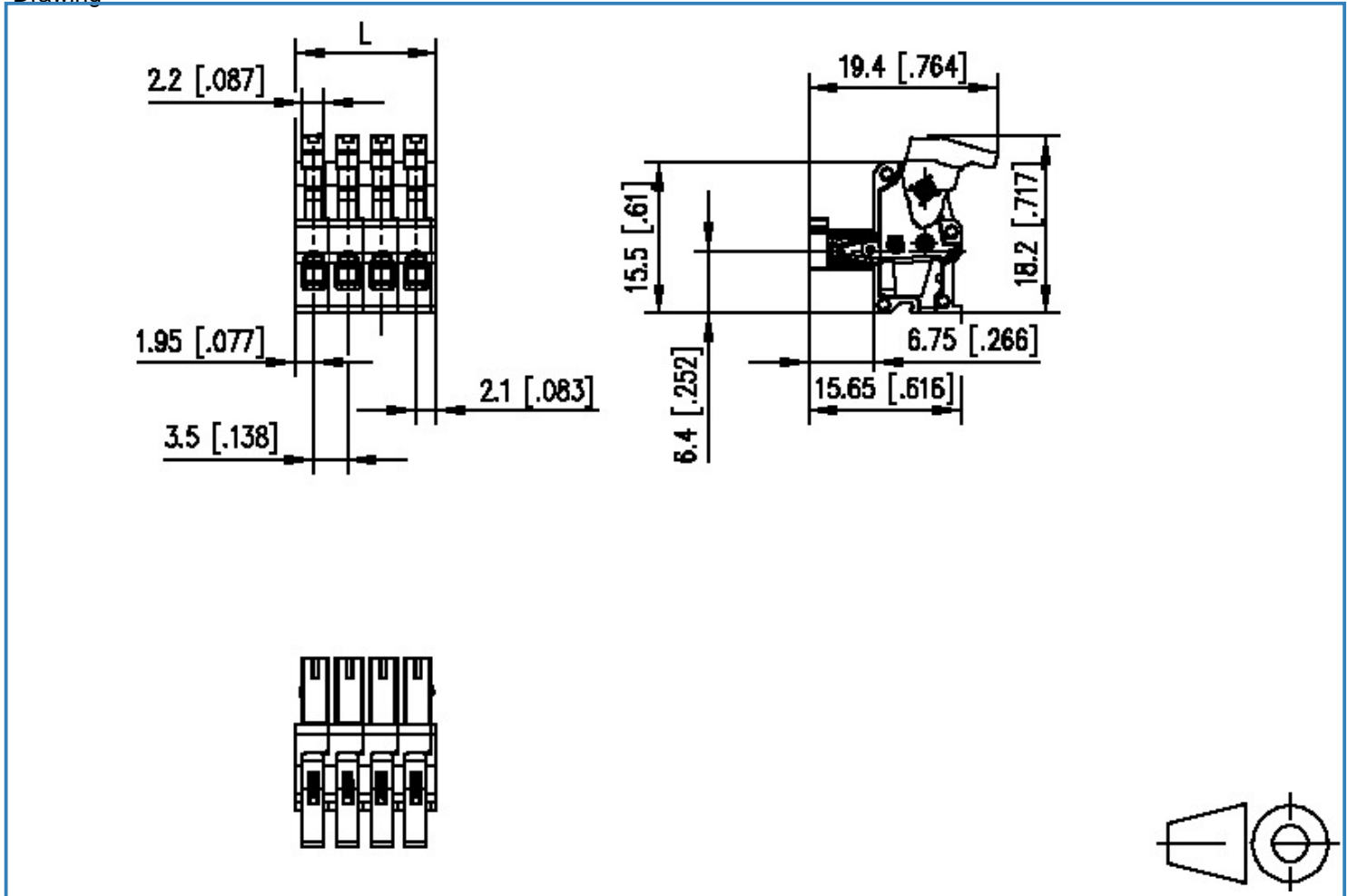

$L = (\text{pole size} - 1) \times \text{centerline} + 4 [0.157]$

