

RASTER

MICRO SWITCH

A DIVISION OF MINNEAPOLIS-HONEYWELL REGULATOR COMPANY
FREEDPORT, ILLINOIS

FED. MFR. CODE 91929

PACKET

CATALOG LISTING
15PA32

15PA32

M

DRAWING NUMBER

X 2

ISSUE

24

REPLACES

RELEASE NO. SR 8859

BLR

CHECK

REVISIONS

A	CO15020
M B F	10 OCT 60
B	CO16050
M B F	10 OCT 61
C	CO16526
OMW	21 DEC 61
D	0041958
SSK	27 JUL 68

BLR

CHECK

7 JUNE 60

CHECK

7 JUNE 60

FO-50378-003

DRAWN

K L B

7 JUNE 60

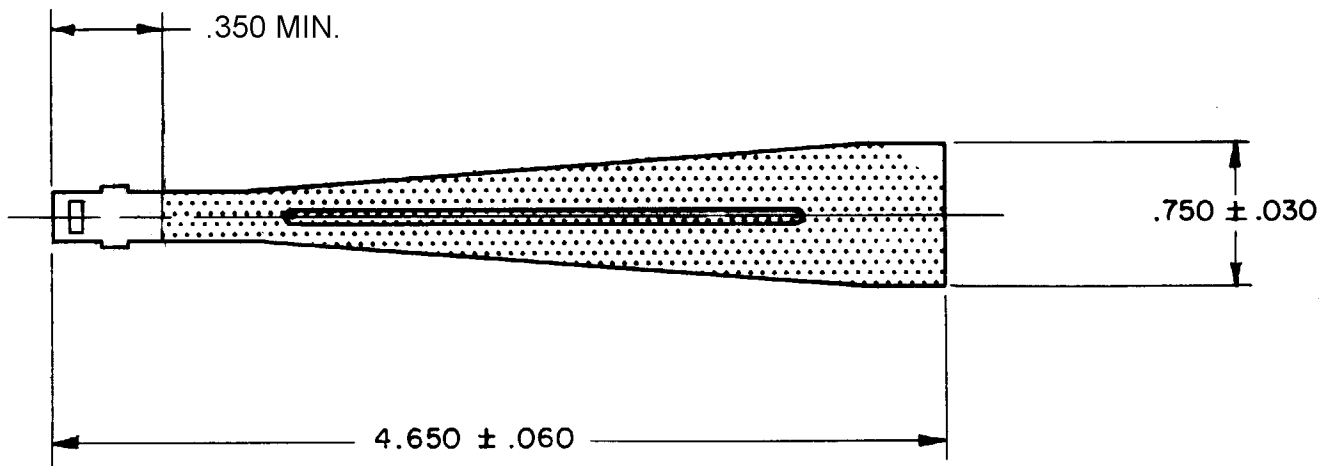
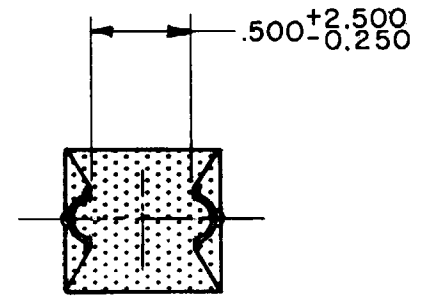
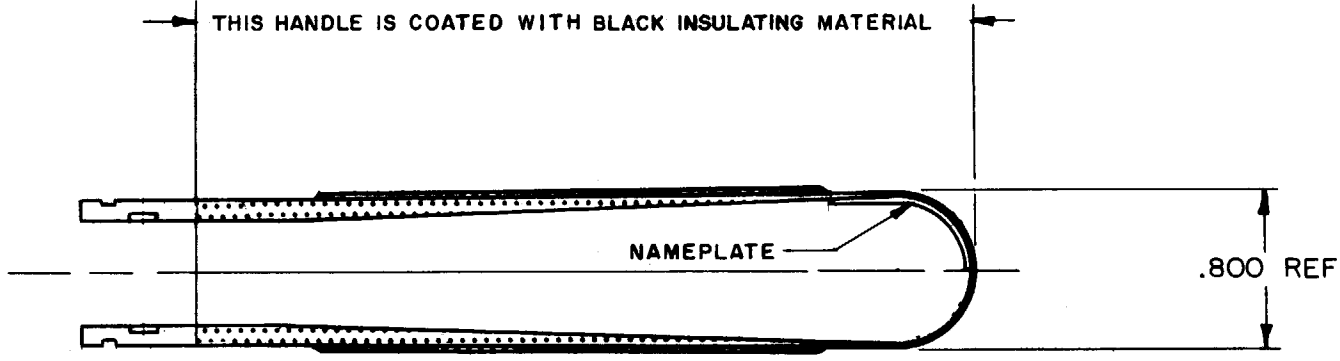

NOTE:--

1. MATERIAL: STAINLESS STEEL

THIS DRAWING COVERS A PROPRIETARY ITEM AND IS THE PROPERTY OF MICRO SWITCH, A DIVISION OF MINNEAPOLIS-HONEYWELL REGULATOR CO. THIS DRAWING IS NOT TO BE COPIED OR USED WITHOUT THE APPROVAL OF MICRO SWITCH.

CHARACTERISTICS	ELECTRICAL DATA		SCALE FULL
	CONTACT ARRANGEMENT	BREAK DISTANCE	DO NOT SCALE PRINT
			UNLESS OTHERWISE SPECIFIED DIMENSIONS ARE IN INCHES TOLERANCES ARE:
			ONE PLACE (.0) $\pm .030$ TWO PLACE (.00) $\pm .015$ THREE PLACE (.000) $\pm .005$ ANGLES \pm
			WEIGHT