

MX-5000

Soldering, Desoldering and Rework System

The new MX-5000 Soldering, Desoldering and Rework System is the next generation of the trusted Metcal Soldering Systems that enable increased productivity and process control for a wide range of applications. The MX-5000 Series increases output power, adds process feedback, and improves application flexibility with new hand-pieces.



SYSTEMS CONFIGURATION



MX-5010 Soldering and Rework System

The MX-5010 is configured with the Metcal Advanced™ Hand-piece. This system is highly effective for soldering applications including: lead-free, high mass components or boards, thermally sensitive components requiring low operating temperature, high volume production soldering and touch-up soldering operations.

Soldering cartridges: [STTC Series](#) and [SMTC Series](#)



MX-5020 UltraFine™ Soldering System

The MX-5020 includes the Metcal UltraFine™ Soldering Hand-piece which is a speciality tool for soldering and touch-up of very small components, restricted access or high density component packaging on a PCB.

Soldering cartridges: [New range of UFTC cartridges](#) featuring small tip geometries and low mass, suited for small part soldering.



MX-5041 Precision Tweezers, Soldering and Rework System

The MX-5041 combines both the Metcal Advanced™ Hand-piece and the Precision Tweezers Hand-piece. Users get maximum application flexibility for soldering and reworking the widest range of surface mount components. When switching hand-pieces, tips reach operating temperature in seconds by simply pressing the Output Selector/Command Button.

Soldering cartridges: [PTTC Series](#), [STTC](#) and [SMTC Series](#)



MX-5050 Plated-Through-Hole Component Desoldering System

The Metcal MX-5050 includes the Metcal MX-DS1 Desoldering hand-piece designed for through-hole desoldering.

Desoldering cartridges: [STDC Series](#) provide assurance for fast, high quality results.



MX-5051 Soldering, Desoldering and Rework System

The MX-5051 addresses through-hole desoldering, general soldering, and SMD rework applications. The system includes two hand-pieces. The Metcal Advanced™ Hand-piece and the Metcal MX-DS1 Desoldering hand-piece. This configuration is ideal for mixed technology boards and provides the greatest versatility for addressing soldering and rework tasks.

Soldering cartridges: [STTC Series](#) and [SMTC Series](#). Desoldering cartridges: [STDC Series](#)

PART NUMBER	MX-PS5000 Power Supply	Hand-pieces				TipSaver™ Workstands		
		MX-H1-AV	MX-H2-UF	MX-PTZ	MX-DS1	MX-W1AV	MX-W4PT	MX-W5DS
MX-5010	✓	✓				✓		
MX-5020	✓		✓			✓		
MX-5041	✓	✓		✓		✓	✓	
MX-5050	✓				✓			✓
MX-5051	✓	✓			✓	✓		✓

HAND-PIECES & CARTRIDGES

The MX-5000 Series offers users a choice of hand-pieces to meet the customer's application needs. Each hand-piece has its own range of cartridges with many choices available for tip geometry and temperature.

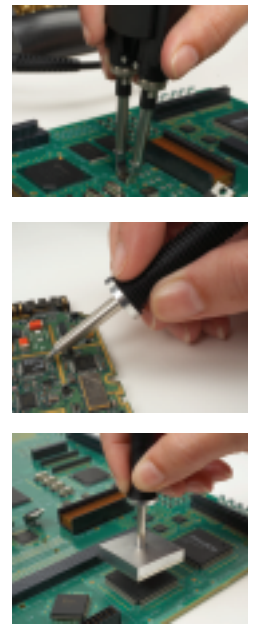
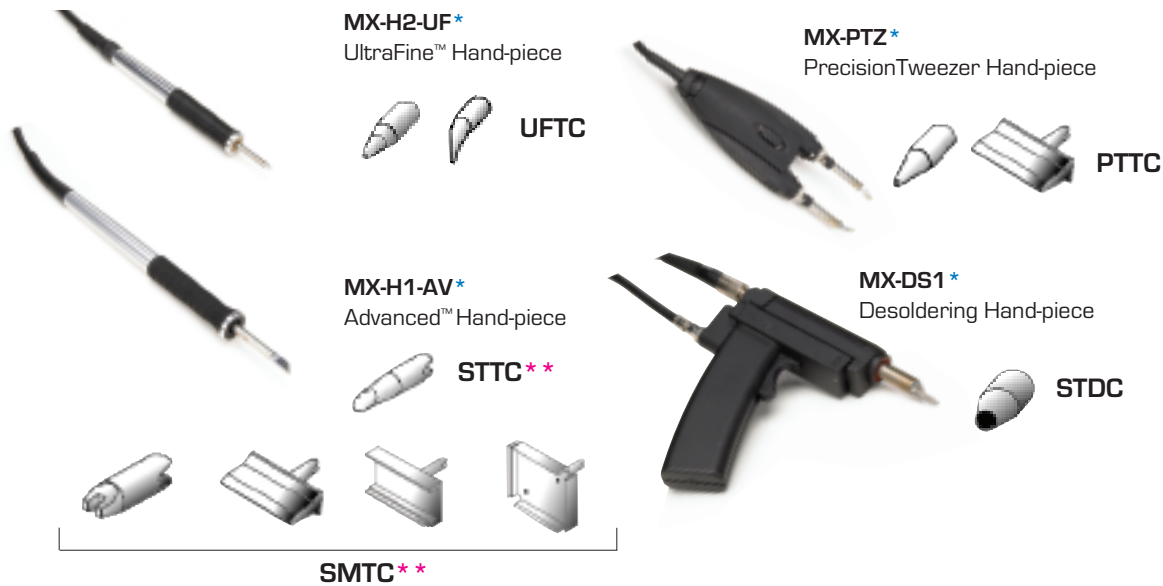

* The MX-H2-UF, MX-H1-AV, MX-PTZ and MX-DS1 hand-pieces are backward compatible with the Metcal MX-500 Soldering and Rework System.
 ** The STTC and SMTC cartridges are also compatible with the Metcal MX-500 Soldering and Rework System and the MX-RM3E

ACCESSORIES

MX-W1AV	Metcal TipSaver™ Workstand, for Advanced™ & UltraFine™ Hand-pieces
MX-W4PT	Metcal TipSaver™ Workstand, for MX-PTZ Hand-piece
MX-W5DS	Metcal TipSaver™ Workstand, for MX-DS1 Hand-piece
MX-H1GR	Grip Metcal Advanced™ Hand-piece with black sleeve in <i>ring</i> pattern
MX-H1GS	Grip Metcal Advanced™ Hand-piece with black <i>scallop</i> pattern
MX-H1GKG	Grip Metcal Advanced™ Hand-piece with green <i>knob</i> pattern
MX-H2GR	Grip Metcal UltraFine™ Hand-piece with black sleeve in <i>ring</i> pattern
MX-H2GS	Grip Metcal UltraFine™ Hand-piece with black sleeve in <i>scallop</i> pattern
MX-H2GKG	Grip Metcal UltraFine™ Hand-piece with green sleeve in <i>knob</i> pattern



TECHNICAL SPECIFICATIONS

Ambient Operating Temperature	10 - 40°C
Maximum Enclosure Temperature	55°C
Input Line Voltage	100 - 240 VAC, grounded circuit
Input Line Frequency	50/60 Hz
Power Consumption	125W
Output Power (Max.)	80 Watts max. Per channel at 22°C ambient temperature
Output Frequency	13.56 MHz
Power Cord 3-Wire	183 cm (72") SJT
Power Supply Dimensions w x d x h	12.1 cm (4.8") x 13.0 cm (5.1") x 23.5 cm (9.3")
Certification / Marking	cTUVus, CE
Tip-to-Ground Potential	<2mV
Tip-to-Ground Resistance	<2 ohms
Idle Temperature Stability	± 1.1°C in still air
Hand-piece Cable Length	L=122 cm (48"), burn proof, ESD safe
Hand-piece Connector	F connector
Workstand Dimensions w x d x h	8.6 cm (3.4") x 19.1 cm (7.5") x 8.3 cm (3.3")
Weight of the power supply	7.4 lbs (3.35 kg)
Weight of the workstand	1.05 lbs (.476 kg)

