

# EAO – Your Expert Partner for Human Machine Interfaces

82-6151.1234 - Illuminated pushbutton 16 mm stainless-steel, momentary

## 82-6151.1234 - Illuminated pushbutton 16 mm stainless-steel, momentary



*Attention: The preview is based on a sample product. This can differ from your current configuration.*

### Mounting

Mounting cut-out Ø 19 mm  
Design flush

### Front

Front dimension Ø 22 mm  
Front shape round  
Front ring shape flush

### Other Attributes

Operating voltage 24 V AC/DC  
Weight 0.021 kg  
Operation current 10 mA

### Operating-/Indication part

Lens optics opaque  
Lens material Stainless steel  
Lens profile flat  
Lens illumination illuminative  
Lens colour Stainless steel

### IP-Rating

Front protection IP 67

### Connection Method

Terminal Solder 2.8 x 0.5 mm

### Actuator

Switching action Momentary

### Switching element

Switching current 5 A  
Contact material Silver  
Contacts 1 C  
Switching system Snap-action switching element  
Switching voltage 250 V AC

### Illumination

Illumination Dot with green LED

### Function

Illuminated pushbutton

# EAO – Your Expert Partner for Human Machine Interfaces

82-6151.1234 - Illuminated pushbutton 16 mm stainless-steel, momentary

## Dimensions

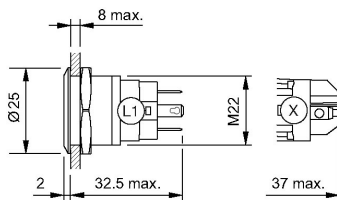

## Mounting cut-outs

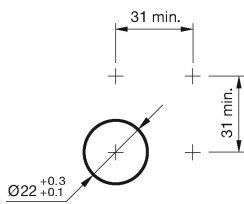

## Wiring diagram

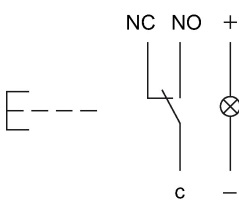

## Component layout



## Legend

Switching action: B = Momentary

Contacts: C = Changeover