

DO NOT SCALE DRAWING

REVISION

A Initial Drawing DW 22.01.16

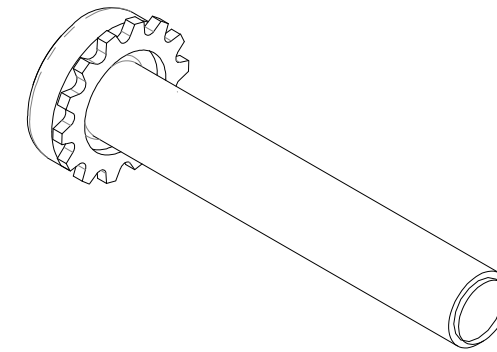
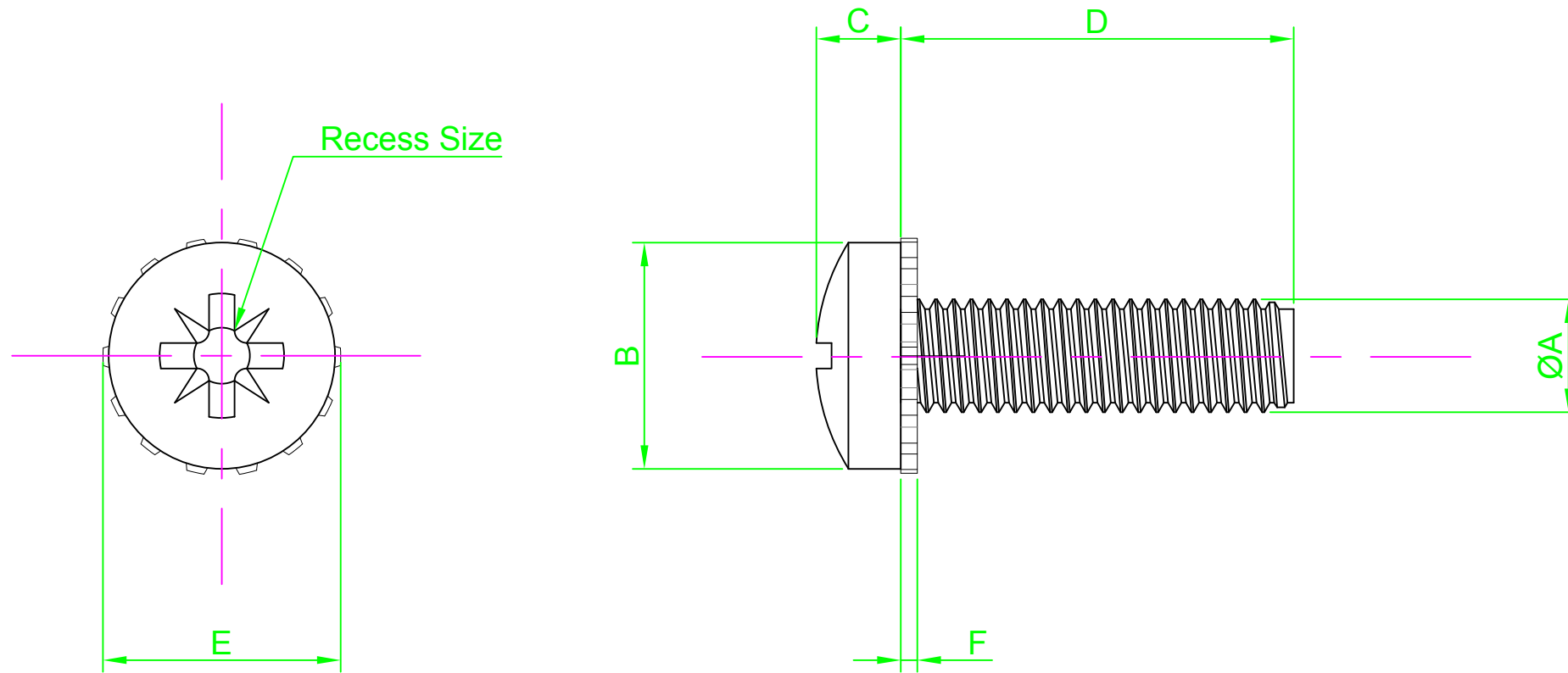

| Part Number | ØA | B Nom | C Nom | Recess Size | D Length | E Nom | F |
|-------------------|--------|-------|-------|-------------|----------|-------|-----|
| M3 6 PRSTEX Z100 | M3-0.5 | 6.0 | 2.4 | Pozi #1 | 6.0 | 6.0 | 0.8 |
| M3 12 PRSTEX Z100 | | | | | 12.0 | | |
| M4 6 PRSTEX Z100 | M4-0.7 | 8.0 | 3.1 | Pozi #2 | 6.0 | 8.0 | 1.0 |
| M4 12 PRSTEX Z100 | | | | | 12.0 | | |
| M4 16 PRSTEX Z100 | | | | | 16.0 | | |

NOTES:



UNLESS OTHERWISE SPECIFIED:
DIMENSIONS ARE IN MM (MILLIMETERS).
SURFACE FINISH:
TOLERANCES:

MATERIAL:
Steel

TITLE:
Pozi Pan Head Machine Screw c/w External
Toothed SEMS Lock Washer

| | NAME | DATE |
|-------|---------------|------------|
| DRAWN | Darryl Wilson | 22/01/2016 |
| CHK'D | | |
| APPVD | | |

HEAT TREATMENT:

DESIGN RIGHT. TR FASTENINGS LTD, 2003
UNDER NO CIRCUMSTANCES MUST THIS
DRAWING BE COPIED OR DISCLOSED
WITHOUT FIRST OBTAINING WRITTEN
AUTHORITY.

CUSTOMER PART NUMBER:
N/A

FINISH:
TC1 - Commercial Zinc/Clear Trivalent

DRAWING NUMBER:
TR32PRSTEX

A4

PROJECTION

