

# Printed-circuit board connector - MC 0,5/ 3-G-2,54 SMD R24 - 1821708

Please be informed that the data shown in this PDF Document is generated from our Online Catalog. Please find the complete data in the user's documentation. Our General Terms of Use for Downloads are valid (<http://phoenixcontact.com/download>)

Header, Nominal current: 6 A, Rated voltage (III/2): 160 V, Number of positions: 3, Pitch: 2.54 mm, Color: black, Contact surface: Gold, Mounting: SMD soldering, Sample values available under SAMPLE MC...



The illustration shows the 10-position version

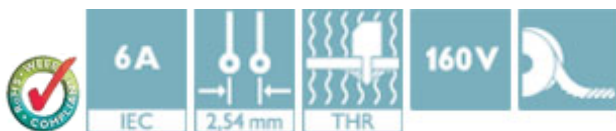

## Key Commercial Data

|                                      |                                                                                                         |
|--------------------------------------|---------------------------------------------------------------------------------------------------------|
| Packing unit                         | 465 pc                                                                                                  |
| Minimum order quantity               | 465 pc                                                                                                  |
| GTIN                                 | <br>4 046356 789868 |
| Weight per Piece (excluding packing) | 1.44 g                                                                                                  |
| Custom tariff number                 | 85366990                                                                                                |
| Country of origin                    | Germany                                                                                                 |
| Note                                 | Made to Order (non-returnable)                                                                          |

## Technical data

### Dimensions

|                |                |
|----------------|----------------|
| Length         | 7.1 mm         |
| Pitch          | 2.54 mm        |
| Dimension a    | 5.08 mm        |
| Width          | 12.16 mm       |
| Height         | 4.8 mm         |
| Pin dimensions | 0,64 x 0,64 mm |

### General

|                             |                  |
|-----------------------------|------------------|
| Range of articles           | MC 0,5/...-G-SMD |
| Insulating material group   | IIIa             |
| Rated surge voltage (III/3) | 2.5 kV           |
| Rated surge voltage (III/2) | 2.5 kV           |
| Rated surge voltage (II/2)  | 2.5 kV           |

# Printed-circuit board connector - MC 0,5/ 3-G-2,54 SMD R24 - 1821708

## Technical data

### General

|                                        |        |
|----------------------------------------|--------|
| Rated voltage (III/3)                  | 32 V   |
| Rated voltage (III/2)                  | 160 V  |
| Rated voltage (II/2)                   | 160 V  |
| Connection in acc. with standard       | EN-VDE |
| Nominal current I <sub>N</sub>         | 6 A    |
| Insulating material                    | LCP    |
| Flammability rating according to UL 94 | V0     |
| Color                                  | black  |
| Number of positions                    | 3      |

### Standards and Regulations

|                                        |        |
|----------------------------------------|--------|
| Connection in acc. with standard       | EN-VDE |
| Flammability rating according to UL 94 | V0     |

## Classifications

### eCl@ss

|            |          |
|------------|----------|
| eCl@ss 4.0 | 272607xx |
| eCl@ss 4.1 | 27260701 |
| eCl@ss 5.0 | 27260701 |
| eCl@ss 5.1 | 27260701 |
| eCl@ss 6.0 | 27260704 |
| eCl@ss 7.0 | 27440402 |
| eCl@ss 8.0 | 27440402 |
| eCl@ss 9.0 | 27440402 |

### ETIM

|          |          |
|----------|----------|
| ETIM 3.0 | EC001121 |
| ETIM 4.0 | EC002637 |
| ETIM 5.0 | EC002637 |

### UNSPSC

|               |          |
|---------------|----------|
| UNSPSC 6.01   | 30211810 |
| UNSPSC 7.0901 | 39121409 |
| UNSPSC 11     | 39121409 |
| UNSPSC 12.01  | 39121409 |
| UNSPSC 13.2   | 39121409 |

## Approvals

### Approvals

# Printed-circuit board connector - MC 0,5/ 3-G-2,54 SMD R24 - 1821708

## Approvals

### Approvals

cULus Recognized / VDE Gutachten mit Fertigungsüberwachung / IEC60320 CB Scheme

### Ex Approvals

### Approvals submitted

## Approval details

|                       |       |      |
|-----------------------|-------|------|
| cULus Recognized      |       |      |
|                       | B     | C    |
| Nominal current $I_N$ | 6 A   | 6 A  |
| Nominal voltage $U_N$ | 150 V | 50 V |

|                                         |       |
|-----------------------------------------|-------|
| VDE Gutachten mit Fertigungsüberwachung |       |
| Nominal current $I_N$                   | 6 A   |
| Nominal voltage $U_N$                   | 160 V |

|                       |       |
|-----------------------|-------|
| IECEE CB Scheme       |       |
| Nominal current $I_N$ | 6 A   |
| Nominal voltage $U_N$ | 160 V |

## Drawings

Drilling diagram

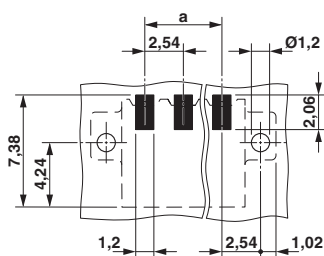

Dimensional drawing

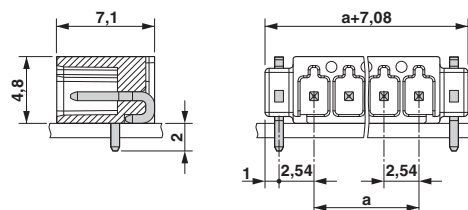

# Printed-circuit board connector - MC 0,5/ 3-G-2,54 SMD R24 - 1821708

Diagram

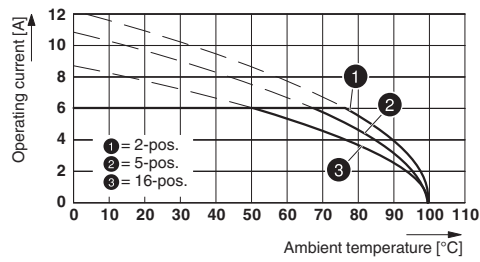

Type: FMC 0,5/...-ST-2,54 with MC 0,5/...-G-2,54 SMD R..