

Datamate Connectors

Datamate **S-Tek**

Male Vertical PC Tail with Metal Backshell

- ❖ Board Mount version, with Jackscrew fixings for attachment to PCB for added strain relief.
- ❖ Supplied as a complete kit, including backshell, jackscrew nuts, and connector with Jackscrew studs assembled.
- ❖ Mates with female connectors shown on page 72.

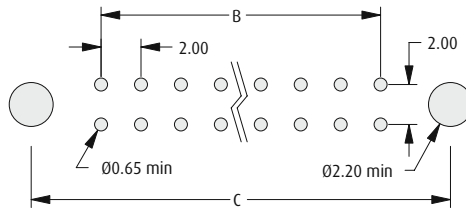

Recommended PC Board Pattern

CALCULATION

A	$B + 13.40$
B	Total no. of contacts - 2
C	$B + 7$

2.7mm TAIL

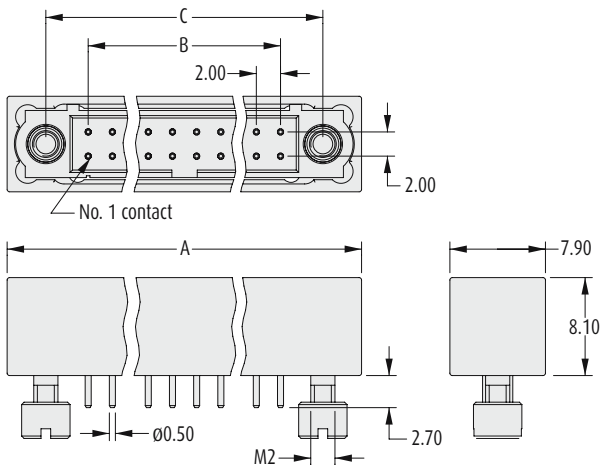

3.8mm TAIL

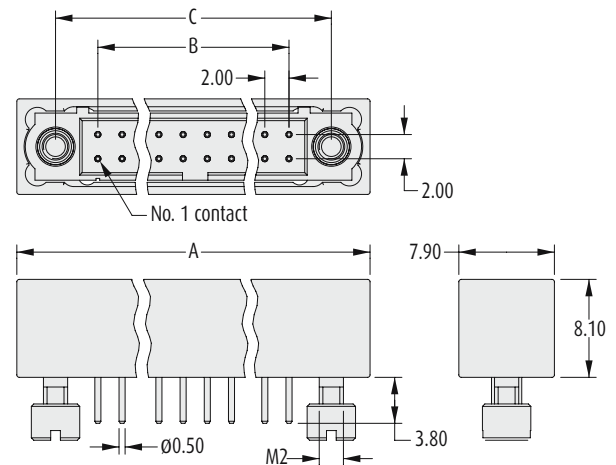

HOW TO ORDER

M80 - 5 TX XX XX B1

SERIES CODE

TYPE

T1	2.7mm Tails
T2	3.8mm Tails

FINISH

05	Gold	
22	Gold + Tin/Lead	
42	Gold + Tin	

TOTAL NO. OF CONTACTS

06, 10, 14, 20, 26

All dimensions in mm.