

EAO – Your Expert Partner for Human Machine Interfaces

41-040.005 - Indicator

41-040.005 - Indicator



Attention: The preview is based on a sample product. This can differ from your current configuration.

Mounting

Mounting cut-out
Design

15 x 21 mm
raised

Front

Front dimension
Front shape

18 x 24 mm
rectangular

Other Attributes

Weight

0.009 kg

IP-Rating

Front protection

IP40

Connection Method

Terminal

Solder

Function

Indicator

Dimensions

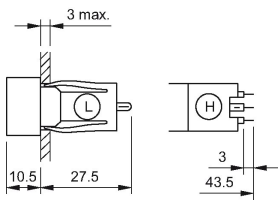

L = Solder terminal

Mounting cut-outs

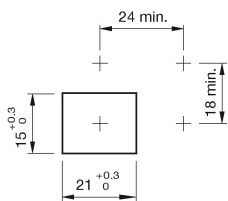

Wiring diagram

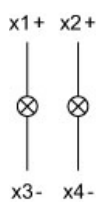

Additional information

Has two independent lamp bases