

# DCmind: DC DIRECT-DRIVE BRUSH MOTORS

Ø 42 mm - 36 W

- › Silent motor
- › 12 V and 24 V built in EMC filter class B
- › Excellent efficiency
- › Long life
- › IP65
- › In accordance with UL - CE - ROHS regulations



## Part numbers

	12 V	24 V	48 V
Type	89800	89800	89800
Voltage	12 V <sup>DC</sup>	24 V <sup>DC</sup>	48 V <sup>DC</sup>
<b>References</b>			
Option: IP65 level	<b>89800007</b>	<b>89800008</b>	<b>89800003</b>
Option: holding brake 0.25 Nm, 24 V <sup>DC</sup>	<b>89800507</b>	<b>89800508</b>	<b>89800503</b>
Option: 2 channels encoder 1000 pulses/revolution, 5 V <sup>DC</sup>	<b>89800907</b>	<b>89800908</b>	<b>89800903</b>
<b>No-load characteristics</b>			
Speed (rpm)	4200	4000	3930
Absorbed current (A)	0.26	0.115	0.07
<b>Nominal characteristics</b>			
Speed (rpm)	3050	3100	3150
Torque (mNm)	75	75	75
Output power (W)	24	24	25
Absorbed current (A)	3	1.43	0.72
Efficiency (%)	67	71	72
<b>Maximum efficiency characteristics</b>			
Speed (rpm)	3620	3500	3450
Torque (mNm)	38	41	48
Output power (W)	14	15	17
Absorbed current (A)	1.6	0.84	0.49
Efficiency (%)	73	75	74
<b>General characteristics</b>			
Insulation conforming to IEC60085	Class E	Class E	Class E
Noise level (dBA)	35	35	35
Max. output power (W)	30	36	39
Starting torque (mNm)	276	344	377
Starting current (A)	10.3	6.1	3.3
Resistance (Ω)	1.2	3.9	14.5
Inductance (mH)	0.8	3	13
Torque constant (mNm/A)	27	57	115
Electrical time constant (ms)	0.7	0.8	0.9
Mechanical time constant (ms)	17	13	12
Inertia (g.cm <sup>2</sup> )	110	110	110
Weight (g)	450	450	450
Commutator segments	8	8	8
Service life (h)	4000	4000	4000
Wires length (mm)	200	200	200
Ball bearing	✓	✓	✓
<b>Comments</b>			
IP65 level except for the output shaft. Encoder and brake options are IP20.			

## Product adaptations, contact us



- › Special output shaft
- › Shaft with pinion, pulley, worm gear
- › Special supply voltage
- › Other wire length
- › Optical or Hall effect encoder - 1 or 2 channels
- › Specific motor mounting flange
- › Special motor connectors
- › IP67, IP69K

Product made to order

Curves

89800007 - 89800507 - 89800907

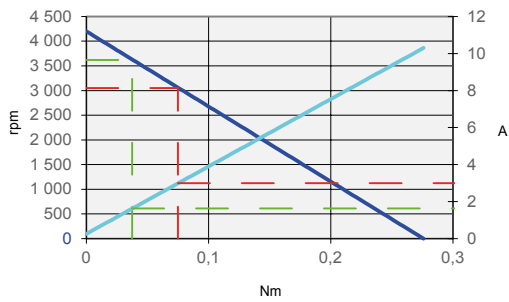

89800008 - 89800508 - 89800908

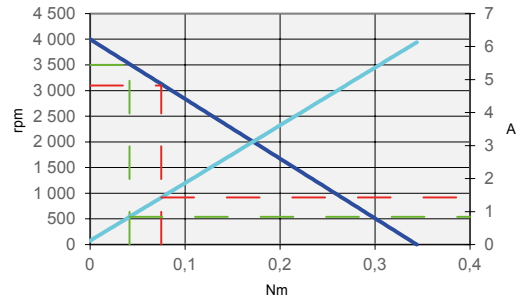

89800003 - 89800503 - 89800903

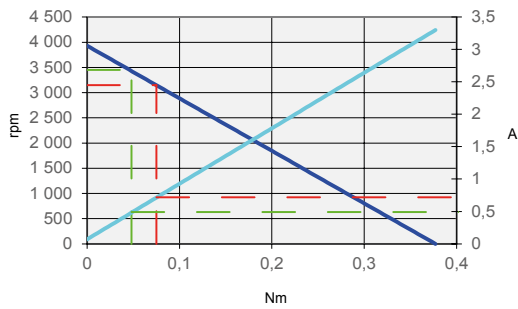

- Speed (rpm)
- Current (A)
- Torque at nominal
- Torque at maximum efficiency

Dimensions (mm)

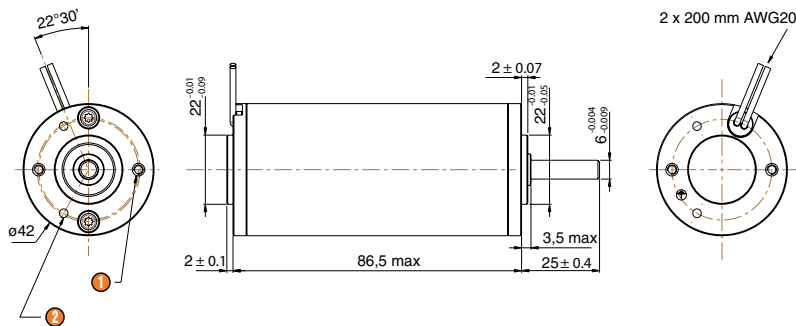

- ① 2 x M3 at 180° depth 5 over Ø 32
- ② 2 x Ø 2.75 at 120° depth 5 over Ø 32

Options

Holding brake 0.25 Nm

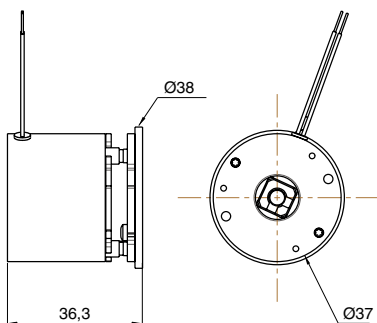

Encoder

