

Main

Range of product	Harmony XVU
Product or component type	Modular tower light
Accessory / separate part type	Fixing plate
Accessory / separate part category	Mounting and fixing accessory
Component name	XVU
Mounting diameter	60 mm

Complementary

Mounting support	Wall mounted
Product compatibility	AC/DC mounting plate
Material	Aluminium V-0 flame retardant conforming to UL 94
Housing colour	Black
[Us] rated supply voltage	110...240 V AC 24 V AC/DC
Length	8 mm
Product weight	0.36 kg

Environment

Ambient air temperature for storage	-40...70 °C
Ambient air temperature for operation	-25...50 °C
IP degree of protection	IP65
Product certifications	CE CSA UL

Offer Sustainability

Sustainable offer status	Green Premium product
RoHS (date code: YYWW)	Compliant - since 1551 - Schneider Electric declaration of conformity Schneider Electric declaration of conformity

REACH	Reference not containing SVHC above the threshold Reference not containing SVHC above the threshold
Product environmental profile	Available
Product end of life instructions	Available

Dimensions

Rear View

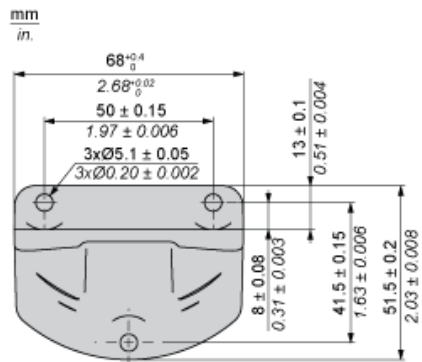

Side View

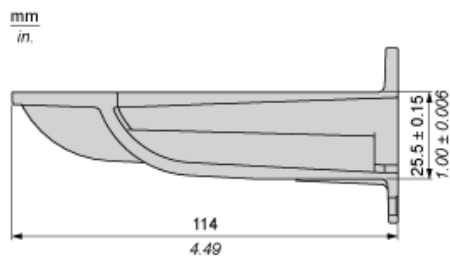

Vertical Support Panel Drillings

