

## Flush-type connector - SACC-E-M12MST-4P-M16XL/0,5 - 1411608

Please be informed that the data shown in this PDF Document is generated from our Online Catalog. Please find the complete data in the user's documentation. Our General Terms of Use for Downloads are valid (<http://phoenixcontact.com/download>)



Flush-type connector, Power, 4-position, PlugLink:M12, T power, Front mounting, M16 x 1.5, Individual wires, Cable length: 0.5 m

### Why buy this product

- ✓ For compact devices: transmit high power in a confined space
- ✓ Easy-to-install, optimized XL housing contour with wrench size 19
- ✓ Tightening limitation for the O-ring gasket
- ✓ Pre-assembled with litz wires for immediate use
- ✓ Customer-specific assemblies and litz wire lengths available
- ✓ Sealed on the litz wire side for optimum leak-tightness
- ✓ For high transmission safety: shield connection to the housing with optional EMC nut



### Key Commercial Data

Packing unit	1 STK
GTIN	 4 046356 936224
GTIN	4046356936224
Weight per Piece (excluding packing)	48.000 g
Custom tariff number	85366990
Country of origin	Germany
Note	Made to Order (non-returnable)

### Technical data

#### Dimensions

Length of cable	0.5 m
-----------------	-------

#### Ambient conditions

Ambient temperature (operation)	-25 °C ... 85 °C (Plug / socket)
Degree of protection	IP67

#### General

# Flush-type connector - SACC-E-M12MST-4P-M16XL/0,5 - 1411608

## Technical data

### General

Note	The electrical and mechanical data specified assume that the connector pair is correctly locked and mounted. If the connector is unlocked and if there is a danger of contamination, the connector must be sealed using a protective cap > IP54. Influences arising from litz wires, cables or PCB assembly must also be taken into consideration.
Rated current at 40°C	12 A
Rated voltage	63 V
Rated surge voltage	1.5 kV
Number of positions	4
Insulation resistance	≥ 100 MΩ
Coding	T power
Standards/regulations	M12 connector
Signal type/category	Power
Status display	No
Overvoltage category	III
Degree of pollution	3
Test voltage	1.5 kV
Connection method	Individual wires
Insertion/withdrawal cycles	> 100
Torque	0.8 Nm ... 1.3 Nm (Installation-side)
Mounting type	Front mounting M16 x 1.5 Tightening limitation

### Material

Flammability rating according to UL 94	V0
Contact material	CuZn
Contact surface material	Au
Contact carrier material	PA
Material, knurls	Zinc die-cast, nickel-plated
Sealing material	FKM

### Cable

Cable type	PP litz wire
Conductor cross section	1.5 mm <sup>2</sup>
AWG signal line	16
Wire colors	Black, brown, blue, white
Material conductor insulation	PP
Conductor material	Bare Cu litz wires
Standards/specifications	M12 connector
Flame resistance	in acc. with UL FT-2
Halogen-free	According to VDE 0282-13 Appendix C
Ambient temperature (operation)	-40 °C ... 85 °C (without mechanical actuation)
	-40 °C ... 90 °C (cable, fixed installation)
	-30 °C ... 90 °C (cable, flexible installation)

# Flush-type connector - SACC-E-M12MST-4P-M16XL/0,5 - 1411608

## Technical data

### Standards and Regulations

Standard designation	M12 connector
Halogen-free	According to VDE 0282-13 Appendix C
Flame resistance	in acc. with UL FT-2
Flammability rating according to UL 94	V0

### Environmental Product Compliance

China RoHS	Environmentally Friendly Use Period = 50
	For details about hazardous substances go to tab "Downloads", Category "Manufacturer's declaration"

## Drawings

Schematic diagram

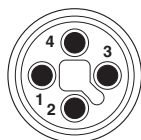

Connector pin assignment of M12 plug, 4-pos., T-coded, view of pin side

Dimensional drawing

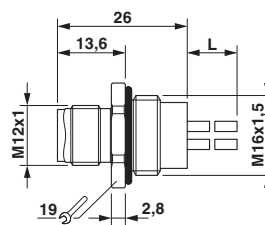

M12 flush-type plug

Circuit diagram

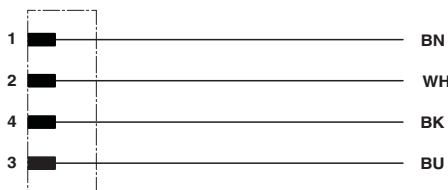

Contact assignment of the M12 plug

## Classifications

### eCl@ss

eCl@ss 5.1	27143423
eCl@ss 6.0	27143423
eCl@ss 8.0	27440103
eCl@ss 9.0	27440102

# Flush-type connector - SACC-E-M12MST-4P-M16XL/0,5 - 1411608

## Classifications

### ETIM

ETIM 4.0	EC002061
ETIM 5.0	EC002061
ETIM 6.0	EC002061

### UNSPSC

UNSPSC 13.2	39121413
-------------	----------

## Approvals

### Approvals

#### Approvals

UL Listed / cUL Listed / EAC / cULus Listed

#### Ex Approvals

### Approval details

UL Listed		<a href="http://database.ul.com/cgi-bin/XYV/template/LISEXT/1FRAME/index.htm">http://database.ul.com/cgi-bin/XYV/template/LISEXT/1FRAME/index.htm</a>	FILE E 468743
mm <sup>2</sup> /AWG/kcmil	16		
Nominal current I <sub>N</sub>	12 A		
Nominal voltage U <sub>N</sub>	63 V		

cUL Listed		<a href="http://database.ul.com/cgi-bin/XYV/template/LISEXT/1FRAME/index.htm">http://database.ul.com/cgi-bin/XYV/template/LISEXT/1FRAME/index.htm</a>	FILE E 468743
mm <sup>2</sup> /AWG/kcmil	16		
Nominal current I <sub>N</sub>	12 A		
Nominal voltage U <sub>N</sub>	63 V		

EAC		B.01742
-----	---	---------

## Flush-type connector - SACC-E-M12MST-4P-M16XL/0,5 - 1411608

### Approvals

cULus Listed



### Accessories

#### Accessories

##### Flat nut

Flat nut - SACC-E-MU-M16 - 1504097



Flat nut with M16 thread