

Electric Paint® 10ml / SKU-0018

Draw, paint and create with electronics

Bare Conductive's **Electric Paint** is just like any other water-based paint, except that it conducts electricity! This means that you can paint wires or sensors directly onto almost any material around you, including paper, wood, plastic and glass.

The **Electric Paint** 10ml Tube is perfect for small scale projects where detail is important, or for painting, soldering or repairing small breaks.

Get the most out of the Electric Paint Tube

Sits well next to: Tools, conductive materials, innovation, solder paste.

E-shop keywords/category: Conductive paint, electric paint, sensor, conductive material, solder paste, soldering tool, toolbox must-have.

Audience: Engineer, designer, tinkerer, anyone curious, tech-interested, student, innovations lover, musicians, architect, artist, traveller, DIYer, technologist and teacher.

Expertise's level: Novice to professional

You may also want to stock: Electric Paint 50ml, Touch Board, Pi Cap, Touch Board Starter Kit

Product Features

- Works on multiple surfaces
- Conducts electricity when dry
- Paint, stencil or screen print
- Cold solder and repair devices
- Nontoxic and solvent free
- Water soluble
- Seal with water-based paints
- Air-drying
- Works on multiple surfaces
- Dispenses up to 5m

Product information

Height / 2.5cm / 0.9in
Width / 13.5cm / 5.3in
Depth / 5.6cm / 2.2in
Weight / 0.04kg / 1.41oz
UPC / 5060322450018
HS Tariff Code / 3209900000
Customs Description / Non-Toxic Water Based Paint
Country of origin / United Kingdom
Minimum casepack / 10 units
Shelf life / 1 year
Age Range / 14+

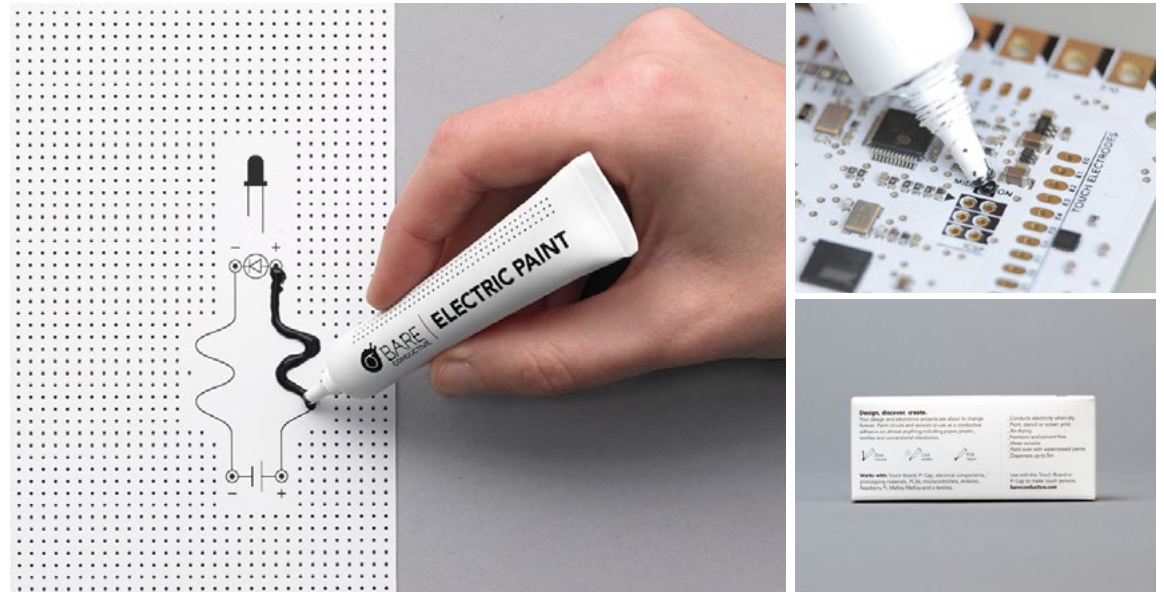

laura@bareconductive.com

© 2017 / Bare Conductive Ltd.