



Main

Accessory / separate part category	Cabling accessories
Accessory / separate part type	Connector
Electrical connection	Elbowed female connector DIN 43650 A, 4 pins
Status LED	Without
Cable connection	Screw terminal / wire size $\leq 1.5 \text{ mm}^2$ / clamping capacity 7...10 mm

Complementary

Cable gland type	Pg 11
Cable connector fixing	Locking screw
[Ue] rated operational voltage	250 V AC
[In] rated current	16 A
Enclosure material	Plastic
Insulating resistance	$> 0.1 \text{ G}\Omega$
Contact resistance	$\leq 4000 \mu\text{Ohm}$
Product weight	0.035 kg

Environment

IP degree of protection	IP65
Ambient air temperature for operation	-40...125 °C

Offer Sustainability

Sustainable offer status	Not Green Premium product
RoHS (date code: YYWW)	Compliant - since 0726 - Schneider Electric declaration of conformity Schneider Electric declaration of conformity

Contractual warranty

Warranty period	18 months
-----------------	-----------

Dimensions

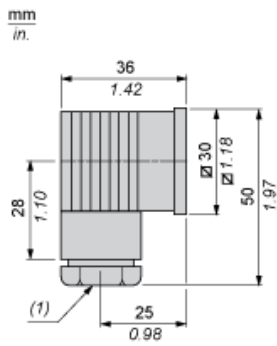

(1) Pg 11 cable gland

Connections and Schemes

