

# CR1025

# LITHIUM MANGANESE DIOXIDE



### Features & Benefits

- Good pulse capability
- High discharge characteristics
- Stable voltage level during discharge
- Long-term reliability

### Specifications

Nominal Capacity:	30 mAh
Nominal Voltage:	3V
Weight:	0.7g
Operating Temperature:	-30°C - +60°C

### Dimensions

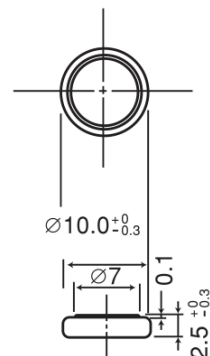

### Temperature Characteristics

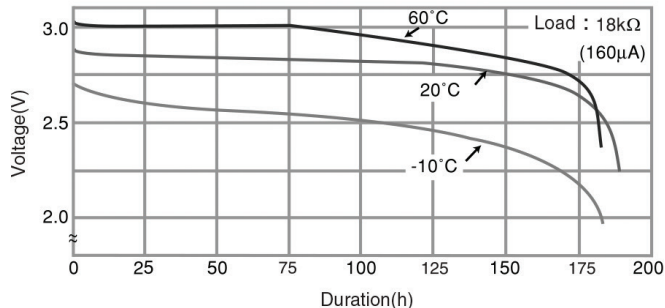

### Operating Voltage vs. Load Resistance (voltage at 50% discharge depth)

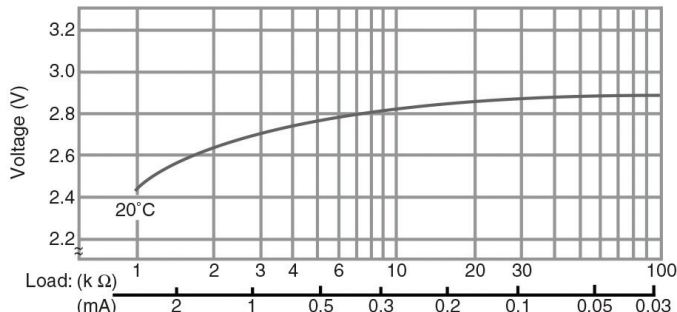

### Capacity vs. Load Resistance

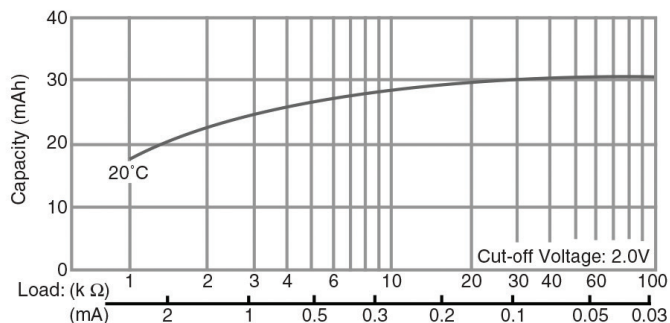

### WARNING

Serious harm in as little as 2-hours if swallowed. **KEEP AWAY FROM CHILDREN.** Seek immediate medical help if swallowed. Have the doctor call the poison center at 1-(800) 222 1222.

Product manufacturers should design their products to meet the safety requirements of Annex I of UL60065 or equivalent standards.