

OS50F product information sheet



The OS50F is a low-profile, easy-to-use small fixed mount.

Product Benefits*

- Low 1.1" (28mm) mounting profile
- Lift n' Lock™ allows you to easily attach your TV to the mount
- Adequate spacing between TV and wall allows for cooling
- Provides ample room for cables and wires between TV and wall
- Durable powder coat finish
- Simple to install and use
- Ships fully assembled
- Includes adapters for greater VESA compatibility
- Includes complete hardware kit

Product Specifications*

Fits most: 13–37" TVs
Supports up to: 50 lbs (22.7 kg)
Mounting profile: 1.1" (28mm)
VESA compliance: 75x75 to 200x200
Mounting: Single-stud or solid wall
UL listed: Yes
Warranty: 5 years
Color: Black

Series



OS35FM



OS50T



OS50F

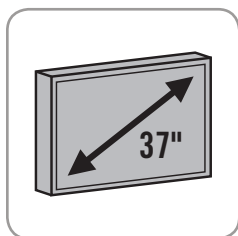

Take the guess work out of choosing your perfect mount! The OS50F is compatible with most TVs up to 37" on the market today.

*Subject to change

800.MOUNT.IT (800.668.6848)



01022013

OS50F technical data sheet

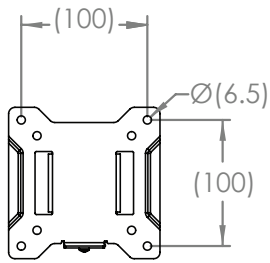

FRONT VIEW

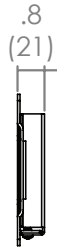

MOUNTING PROFILE

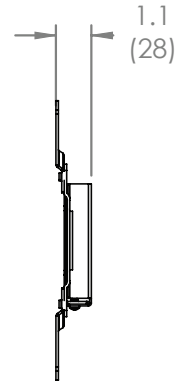

MOUNTING PROFILE WITH ADAPTERS

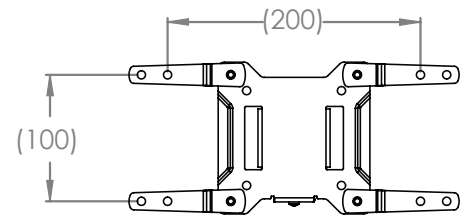
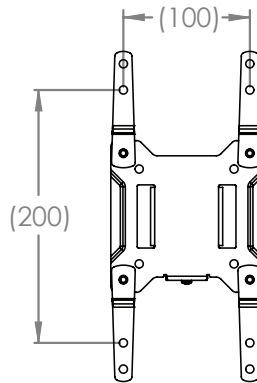
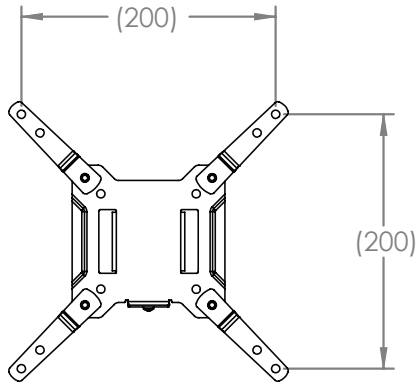

PANEL ATTACHMENT -
VESA COMPATIBILITY (mm)
WITH ADAPTERS



inches (mm)

	Packaging UPC	MC UPC
Americas	698833021936	10698833021933
International	698833021936	10698833021933

	Dimensions WxDxH Inches (mm)	Wt lbs (kg)	Qty
Box	7.8 x 7 x 2.2 (197x177x57)	1.3 (0.6)	NA
MC	9.2 x 7.7 x 8.9 (234x195x225)	6.2 (2.8)	4

Box Contents	Qty
Wall plate	1
Monitor plate	1
Monitor plate screw	1
V200A adapter	4

Box Contents	Qty
Complete TV hardware kit	1
Complete wall hardware kit	1
Complete hardware kit	1
Instruction Manual	1

