



INTRODUCTION

Thank you for purchasing this Stellar Labs product. For optimum performance and safety, please read these instructions carefully before connecting, operating or adjusting this product. Please keep this manual for future reference.

Our selection of HDMI Converter, switches, extenders, matrices and splitters are designed to make your AV device use more convenient, comfortable, productive and cost-efficient.

This unit is a 3x1 Toslink switch is most commonly used for sending multiple audio sources to a single soundbar.

Our devices offer solutions for home, space, security concerns, data center control, information distribution, conference room presentations, schools, and corporate training environments.

FEATURES

- Audio format support : LPCM2.0/DTS 5.1/Dolby-AC3
- Support signal relaying
- Utilizing optical fiber cable loss less the 0.2Db/m. Output distance is up to 40m.
- The input control can through RM and also can directly press the button
- Supports source unit memory, where the last source used when turned off will still be selected when turned back on
- Over-voltage protection
- LED status indicator
- No loss of quality
- Installs in minutes

Contents:

- | | | |
|----|------------------|---------|
| 1. | Toslink Switch | 1 piece |
| 2. | 5V power adapter | 1 piece |
| 3. | User manual | 1 piece |
| 4. | Remote | 1 piece |
| 5. | IR extension | 1 piece |

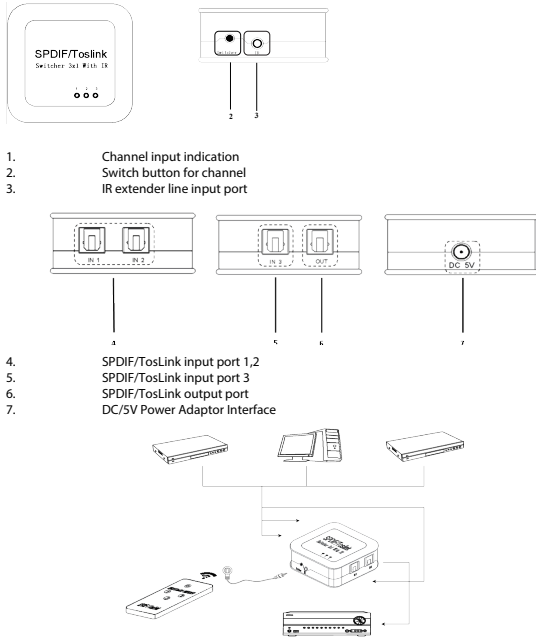

IR Remote Functions



1. Power button
2. SPDIF/Toslink input switch button. If you want to choose input source 2, press numeric key 2

SPECIFICATIONS:

Support audio format.....LPCM2.0/DTS/Dolby-AC3
Peak wavelength.....650nm
Max baud rate.....16Mbps
Output cable distance≤40m(Use the optical fiber cable loss less the 0.2Db/m)
Max working current.....100mA
Power adapter format.....Input:AC (50HZ, 60HZ) 100V-240V Output:DC5V/500mA
Operating Temperature range.....(0 to +40 °C)
Operating Humidity range.....5 to 90%RH (No Condensation)
Dimension (L x W x H).....2.1" x 2.1" x 0.9"
Weight.....1.2 oz

Notes:

- Please use this device as the instructions have described to improve the longevity and safety of the unit.
- 1.The unit should be placed in a location away from damp, high-temperature, dusty, erosive, and oxidative conditions.
 - 2.Please hold the power adapter head and do not pull the power cord when disconnecting from the socket.
 - 3.Please turn the power off when the unit is not being used for long time.
 - 4.Please use the original factory power adapter.

Troubleshooting

Issue	Cause and Ways to deal with
No Power	1. Make sure the power plug is inserted securely into the unit. 2. Check the power source to make sure it is connected to an outlet.
Remote Not Working	1. Make sure the plastic tab is removed from the battery compartment. 2. Make sure the battery has a charge.
No sound output	1. Check the equipment to make sure all pieces are on and in working condition 2. Ensure all cables are properly installed and in working condition

Warranty

This device is warranted against manufactures defects for a period of one year from the date of purchase from the dealer. This warranty extends solely to the repair or replacement of this product and does not cover additional costs, including but not limited to installation or removal of the product or any incidental or consequential damages. Nor does it cover damage due to improper use, storage or application of this device. Should a service issue arise within the one year period, please contact the dealer in which this device was purchased. It will be the sole decision of Stellar Labs to repair or replace any device found to be defective during this period.