

PLEASE CHECK WWW.MOLEX.COM FOR LATEST PART INFORMATION

Part Number: [1730410003](#)
Status: **Active**
Overview: [ValuSeal Wire-to-Wire Connector System](#)
Description: [ValuSeal Crimp Terminal, Male, 16 AWG, Tin \(Sn\)](#)

Documents:

[Drawing \(PDF\)](#) [Test Summary 1728770001-TS-000 \(PDF\)](#)
[Product Specification 1728770001-PS-000 \(PDF\)](#) [RoHS Certificate of Compliance \(PDF\)](#)
[Application Specification 1728770001-AS-000 \(PDF\)](#) [Product Literature \(PDF\)](#)
[Packaging Specification PK-173041-0001-000 \(PDF\)](#)

General

Product Family	Crimp Terminals
Series	173041
Application	Power
Comments	See Product Specification for maximum current rating by circuit size and wire AWG
Crimp Quality Equipment	Yes
Overview	ValuSeal Wire-to-Wire Connector System
Product Literature Order No	987651-3121
Product Name	ValuSeal
UPC	191128088770

Physical

Durability (mating cycles max)	25
Gender	Male
Material - Metal	Copper Alloy
Material - Plating Mating	Tin
Material - Plating Termination	Tin
Net Weight	0.144/g
Packaging Type	Reel
Plating min - Mating	1.524µm
Termination Interface: Style	Crimp or Compression
Wire Insulation Diameter	2.39mm
Wire Size AWG	16
Wire Size mm ²	1.31

Electrical

Current - Maximum per Contact	11.0A
Voltage - Maximum	250V AC

Material Info

Reference - Drawing Numbers

Application Specification	1728770001-AS-000
Packaging Specification	PK-173041-0001-000
Product Specification	1728770001-PS-000
Sales Drawing	SD-173041-0001-000
Test Summary	1728770001-TS-000

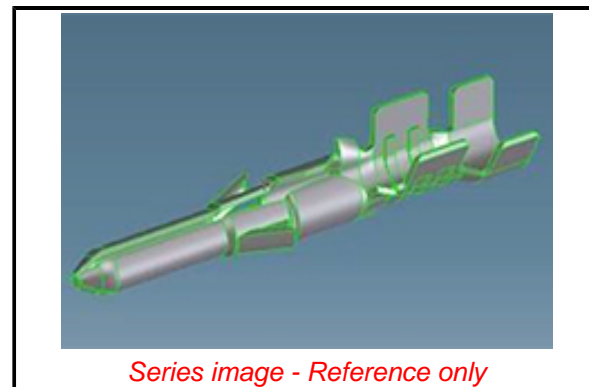

Series image - Reference only

EU ELV

Not Relevant

EU RoHS

Compliant

REACH SVHC

Not Contained Per
-ED/01/2017 (12
January 2017)

Halogen-Free

Status

Low-Halogen

Need more information on product environmental compliance?

Email productcompliance@molex.com
Please visit the [Contact Us](#) section for any non-product compliance questions.

China ROHS	Green Image
ELV	Not Relevant
RoHS Phthalates	Not Contained

Search Parts in this Series

[173041](#) Series

Use With

ValuSeal Plug Housing [172877](#)