

## Features

- Long life element
- Assortment of resistance tapers
- 100 and 60 mm travel lengths
- Touch sense lever
- Snap-in connector
- Single and dual track configurations



## PSL Series Motorized Master Slide Potentiometer

### Electrical Characteristics

Standard Resistance Range ..... 10K ohms to 100K ohms  
 Standard Resistance Tolerance... ±20 %  
 End Resistance ..... 1 ohm max.  
 Insulation Resistance @ 500 VDC ..... 100 megohms min.  
 Dielectric Withstanding Voltage ..... 1000 VAC  
 Standard Taper ..... Linear, Audio  
 Power Rating - Linear ..... 0.5 watt  
 Power Rating - Audio ..... 0.25 watt  
 Slider Noise ..... 60 mV max.  
 Touch Sense Track  
 Conductive Resistance  
 Snap-in Connector ..... 10 ohms max.

### Environmental Characteristics

Operational Life ..... 500,000 cycles  
 TR Shift ..... ±15 %  
 Operating Temperature Range ..... -10 °C to +70 °C  
 Moisture Sensitivity Level ..... 1  
 ESD Classification (HBM) ..... N/A

### Mechanical Characteristics

Mechanical Travel  
 PSL01 ..... 100 mm ± 1 mm  
 PSL60 ..... 60 mm ± 1 mm  
 Operating Force ..... 50 gf  
 Stop Strength ..... 5 kgf

### Motor Drive Characteristics

Rated Voltage ..... 5 VDC  
 Operating Voltage Supply .... 3 to 7 VDC  
 Maximum Current ..... 600 mA max.  
 Lever Speed @ 10 VDC ..... 20 mm/0.1 sec.

### Standard Resistance Table

Resistance (Ohms)	Resistance Code
10,000	103
20,000	203
50,000	503
100,000	104

### Product Dimensions

#### PSL01

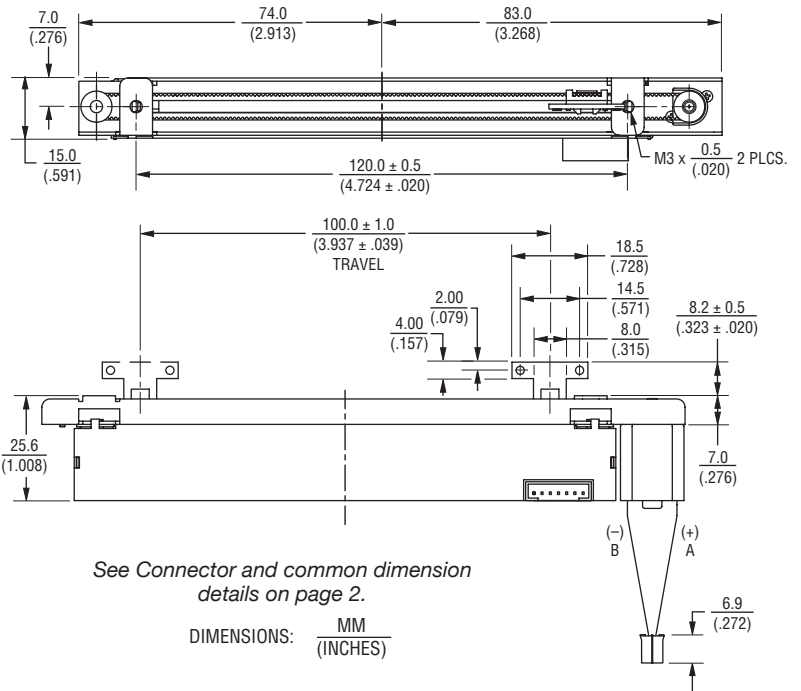

#### PSL60

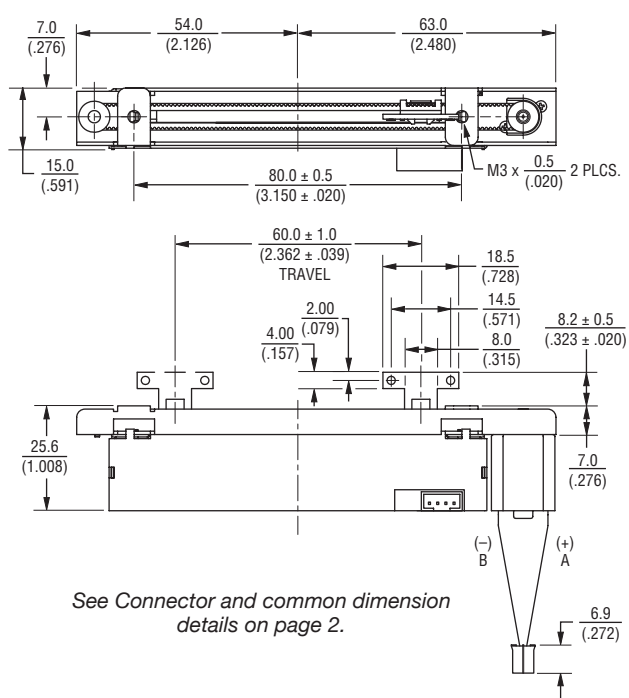

\*RoHS Directive 2002/95/EC Jan. 27, 2003 including annex and RoHS Recast 2011/65/EU June 8, 2011.

Specifications are subject to change without notice.

The device characteristics and parameters in this data sheet can and do vary in different applications and actual device performance may vary over time. Users should verify actual device performance in their specific applications.

## Applications

- Audio mixing consoles
- Broadcast mixing consoles
- Light mixing consoles

# PSL Series Motorized Master Slide Potentiometer

# BOURNS®

## Product Dimensions (Continued)

### Common Dimensions

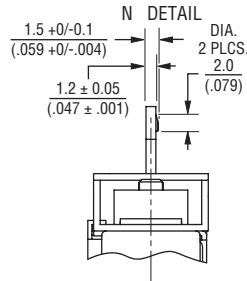
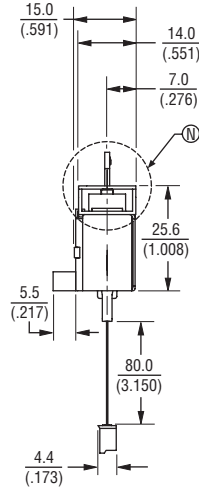

See Connector dimension details below.

DIMENSIONS:  $\frac{\text{MM}}{\text{(INCHES)}}$

## How To Order

**PSL 01 - 1 08 2 A - 103 B2**

Model Number \_\_\_\_\_  
 Designator \_\_\_\_\_  
 PSL = Motorized Master Slide Pot.  
 Length of Travel \_\_\_\_\_  
 01 = 100 mm  
 60 = 60 mm  
 Configuration \_\_\_\_\_  
 1 = Single Track  
 2 = Dual Track  
 3 = Line & Servo Track  
 Lever Length \_\_\_\_\_  
 08 = 8.2 mm  
 Terminal Type \_\_\_\_\_  
 2 = Snap-in Connector  
 Lever End Style \_\_\_\_\_  
 A = Metal Lever (Refer to Drawing)  
 Resistance Code \_\_\_\_\_  
 (See Standard Resistance Table)  
 Resistance Taper (See Taper Charts) \_\_\_\_\_  
 Taper Series followed by Curve Number

## Schematics

### Motor

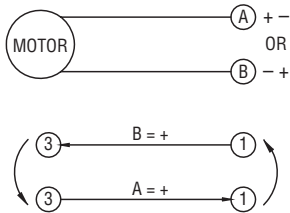

### R1 Track

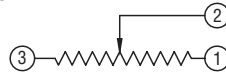

### R2 or Servo Track

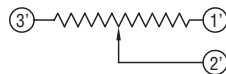

### Touch Sense Track

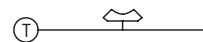

## Connector Dimensions

### Configuration 1

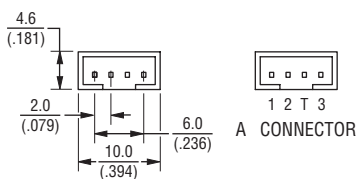

### Configuration 2 & 3

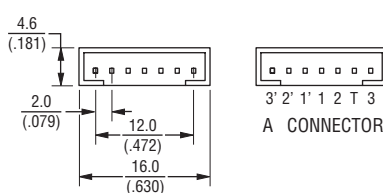

### Motor

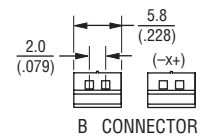

Specifications are subject to change without notice.

The device characteristics and parameters in this data sheet can and do vary in different applications and actual device performance may vary over time. Users should verify actual device performance in their specific applications.

# PSL Series Motorized Master Slide Potentiometer

**BOURNS®**

## Tapers

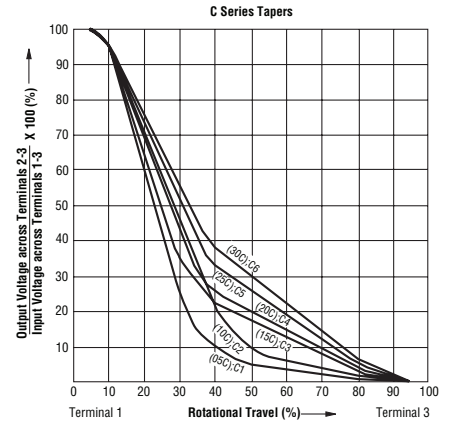
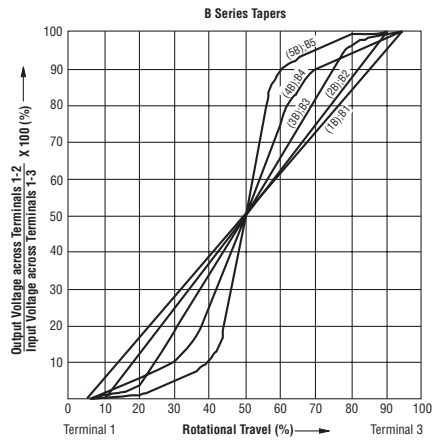
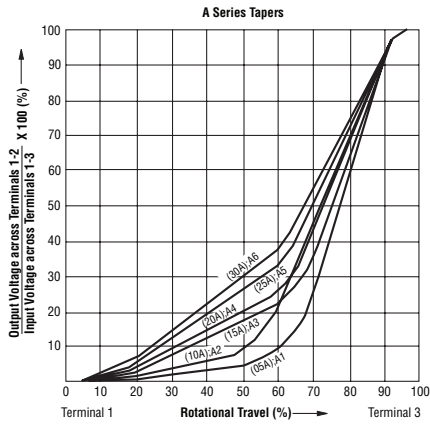

## Servo Track Output Chart

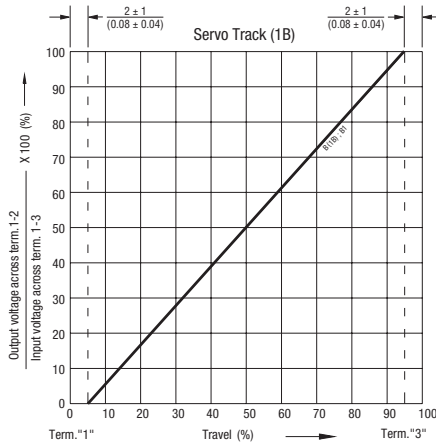

**BOURNS®**

Asia-Pacific: Tel: +886-2 2562-4117 • Email: asiacus@bourns.com

EMEA: Tel: +36 88 520 390 • Email: eurocus@bourns.com

The Americas: Tel: +1-951 781-5500 • Email: americus@bourns.com

www.bourns.com