

Dimensions mm[inch]
 tolerances acc. to DIN ISO 2768-m
 Toleranzen gem. DIN ISO 2768-m

Isometric
 Scale 1:1
 Maßstab 1:1

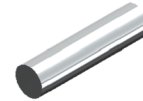
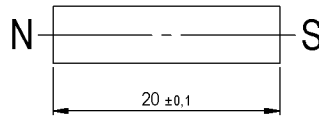
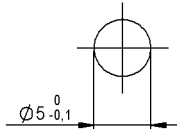

Mag. values DIN IEC 60404-8-	Conditions	Min	Typ	Max	Unit
Remanent Induction Br		1.120	1.240		mT
Revers. temp. coeff. of Br			-0,02		%/K
Coercivity HcB		47	51,3		kA/m
Intrinsic Coercivity HcJ		48	51,7		kA/m
Density			7,4		g/cu cm
Max. operating temperature				450	°C
Magnetic moment	inclusive of 5% tolerance	28,6	32,4		E-6 Vs*cm
Magnet Material		AlNiCo			
Direction of Magnetization		axial			