

EAO – Your Expert Partner for Human Machine Interfaces

K14-131.121061 - Illuminated pushbutton

K14-131.121061 - Illuminated pushbutton



Attention: The preview is based on a sample product. This can differ from your current configuration.

Mounting

Mounting cut-out	Ø 22,3 mm
Design	raised

Front

Front dimension	Ø 29 mm
Front shape	round

Other Attributes

Weight	0.021 kg
Operation current	7/14 mA ±15 %
Operating voltage	24 V AC/DC

Operating-/Indication part

Lens illumination	illuminative
Lens material	Plastic
Lens optics	transparent
Lens profile	flush
Lens colour	blue

IP-Rating

Front protection	IP67
------------------	------

Connection Method

Terminal	Soldering terminal
----------	--------------------

Actuator

Switching action	Momentary
Housing colour	black
Housing material	Plastic

Switching element

Switching system	Snap-action switching element
Switching current	5 A
Contacts	1 NC + 1 NO
Switching voltage	250 V AC/DC
Contact material	

Illumination

LED colour	blue
------------	------

Function

Illuminated pushbutton	
------------------------	--

EAO – Your Expert Partner for Human Machine Interfaces

K14-131.121061 - Illuminated pushbutton

Dimensions

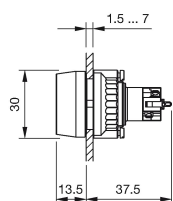

Mounting cut-outs

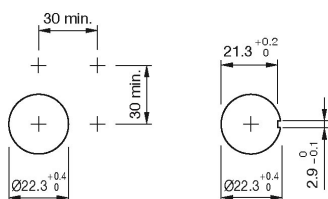

Wiring diagram

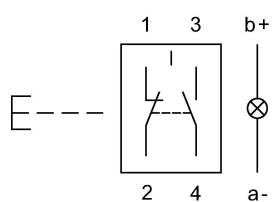

Legend

Contacts: NC = Normally closed, NO = Normally open