

# MANUAL SYRINGE GUN

## **DESCRIPTION:**

The manual syringe gun is a light weight barrel applicator and provides excellent control for low to medium viscosity fluids.

Available in 10, 30 and 55cc, the manual syringe gun is simple to setup and easy to use.

SIZE SYRINGE	PART NUMBER
10 cc	910-MSG
30 cc	930-MSG
55 cc	955-MSG



Figure 1

## **INTENDED USE:**

The manual Syringe Gun is used for professional application of different adhesives. Other use than this has not been evaluated and may lead to an unsafe condition.

Use of this manual gun in ways other than those described in this instruction sheet may result in injury to persons or damage to property.

## **SAFETY INFORMATION:**

### **WARNING**

Always read and follow the instruction of the safety Data Sheet (SDS) of the used adhesive. Failure to follow may result in personal injury.

**SETUP INSTRUCTIONS:** (Refer to Figure 2)

1. Press the lock button (#2) and insert the push rod (#3) to the gun body; make sure the push rod is pushed all the way back
2. Insert the syringe barrel assembly (#1) into the gun assembly and turn clockwise to lock
3. Install the dispense tip to the syringe barrel outlet
4. Squeeze the trigger (#4) to start dispensing
5. Press the lock button and pull the push rod back to remove the syringe barrel assembly

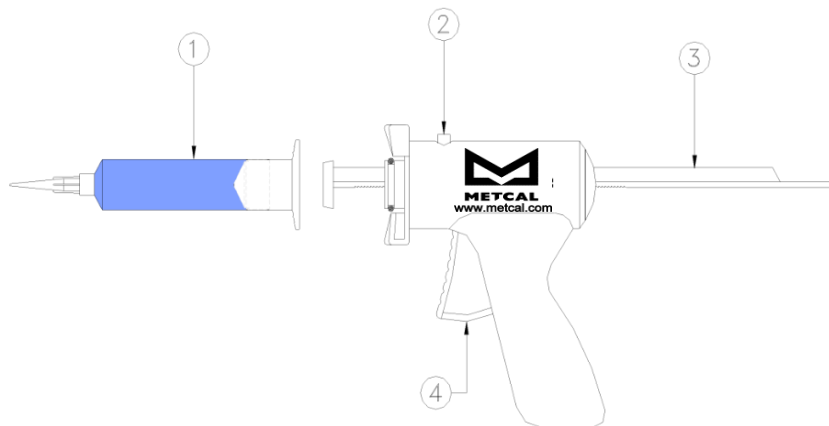

Figure 2

**PARTS LISTS:**

Gun Assembly	Item #	Replacement Component	Description
910-MSG	1	71000ROD	Push Rod, 10 cc
	2	910-WW	Piston, 10 cc
	3	910-N	Barrel, 10 cc
	4	900-ORTC	Tip Cap
930-MSG	1	73000ROD	Push Rod, 30 cc
	2	930-WW	Piston, 30 cc
	3	930-N	Barrel, 30 cc
	4	900-ORTC	Tip Cap
955-MSG	1	75500ROD-C	Push Rod, 55 cc
	2	930-WW	Piston, 30 cc
	3	955-N	Barrel, 30 cc
	4	900-ORTC	Tip Cap

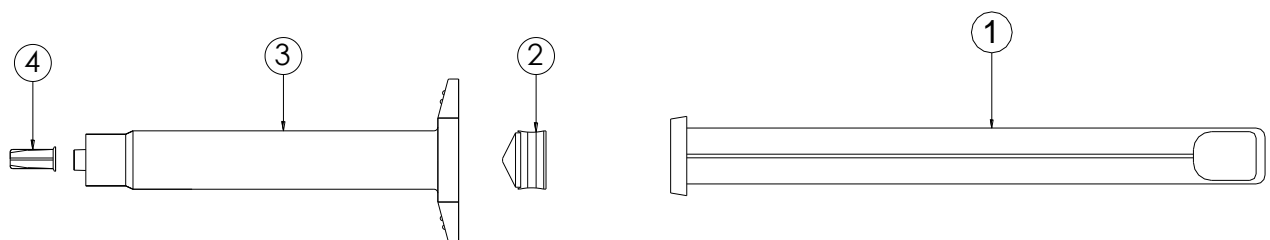

Figure 3

7000-2230\_F