

DO NOT SCALE DRAWING

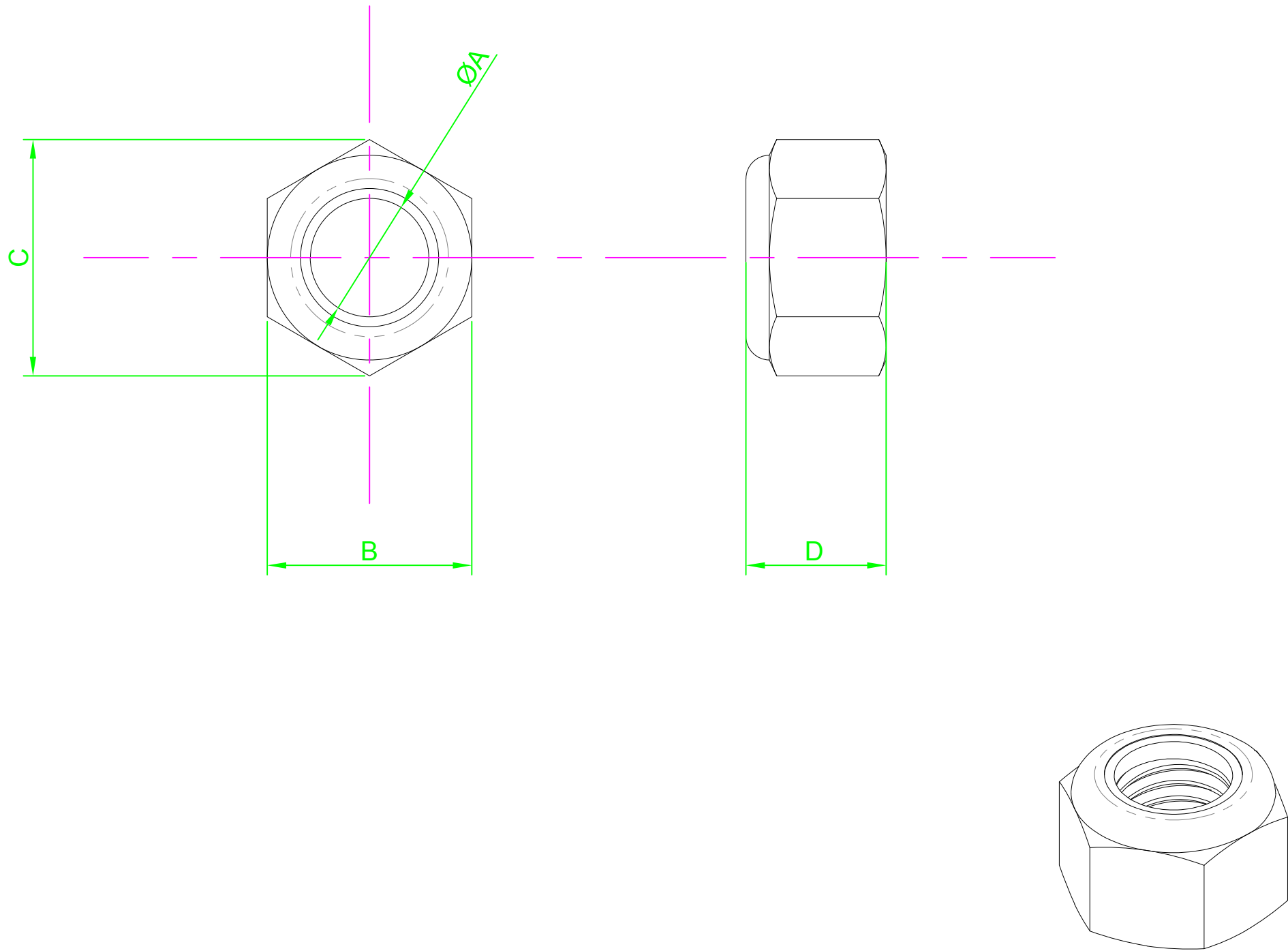

REVISION

A INITIAL DRAWING 04.01.16

Part Number	$\text{ØA}$	B Nom	C Min	D Max
M3 - N5A2- S100	M3-0.5	5.5	6.58	4.0
M4 - N5A2- S100	M4-0.7	7	7.66	5.0
M5 - N5A2- S100	M5-0.8	8	8.79	5.0
M6 - N5A2- S100	M6-1.0	10	11.05	6.0

NOTES:



DESIGN RIGHT. TR FASTENINGS LTD, 2003  
 UNDER NO CIRCUMSTANCES MUST THIS  
 DRAWING BE COPIED OR DISCLOSED  
 WITHOUT FIRST OBTAINING WRITTEN  
 AUTHORITY.

UNLESS OTHERWISE SPECIFIED:  
 DIMENSIONS ARE IN MM (MILLIMETERS).  
 SURFACE FINISH:  
 TOLERANCES: DIN 985

	NAME	DATE
DRAWN	Darryl Wilson	04.01.16
CHK'D		
APPVD		

MATERIAL:  
 Stainless Steel A2

HEAT TREATMENT:

TITLE:  
 Prevailing Torque Type Hex Thin Nut with  
 Non-Metallic Insert DIN985

CUSTOMER PART NUMBER:  
 N/A

FINISH:

DRAWING NUMBER:  
 TR32N5A2-S100

A4