



Inspired Wireless M2M Technology



## ZETA-N Series

Modem Starter Kit

Quick Start Guide

Rev 1.5

---

## Whats in the Box?

As standard, the ZETA starter kit comes with the following\*:

- » ZETA-N-XXXX modem
- » Power supply OR power cable
- » Mike 1A antenna
- » RS232 male to USB cable
- » Quick start guide

**NOTE** - The ZETA modem requires a data enabled SIM card to work. The unit is supplied without a SIM, please acquire a SIM from a suitable SIM provider - please note Three SIM cards will not work with the ZETA-N-GPRS.

\*If you have purchased the ZETA as a standalone modem, you will need to purchase the other accessories seperately from [www.siretta.co.uk](http://www.siretta.co.uk)

---

## Setting up the ZETA

**Step 1.** Insert a SIM card fully into the SIM slot. Once the SIM card has been correctly inserted, a click will be heard.



**Step 2.** Screw the antenna onto the ZETA. Twist the antenna connector clock-wise until the antenna is firmly connected.



---

**Step 3.** Using the supplied RS232 cable, connect the RS232 male connector into the RS232 port on the ZETA. Connect the RS232 female connector (other end of the cable) into an RS232 port on your PC.

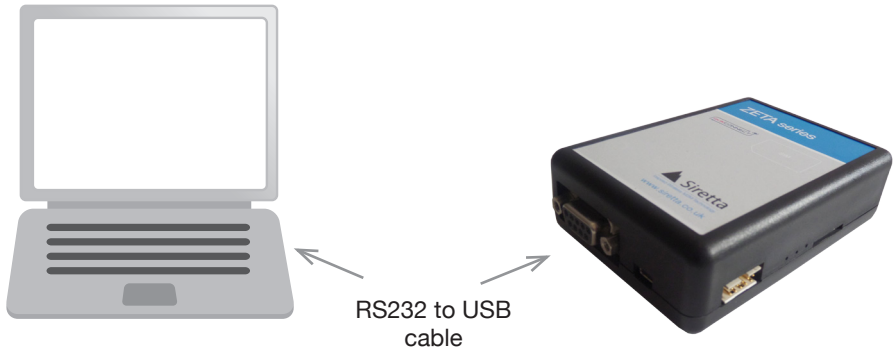

**Step 4.** Open 'HyperTerminal' on your PC. You will be requested to enter the number of the COM port your are using to communicate between the ZETA and PC. Upon request, ensure the following information is inserted:

- » Bits Per Second: 115200
- » Data Bits: 8
- » Parity: None
- » Stop Bit: 1
- » Flow Control: Hardware

---

## IF USING POWER SUPPLY

**Step 5.** Plug the power supply into the ZETA. Ensure the mains supply is plugged into a power source and switched on. The red LED on the ZETA will start flashing\*, this indicates that power has been supplied. See **table 1 (overpage)** for ZETA-N-GPRS LED indication and **table 2 (overpage)** for ZETA-N-UMTS LED indication.

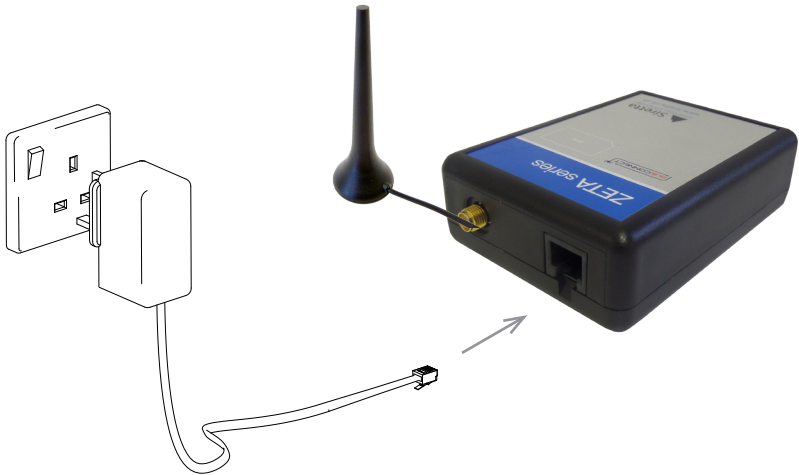

Flashing red LED indicates power on



\*If this step fails, please try again. If it fails a second time, please contact your Siretta representative or call us on +44 (0)118 976 9014.

---

## IF USING POWER CABLE

**Step 5.** Plug the power cable into the ZETA. The other end of the power cable has a black and red wire, connect the red wire to the positive (red) terminal on the bench supply, connect the black wire to the negative (black) terminal on the bench supply. When you have double checked the connections and have set the output voltage to nominal 12V, you can power on the unit. The red LED on the ZETA will start flashing\*, this indicates that power has been supplied. See **table 1 (overpage)** for ZETA-N-GPRS LED indication and **table 2 (overpage)** for ZETA-N-UMTS LED indication.

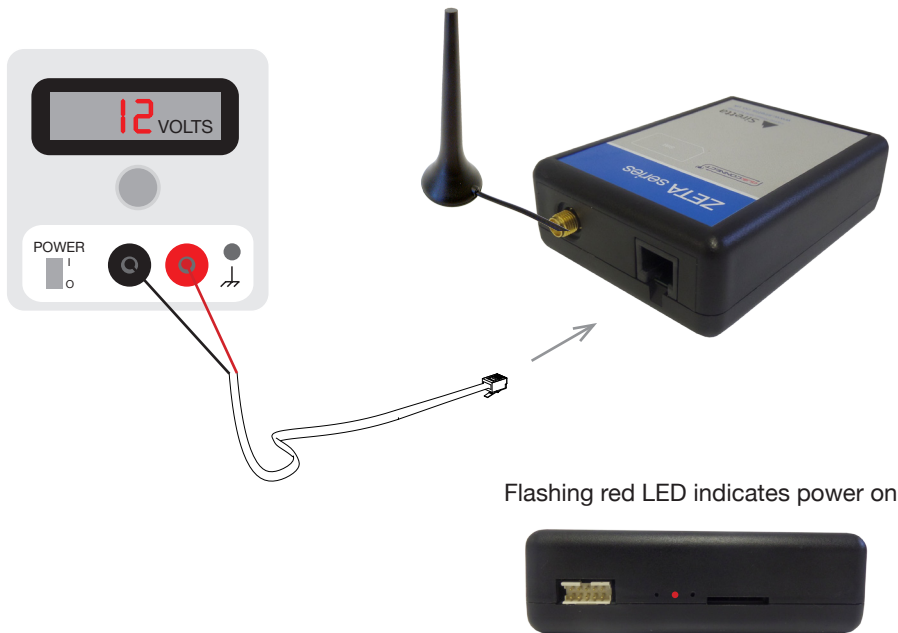

Flashing red LED indicates power on

\*If this step fails, please try again. If it fails a second time, please contact your Siretta representative or call us on +44 (0)118 976 9014.

---

## SAME FOR POWER SUPPLY / POWER CABLE

Table 1. ZETA-N-GPRS LED indication

LED colour	State
	Flash rate once per second: Network search / not registered / turning off
Red (STAT_LED)	Slow rate once every 3 seconds: Registered full service Constant ON: Ringing OR call in progress OFF: Module power down
Green (GPIO 1)	Reserved / Special Function / Test
Blue (GPIO 2)	Reserved / Special Function / Test

Table 2. ZETA-N-UMTS LED indication

LED colour	State
	Constant ON: Network search / not registered / call in progress
Red (STAT_LED)	Slow rate once every 3 seconds: Registered full service OFF: Module power down
Green (GPIO 1)	Reserved / Special Function / Test
Blue (GPIO 2)	Reserved / Special Function / Test

**Step 6.** In the 'Hyperterminal' command window, type in the command:

```
AT<cr>
```

The command window will respond with:

```
OK
```

Your ZETA is now connected and ready to start communication.



**sales** +44 (0)118 976 9014

**fax** +44 (0)118 976 9020

**accounts** +44 (0)118 976 9069

**email** [sales@siretta.co.uk](mailto:sales@siretta.co.uk)

[www.siretta.co.uk](http://www.siretta.co.uk)

Basingstoke Road  
Spencers Wood  
Reading  
Berkshire  
RG7 1PW  
United Kingdom

Company No. 08405712  
VAT Registration No. GB163 04 0349

A member of the Olancha Group Ltd

