

NEXT GENERATION GRACE INERTIA CONNECTOR 3.3

新优雅系列 3.3 节距连接器

1. Applicable Product Part Number:

适用产品:

Description 描述	Part No. 料号	Wire Size 适用线型 mm ² (AWG)	Insulation Diameter 绝缘外径 (mm)
REC CONTACT 母型端子	1983780-1	0.21~0.53 (AWG#24~#20)	φ 1.5~2.5
	1971795-1	0.079~0.14 (AWG 26#~28#, UL1061)	φ 0.8~φ 1.5 *

(*) Wire Insulation Dia must be within:0.8~φ 1.36mm For TPA: 4-1971904-2 and-1971904-3.

(*) TPA: 4-1971904-2 and-1971904-3 适用的导线绝缘部线径: 0.8-1.36mm

2. Nomenclature and Crimping Features:

术语与压接特征:

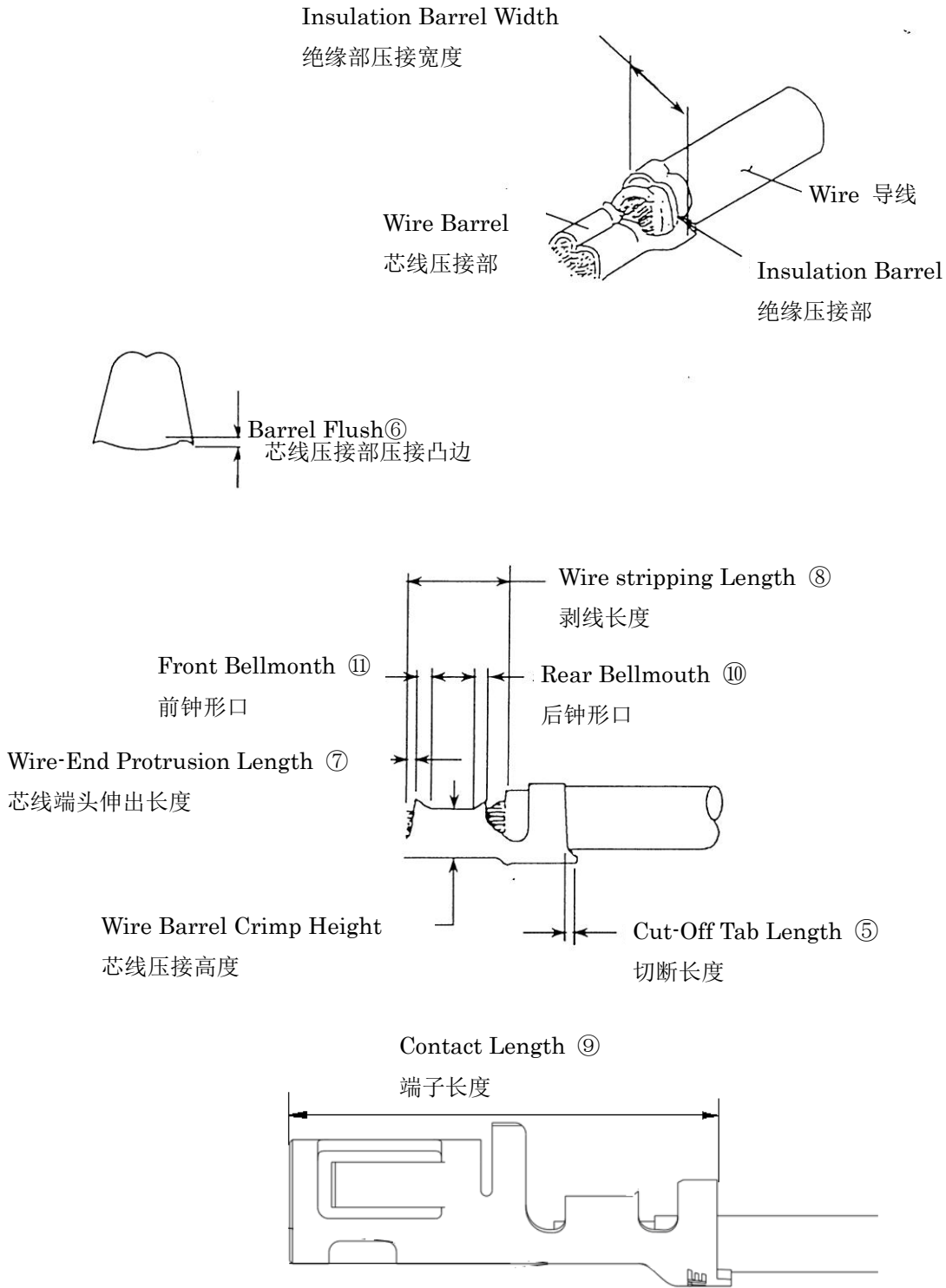

Fig.1

3. Crimping Conditions and Crimp Data: 压接参数

3.1 Crimping Conditions: 压接要求:

No.	Item		Spec	Refer
1	Allowable Deviation after Crimping 压接后, 允许变形	Bend-up 上翘角度	1° Max.	Fig.2 ①
		Bend-down 下翘角度	2° Max.	Fig.3 ②
		Twisting 扭弯角度	3° Max.	Fig.4 ③
		Rolling 卷摆角度	5° Max.	Fig.5 ④
2	Cut-Off-Tab Length 切断长度		1971795-1: 0.25MAX 1983780-1: see Fig.6	Fig.1 ⑤
3	Bellmouth 钟形口	Rear 后端	0.1~0.3mm	Fig.1 ⑩
4	Anvil Flush 芯线压接部压接凸边		0.2mm Max.	Fig.1 ⑥
5	Wire-End Protrusion Length 芯线端头伸出长度		0.1~0.65mm	Fig.1 ⑦
6	Insulation stripping Length 剥线长度	One-Wire Crimp 单根线压接	2±0.3mm	Fig.1 ⑧
7	Contact length after crimping 压接后端子总长	1983780-1	8.4±0.25mm	Fig.1 ⑨
		1971795-1	7.55±0.2mm	Fig.1 ⑨

1983780-1 cut-off tab dimensions and step after-crimping dimensions as below:

1983780-1 切断打弯及压接后台阶尺寸规范:

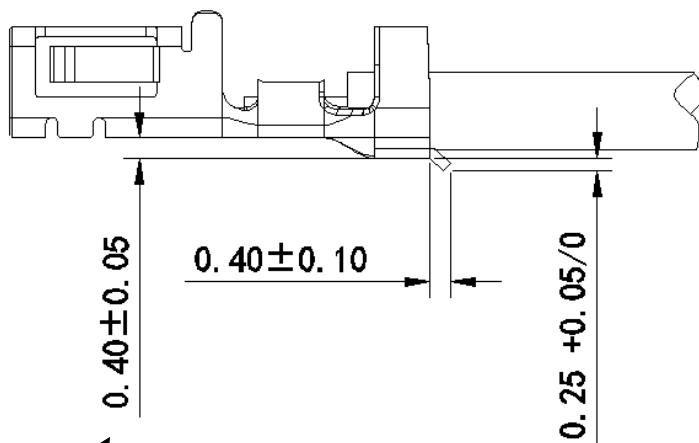
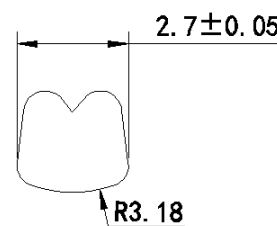

Fig.6

Step after crimping
压接后台阶



Insulation Barrel FOR 1983780-1
1983780-1 绝缘压接部

Fig.7

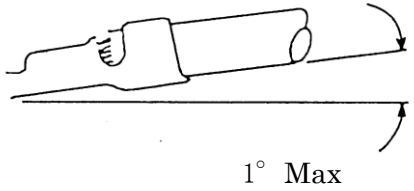
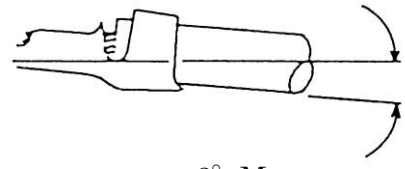
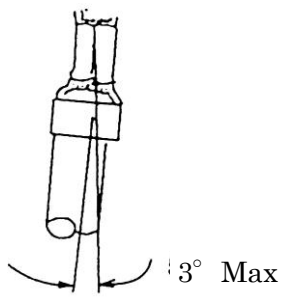
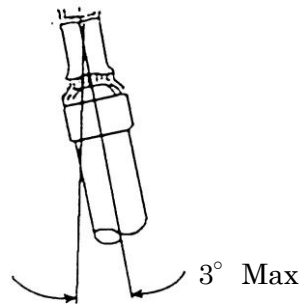
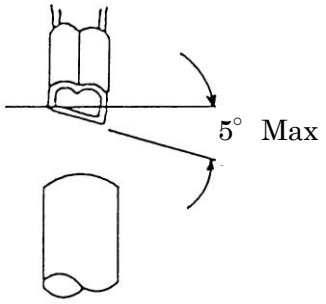
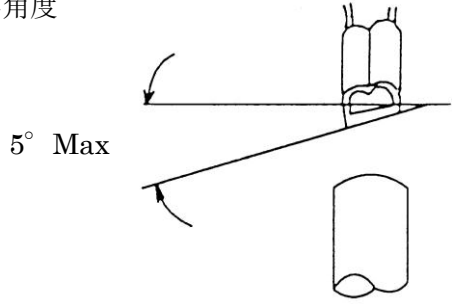
<p>① Bend-up 上翘角度</p>  <p>1° Max</p> <p>Fig. 2</p>	<p>② Bend-down 下翘角度</p>  <p>2° Max</p> <p>Fig. 3</p>
<p>③ Twisting 扭弯角度</p>  <p>3° Max</p> <p>Fig. 4-1</p>	<p>③ Twisting 扭弯角度</p>  <p>3° Max</p> <p>Fig. 4-2</p>
<p>④ Rolling 卷摆角度</p>  <p>5° Max</p> <p>Fig. 5-1</p>	<p>④ Rolling 卷摆角度</p>  <p>5° Max</p> <p>Fig. 5-2</p>

3-2. Crimping Data 压接参数 3-2-1 Application Crimp 自动工具

Contact Part No. 端子料号 (带料)	Applicator Number. 工具编号	Wire Size 线型		Insulation Stripping Length ± 绝缘层剥线长度 (mm)	Wire Barrel Crimp 芯线压接部分			Insulation Barrel Crimp 绝缘部分压接参数		Finished Insulation Diameter 绝缘压接完成直径 (mm)	Crimp Tensile Strength 压拉伸强度 (kg)min.
		No. 数量	mm ² (AWG)		Width 压接宽度 (mm)	Height 压接高度 ±0.03 (mm)	Disk Symbol 识别码	Width 压接宽度 (mm)	Height 压接高度 (mm)		
1971795-1	1729418-2	1	0.079 (Φ0.12/7) (#28)	2±0.3	1.16 (Ref)	E	1.45 "F"	1.7 ref.	0.8~1.1	1	
		1	0.12~0.15 (#26)			D					2
1983780-1	1762389-2 (*1); 2088571-2; 1552510-2	1	0.21~0.23 (#24)	2±0.5	1.27 "F"	C	2.6"F" (After crimping, need to meet Fig.7 on Page3)	*2)	1.5~2.5	3	
		1	0.31~0.38 (#22)			B				5	
		1	0.51~0.53 (#20)			A				6	

- (*1) 1762389-2 are not available on TE now. (TE暂时不提供1762389-2)
- (*2) Insulation barrel crimp height must apply following (绝缘部压接高度)
- ①Applicable wire insulation dia ϕ : 1.5 $\leq\phi\leq$ 2.0; Height: 2.4-2.7mm.
导线绝缘部直径 ϕ : 1.5 $\leq\phi\leq$ 2.0; 绝缘压接高度: 2.4-2.7mm.
- ②Applicable wire insulation dia ϕ : 2.0 $\times\phi<$ 2.4; Height: 2.6-2.8 mm
导线绝缘部直径 ϕ : 2.0 $\times\phi<$ 2.4; 绝缘压接高度: 2.6-2.8mm.
- ③Applicable wire insulation dia ϕ : 2.4 $\leq\phi\leq$ 2.5; Height: 2.75-2.85 mm
导线绝缘部直径 ϕ : 2.4 $\leq\phi\leq$ 2.5; 绝缘压接高度: 2.75-2.85mm.

3-2-2 Hand Tool Crimp
手动工具

Contact Part No. 端子料号 (带料)	Hand Tool Number. 工具编号	Wire Size 线型		Insulation Stripping Length 绝缘层剥线长度 (mm)	Wire Barrel Crimp 芯线压接部分			Insulation Barrel Crimp Width 绝缘部分压接宽度 (mm)	Finished insulation Diameter 绝缘压接完成直径 (mm)	Crimp Tensile Strength 压接拉伸强度 (kg)min.
		No. 数量	mm ² (AWG)		Width 压接宽度 (mm)	Height 压接高度 ±0.05 (mm)	Disk Symbol 识别码			
1971795-1	1729688-1	1	0.079 (Φ0.12/7) (#28)	2±0.3	1.16 (Ref)	0.59±0.69	---	1.45 "F"	0.8~1.1	1
		1	0.12~0.15 (#26)							---
1983780-1	2844729-1	1	0.21~0.23 (#24)	2±0.5	1.27 "F"	0.75	B	2.6"F"	1.5~2.5	3
		1	0.31~0.38 (#22)							5
		1	0.51~0.53 (#20)							6