

HYSHED HINGE COVER ENCLOSURES, IP69K



INDUSTRY STANDARDS

Mounting brackets required to meet UL/cUL external mounting requirement.

Hoffman Industrial Control Enclosures / Models HSDS##SS and HSDH##SS / HyShed Screw Cover and Hinged Cover holds a 3-A SSI Replacement Parts and System Component Qualification Certificate and conforms to applicable provisions of 3-A Sanitary Standard for General Requirements, ANSI/3-A 00-01-2018

UL 508A Listed; Type 4, 4X, 12; File Number E61997
 cUL Listed per CSA C22.2 No 94; Type 4, 4X, 12; File Number E61997
 UL and cUL Classified to IEC 60529, IP66, IP69; File Number E503705

NSF 169 Special Purpose Food Equipment and Devices
 3-A SSI Replacement Parts and System Component Qualification Certificate
 NEMA/EEMAC Type 4, 4X, 12
 DIN 40050-9, IP69K
 IEC 60529, IP66, IP69

APPLICATION

Engineered specially to withstand high pressure, high temperature sanitary washdown cleaning procedures, particularly in Food & Beverage applications that have direct and indirect food contact. The HyShed Hinge Cover enclosures feature a 15-degree sloped top to prevent fluids or particulates from pooling and maximize back panel space, an easily replaceable FDA-grade silicone gasket that helps resist bacteria growth and chemical absorption while simplifying maintenance, and a streamlined hygienic design that helps wipe out bacteria harboring catchpoints.

SPECIFICATIONS

- Manufactured from 14 gauge Type 304 stainless steel
- 15-degree sloped top facilitates runoff of water and cleaning solutions; prevents fluids or particulates from pooling
- Door edges are sloped to facilitate runoff
- Replaceable FDA-grade silicone gasket compliant with FDA Guideline 21 CFR 177.2600
- Gasket is sanitary Pantone 287 blue color for easy detection by common food scanning equipment and vision systems
- Internally mounted hinges to reduce bacteria-harboring catch points
- Stainless steel crevice-free latch surfaces to reduce bacteria harboring catch points; uses standard tool to open
- Solid back with no pre-tapped mounting holes for easy weld mounting; optional IP69K sanitary stand-off kit available.
- 105-degree door opening
- Self-grounding latch system with double seal
- Seams continuously welded and ground smooth
- Bonding provision on door; grounding stud on body
- Furnished hardware kit consists of panel mounting kit and grounding kit

FINISH

#4 Dairy finish.

ACCESSORIES

Panels for Type 3R, 4, 4X, 12 and 13 Enclosures
 IP69K Stand-Off Kit
 Replacement FDA-Grade Silicone Gasket
 Replacement Doors

BULLETIN: HS1

Standard Product

Catalog Number	AxBxC in./mm	Panel	Conductive Panel	Stainless Steel Panel	A2 in./mm	Latch Qty.	Replacement Gasket
HSDH161608SS	16.00 x 16.00 x 8.00 406 x 406 x 203	A16P16	A16P16G	A16P16SS6	18.11 460	2	HSDH1616GSK
HSDH201608SS	20.00 x 16.00 x 8.00 508 x 406 x 203	A20P16	A20P16G	A20P16SS6	22.11 562	2	HSDH2016GSK
HSDH202008SS	20.00 x 20.00 x 8.00 508 x 508 x 203	A20P20	A20P16G	A20P16SS6	22.11 562	4	HSDH2020GSK
HSDH202010SS	20.00 x 20.00 x 10.00 508 x 508 x 254	A20P20	A20P16G	A20P16SS6	22.68 576	4	HSDH2020GSK
HSDH242008SS	24.00 x 20.00 x 8.00 610 x 508 x 203	A24P20	A24P20G	A24P20SS6	26.11 663	4	HSDH2420GSK
HSDH242010SS	24.00 x 20.00 x 10.00 610 x 508 x 254	A24P20	A24P20G	A24P20SS6	26.68 678	4	HSDH2420GSK
HSDH242012SS	24.00 x 20.00 x 12.00 610 x 508 x 305	A24P20	A24P20G	A24P20SS6	27.21 691	4	HSDH2420GSK
HSDH242408SS	24.00 x 24.00 x 8.00 610 x 610 x 203	A24P24	A24P24G	A24P24SS6	26.11 663	4	HSDH2424GSK
HSDH242410SS	24.00 x 24.00 x 10.00 610 x 610 x 254	A24P24	A24P24G	A24P24SS6	26.68 678	4	HSDH2424GSK
HSDH242412SS	24.00 x 24.00 x 12.00 610 x 610 x 305	A24P24	A24P24G	A24P24SS6	27.21 691	4	HSDH2424GSK
HSDH302408SS	30.00 x 24.00 x 8.00 762 x 610 x 203	A30P24	A30P24G	A30P24SS6	32.11 816	4	HSDH3024GSK
HSDH302412SS	30.00 x 24.00 x 12.00 762 x 610 x 305	A30P24	A30P24G	A30P24SS6	33.21 844	4	HSDH3024GSK
HSDH363012SS	36.00 x 30.00 x 12.00 914 x 762 x 305	A36P30	A36P30G	A36P30SS6	39.21 996	5	HSDH3630GSK
HSDH363016SS	36.00 x 30.00 x 16.00 914 x 762 x 406	A36P30	A36P30G	A36P30SS6	40.28 1023	5	HSDH3630GSK
HSDH423612SS	42.00 x 36.00 x 12.00 1067 x 914 x 305	A42P36	A42P36G	A42P36SS6	45.21 1148	7	HSDH4236GSK
HSDH423616SS	42.00 x 36.00 x 16.00 1067 x 914 x 406	A42P36	A42P36G	A42P36SS6	46.28 1176	7	HSDH4236GSK
HSDH483612SS	48.00 x 36.00 x 12.00 1219 x 914 x 305	A48P36	A48P36G	A48P36SS6	51.21 1301	7	HSDH4836GSK
HSDH483616SS	48.00 x 36.00 x 16.00 1219 x 914 x 406	A48P36	A48P36G	A48P36SS6	52.28 1328	7	HSDH4836GSK

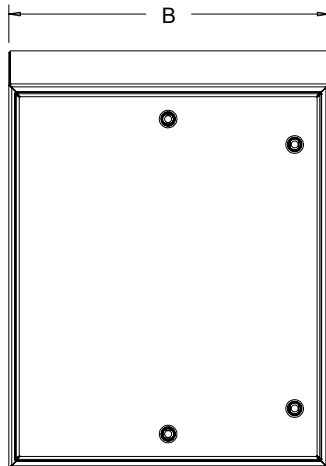

89166428

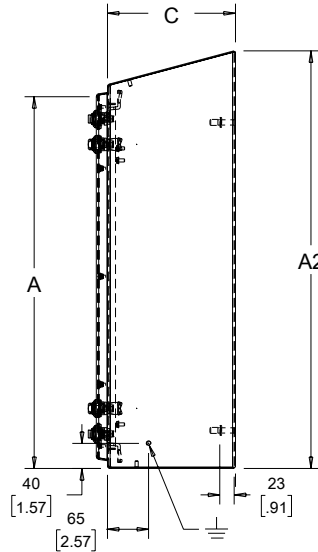

IP69K STAND-OFF KIT

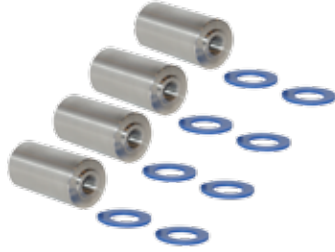

BULLETIN: HSY

Standard Product

Catalog Number	C in./mm
HSSOK2SS	2.00 51
HSSOK4SS	4.00 102

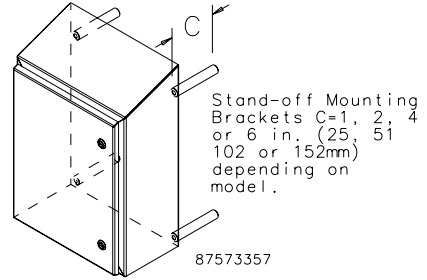

REPLACEMENT FDA-GRADE SILICONE GASKET FOR HINGED COVER ENCLOSURES



BULLETIN: HSY

Standard Product

Catalog Number	Fits Enclosure A x B in./mm
HSDH1616GSK	16.00 x 16.00 406 x 406
HSDH2016GSK	20.00 x 16.00 508 x 406
HSDH2020GSK	20.00 x 20.00 508 x 508
HSDH2420GSK	24.00 x 20.00 610 x 508
HSDH2424GSK	24.00 x 24.00 610 x 610
HSDH3024GSK	30.00 x 24.00 762 x 610
HSDH3630GSK	36.00 x 30.00 914 x 762
HSDH4236GSK	42.00 x 36.00 1067 x 914
HSDH4836GSK	48.00 x 36.00 1219 x 914

Notes