

User Manual

Omnidirectional Antenna Kit With Mount and Cable



Part Number: 30-2447

INTRODUCTION:

This is a special designed new concept antenna for digital indoor and outdoor analog and terrestrial HDTV broadcasting reception. It is the best solution for home reception and digital portable TV reception. Complete accessories are included for wall or pole mounting. With the anti-UV and water proof housing, it can be used both indoor and outdoor.

Technical Data:

- Frequency Range: VHF87.5-230MHz UHF470-862MHz
- Receiving range: FM VHF UHF
- Antenna Gain: 32dB
- Max. Output level: 100dB μ V
- Impedance: 75 Ω
- Power Supply: DC 12V 50mA

Included in Package:

Before start your installation, please check the contents.

1. Antenna main unit with mounting accessories
2. Water-proof kit
3. Power adapter
4. Power inserter
5. Mast pipe
6. Black coaxial cable



Product Features:

- Anti-UV coating and waterproof design.
- Lightweight, compact size and easy to install.
- For both analog and digital TV signal reception
- Built-in high gain and low noise preamplifier
- **Omni-directional** characteristics provide excellent non-adjustments reception in different directions
- With dipole inbuilt for the excellent UHF and VHF band signal reception.
- Specially Compatible with HDTV of various digital terrestrial signal (DVB-T; ISDB-T; DMB-T/H; ATSC)

User Manual

Mounting the antenna:

This antenna can be used both indoor and outdoor, with the included mounting accessories, it can be mounted on the wall or the pole.

(Fig.1) use the screws and wall mounting accessories to fix the antenna on the wall



Fig.1

(Fig.2) Use the mounting accessories to fix the antenna on the balcony.

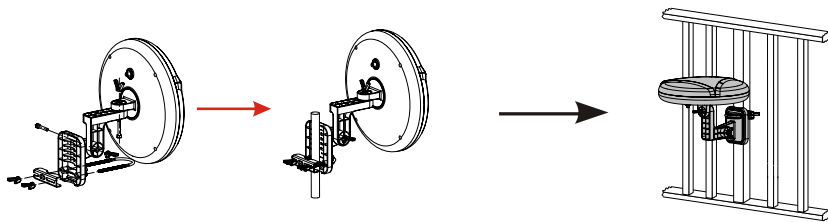

Fig.2

(Fig.3) use the pole mounting accessories to fix the antenna on the pole.

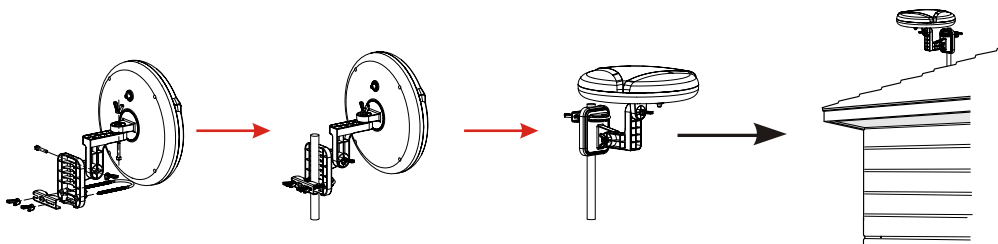

Fig.3

(Fig.4) Available for mobile use

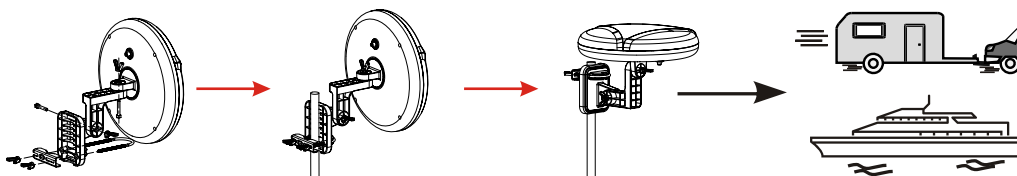
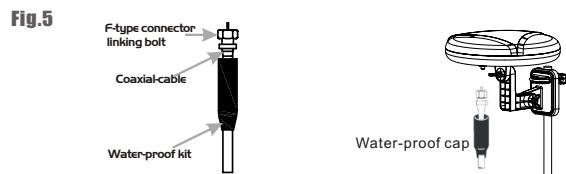

Fig.4

User Manual

(Fig.5) connect the "F" male connector of the coaxial cable to the "F" female connector of the antenna, and wear the water-proof cap to the end of the connected "F" connector.



Installation: Please take following (Fig.6) and (Fig.7) installation instruction for reference.

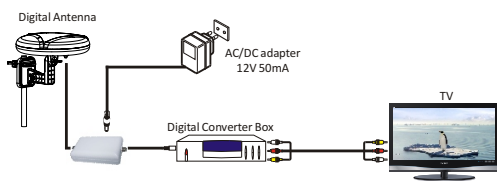

Installation 1: Connected Through digital converter box (FIG.6)

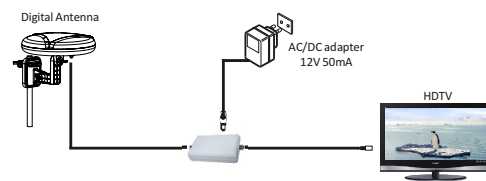

Installation 2: Directly connected to HDTV (FIG.7)

Note: After the antenna mounting and installation is finished, please adjust the antenna in the best position that can get clear TV picture, then fix the antenna, organize the coaxial cable for neat, tidy and safety,

Operation Instruction:

Note: For the best reception, please check the following conditions

1. Keep the antenna away from the sources of interference: keep the antenna away from those big power consumption devices, such as air conditioner, elevator, hair dryer and microwave oven...etc.
2. Place the antenna near windows when use the antenna in indoor environment.
3. Install the antenna as high as possible: in digital terrestrial reception, if there are some interceptions between antenna and transmission tower, it will cause the signal loss temporarily. So if the antenna is installed as possible, those interceptions will be reduced.

