

Long-Life DC Tubular Solenoid



Model LT8x16

Features:

- Long life construction
- Plunger stop for quiet operation
- DC solenoid applications only
- UL recognized
- Stainless steel guide tube
- Teflon coated plunger



Electrical:

- Coil Voltages: 6, 12, 24, 48, 110 VDC standard
- Coil Termination: 6.5" Wire leads
22 AWG (standard)
- Duty Cycle: 100% Continuous, 25% Intermittent,
10% Intermittent, 1% Pulse
- Coil treatment: Tape Wrapped
- Insulation Class: Class A Rating - 105°C (221°F)
- Dielectric Strength: 1500V 60 Hz

Mechanical:

- Size: 2" (L) x 1" (D)
- Plunger Diameter: 0.437"
- Plunger Guide Material: Stainless Steel
- Mounting: Hex Nut
- Weight: Plunger 1.4 oz, Total 6.4 oz
- Life Expectancy: 10 Million Cycles¹

¹ - Dependent on load conditions

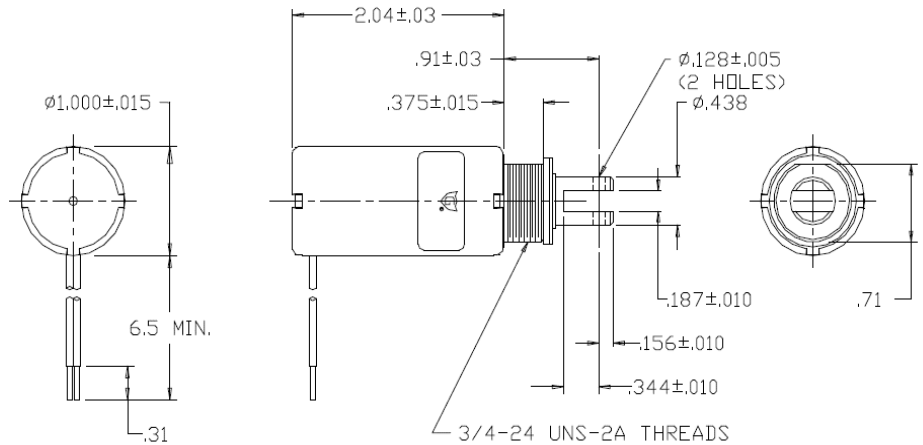

Solenoid shown energized with plunger fully seated
Supplied with mounting bracket, hex nut and lock washer shipped loose

Standard Part Numbers

Model No.	Part No.	Duty Cycle	Voltage	Resistance ² (Ω)	Power (W)	Current
LT8x16-C-12D	A420-064850-00	Cont.	12VDC	19.3	7.8	622 mA
LT8x16-I-12D	A420-064851-00	Inter.	12VDC	6.2	24.4	1.94 A
LT8x16-C-24D	A420-064852-00	Cont.	24VDC	77.2	7.8	311 mA
LT8x16-I-24D	A420-064853-00	Inter.	24VDC	29.7	20.4	808 mA

² - Coil resistance tolerance +/- 5%

Contact us for custom voltages or duty cycles

Available Customization:

- Plunger
- Lead and Connector
- DC Voltage
- Duty Cycle
- Insulation systems up to class H 180° C (356° F)
* Minimum quantities apply

Stroke (in.)	Typical Pull Force Ounces [N] @ 20°C (68°F) (Distance from fully seated position)									HOLDING FORCE Ounces [N]	Power (W)
	0.050	0.125	0.250	0.375	0.500	0.625	0.750	1.000			
Continuous 100%	45 [12.5]	28 [7.8]	12 [3.3]	9 [2.5]	5 [1.4]	3 [0.8]	1 [0.3]	N/A	139 [38.6]	7.8	
Intermittent 25%	80 [22.2]	55 [15.3]	35 [9.7]	25 [7]	15 [4.2]	10 [2.8]	3 [0.8]	N/A	160 [44.5]	23	
Intermittent 10% ³	124 [34.5]	99 [27.5]	75 [20.9]	60 [16.7]	45 [12.5]	38 [10.6]	28 [7.8]	7 [1.9]	455 [126.5]	72.2	
Pulse 1% ³	154 [42.8]	138 [38.4]	120 [33.4]	89 [24.7]	74 [20.6]	60 [16.7]	50 [13.9]	15 [4.2]	N/A	146.8	

Optional Return Spring Kit

A490-367460-20

Continuous Duty 100% = 100% On Time
Intermittent Duty 25% = 25% On Time (100 Seconds On Max Followed By 300 Seconds Off)
Intermittent Duty 10% = 90% On Time (10 Seconds On Max Followed By 90 Seconds Off)
Pulse Duty 1% = 99% On Time (1 Second On Max Followed By 99 Seconds Off)

³ - Calculated force values to be verified in application



GUARDIAN-ELECTRIC.COM

1425 Lake Ave - Woodstock IL 60098 - Phone: 800-762-0369
The information is subject to change without notice. © Guardian Electric

