

# PCB TERMINAL BLOCKS

## Screwless Terminal Blocks

- 1-36 poles 5, 5.08mm pitch
  - 1-24 poles 7.5, 7.62mm pitch
  - 1-18 poles 10, 10.16mm pitch
  - Easily breakable to desired number of poles, end walls available on request
  - Moulded in grey UL94-V0 flame retardant PA
  - 0.5-1.5mm<sup>2</sup> (30-16AWG) solid & stranded cable
  - Guided pin alignment
  - Anti solder wicking
- Spacers in 2.5, 2.54, 5 & 5.08mm available
  - Full customisation, produced from 1 pole units which can be pre-assembled to individual requirements
  - Available without actuators (screwdriver operation) add suffix /W
  -  approved

SPECIFICATION	5mm, 5.08mm	7.5mm, 7.62mm	10mm, 10.16mm
Rating	10A/250	10A/500V	10A/630V
UL	10A/300V	10A/300V	10A/300V
VDE&IMQ	10A/250V	10A/750V	10A/750V
Dielectric strength	≥2kV	≥2.5kV	≥3kV
Impulse withstand voltage	4kV	6kV	6kV
Working temperature	110°C		
Moulding	UL94-V0 flame retardant PA		
Pin/terminal	Copper alloy, NI & SN		
Rising Clamp	Inox steel		
Recommended PCB hole	ø1.1mm		

### 5mm, 5.08mm Pitch

TYPE NO.	POLES	LENGTH
CSTBV1/1	1	6.5mm
CSTBV1/2	2	11.5mm
CSTBV1/3	3	16.5mm
CSTBV1/4	4	21.5mm
CSTBV1/5	5	26.5mm
CSTBV1/6	6	31.5mm
CSTBV1/7	7	36.5mm
CSTBV1/8	8	41.5mm
CSTBV1/9	9	46.5mm
CSTBV1/10	10	51.5mm
CSTBV1/11	11	56.5mm
CSTBV1/12	12	61.5mm
CSTBV1/36	36	181.5mm

### 5.08mm

TYPE NO.	POLES	LENGTH
CSTBV2/1	1	6.6mm
CSTBV2/2	2	11.7mm
CSTBV2/3	3	16.7mm
CSTBV2/4	4	21.8mm
CSTBV2/5	5	26.9mm
CSTBV2/6	6	32mm
CSTBV2/7	7	37.1mm
CSTBV2/8	8	42.1mm
CSTBV2/9	9	47.2mm
CSTBV2/10	10	52.3mm
CSTBV2/11	11	57.4mm
CSTBV2/12	12	62.5mm
CSTBV2/36	36	184.4mm



CSTBV1

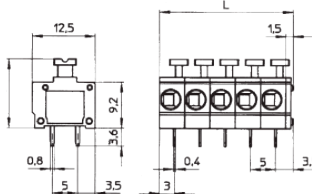

CSTBV2

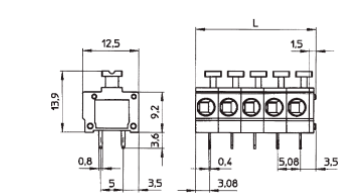

### 7.5mm, 7.62mm Pitch

TYPE NO.	POLES	LENGTH
CSTBV3/2	2	14mm
CSTBV3/3	3	21.5mm
CSTBV3/4	4	29mm
CSTBV3/5	5	36.5mm
CSTBV3/6	6	44mm
CSTBV3/7	7	51.5mm
CSTBV3/8	8	59mm
CSTBV3/9	9	66.5mm
CSTBV3/10	10	74.5mm
CSTBV3/11	11	81.5mm
CSTBV3/12	12	89mm
CSTBV3/24	24	179mm

### 7.62mm

TYPE NO.	POLES	LENGTH
CSTBV4/2	2	14.2mm
CSTBV4/3	3	21.8mm
CSTBV4/4	4	29.5mm
CSTBV4/5	5	37.1mm
CSTBV4/6	6	44.7mm
CSTBV4/7	7	52.3mm
CSTBV4/8	8	59.9mm
CSTBV4/9	9	67.5mm
CSTBV4/10	10	75.2mm
CSTBV4/11	11	82.8mm
CSTBV4/12	12	90.4mm
CSTBV4/24	24	181.8mm



CSTBV3

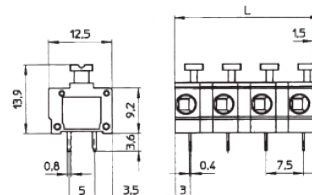

CSTBV4

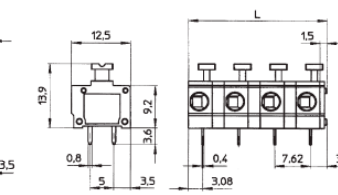

### 10mm, 10.16mm Pitch

TYPE NO.	POLES	LENGTH
CSTBV5/2	2	16.5mm
CSTBV5/3	3	26.5mm
CSTBV5/4	4	36.5mm
CSTBV5/5	5	46.5mm
CSTBV5/6	6	56.5mm
CSTBV5/12	12	116.50
CSTBV5/18	18	176.50

### 10.16mm

TYPE NO.	POLES	LENGTH
CSTBV6/2	2	16.7mm
CSTBV6/3	3	26.9mm
CSTBV6/4	4	37.1mm
CSTBV6/5	5	47.2mm
CSTBV6/6	6	57.4mm
CSTBV6/12	12	118.3mm
CSTBV6/18	18	179.3mm



CSTBV5

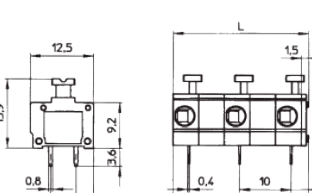

CSTBV6

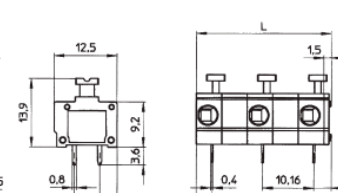

For without actuators, add suffix /W

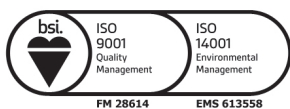

+44 (0)1638 716101  
info@camdenboss.com  
www.camdenboss.com

We operate a constant improvement policy, our products are subject to change without notice.

Ver 1.1  
Iss 1



- PCB TERMINAL BLOCKS
- INTER-CONNECTION
- FUSES & FUSE-HOLDERS
- LEDs & INDICATORS
- MINIATURE SWITCHES
- LIMIT & SAFETY SWITCHES
- CONTROL PRODUCTS
- INTERFACE MODULES & SUPPORTS
- RELAY BASES
- ENCLOSURES
- BATTERIES
- TRANSFORMERS