

12X

BLU-RAY COMBO

BC-12D2HT



ASUS BC-12D2HT is a powerful and energy-saving Blu-ray disc drive capable of reading from 12X BD format and writing to 16X DVD±R format. With M-DISC Support, users can store their precious memories for millennium. For data protection, BC-12D2HT integrates password controls and encryption plus encoded file name functionality, ensuring information and documents are extra-safe.

FEATURES

Disc Encryption
Double Security On-the-Go

NERO BackItUp*
Full Backup for Your Android Devices

BDXL Support
Up to 128 GB Storage on one Disc

M-DISC Support
1000-year Storage Solution

* Only available on retail box version



SPECIFICATIONS

Read Speed

BD-R(SL): 12X
BD-R(SL, M-DISC): 12X
BD-R(DL): 8X
BD-R(LTH/TL/QL): 6X
BD-RE(SL): 8X
BD-RE(DL): 6X
BD-RE(TL): 4X
BD-ROM(SL): 12X
BD-ROM(DL): 8X
DVD+R(SL): 16X
DVD+R(SL, M-DISC): 12X
DVD-R(SL): 16X
DVD±RW: 12X
DVD-ROM(SL): 16X
DVD±R(DL): 12X
DVD-ROM(DL): 12X
DVD-RAM: 5X
CD-R/ROM: 48X
CD-RW: 40X
BDMV Playback: 6X
DVD Video Playback: 6X
VCD Playback: 10X
Audio CD Playback: 10X

Write Speed

DVD±R(SL): 16X
DVD+R(SL, M-DISC): 4X
DVD±RW: 8X
DVD-RW: 6X
DVD±R(DL): 8X
DVD-RAM: 5X
CD-R: 48X
CD-RW: 24X

Access Time(1/3 Stroke)

BD-ROM: 180 ms
DVD-ROM: 160 ms
DVD-RAM: 180 ms
CD-ROM: 150 ms

O/S Compatibility

Windows[®] 10
Windows[®] 8
Windows[®] 7
Windows Vista[®]
Windows[®] XP

System Requirement

CPU: Intel[®] Pentium[®] D 945(3.4 GHz) or higher
RAM: 1 GB or more is recommended
HDD: 10 GB or more
Graphics Card: NVIDIA[®] GeForce 7600GT or ATI X1600 series and above
Use HDCP Compatible display and VGA card to High Definition digital output

Disc Formats

Reading:	Writing:
BD-R(SL/DL/TL/QL)	DVD±R(SL/DL)
BD-RE(SL/DL/TL)	DVD±RW
BD-ROM(SL/DL)	DVD-RAM
DVD±R(SL/DL)	CD-R
DVD±RW	CD-RW
DVD-ROM(SL/DL)	
DVD-RAM	
DVD Video	
CD-R	
CD-RW	
CD-ROM	
Audio CD	
VCD	
CD-I	
CD-Extra	
Photo CD	
CD-text	
CD-ROM/XA	
Multi-session CD	

Configurations

Mounting Orientation

Vertical and Horizontal
(+12° ~ -12°)

Dimensions

42 x 146 x 170 mm(H/W/D)

Weight

680 g

Interface

SATA

Disc Diameters

12 cm and 8 cm

Electrical and Environmental Specifications

Power Requirement

DC +5V ± 2.5%
DC +12V ± 3%

Temperature

Operating: 5°C to 45°C
Storage: -40°C to 60°C

Humidity

Operating: 15%~80%
(Non-condensing)
Storage: 15%~90%
(Non-condensing)

PACKAGE CONTENTS

- CyberLink Power2Go 8
- CyberLink PowerBackup 2.5
- E-Green



DISC ENCRYPTION *Double Security On-the-Go*

Password control access and hidden-file folder function.

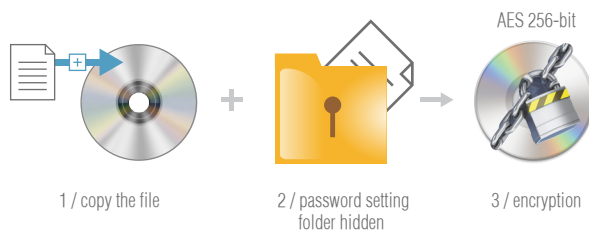

M-DISC SUPPORT *1000-year Storage Solution*

Save your priceless memories or data for up to 1,000 years.

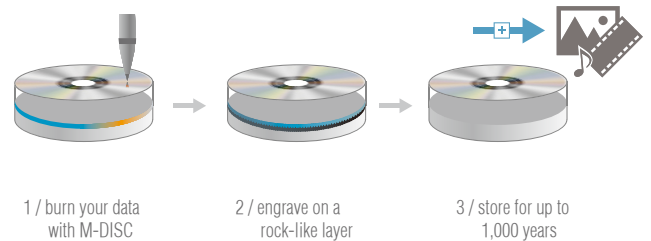

NERO BACKITUP FOR ANDROID* *Full Backup for Your Android Devices*

Free included app makes it easy to back up all of your important data to the hard drive or SD card on the PC wirelessly.

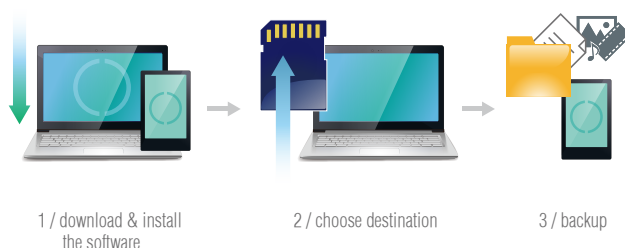

BDXL™ SUPPORT *Maximum Data Storage*

Up to 128 GB data storage on one disc.



* Only available on retail box version