

multicomp PRO



**4 in 1 Rework Soldering Station
Model: MP740029**

Please read these instructions carefully before use and retain for future reference.

IMPORTANT SAFETY INFORMATION

When using electrical appliances basic safety precautions should always be followed.

- Check that the voltage indicated on the rating plate corresponds with that of the local network before connecting the appliance to the mains power supply.
- This appliance can be used by children aged from 8 years and above and persons with reduced physical, sensory or mental capabilities or lack of experience and knowledge if they have been given supervision or instruction concerning use of the appliance in a safe way and understand the hazards involved.
- Do not leave the soldering station unattended, while it is powered on.
- Never touch the soldering tip or the surrounding metallic parts before the soldering tip has cooled down completely.
- Do not use the product near flammable items.
- Turn the power off when this product is not in use.
- The soldering iron must be placed on its stand when not in use.
- Before storage, turn the power off and allow the product to cool down to room temperature.
- Do not use this product for anything else other than that for which it is designed.
- Children should be supervised to ensure that they do not play with the appliance.
- Do not use this appliance with wet hands.
- Do not expose the soldering station to rain or moisture.
- Ensure there is sufficient space and ventilation around the appliance to allow the escape of heat and/or fumes.
- This appliance must be earthed.

WHAT'S INCLUDED?

- Control Station
- Soldering Pen
- Hot Air Gun
- Desoldering Gun
- Suction Pen
- Soldering Tweezers
- Mains Lead
- 2 x Tool Stands with tip cleaners
- Hot Air Gun support and screws
- Mains Lead
- User Manual

OVERVIEW

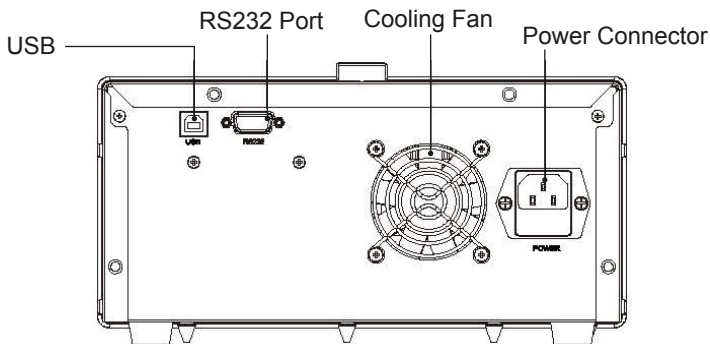

Rear Casing Layout

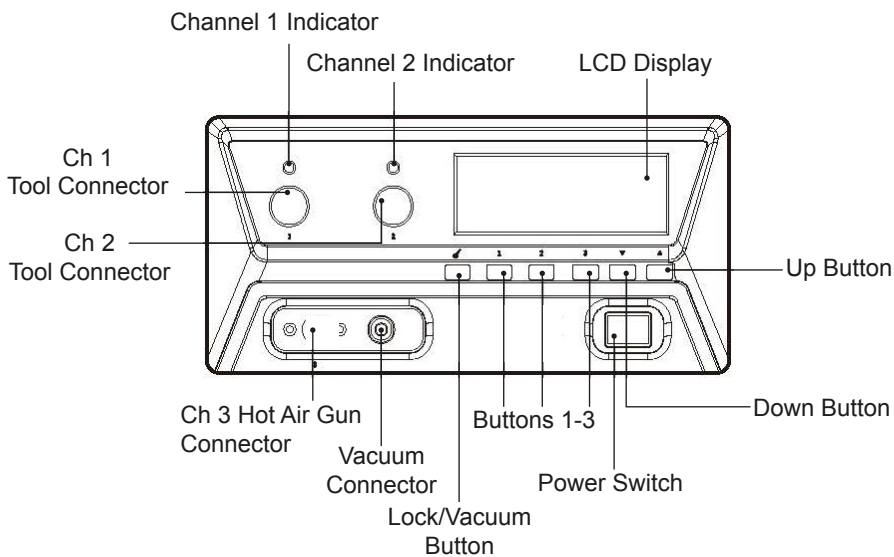

Front Panel Layout

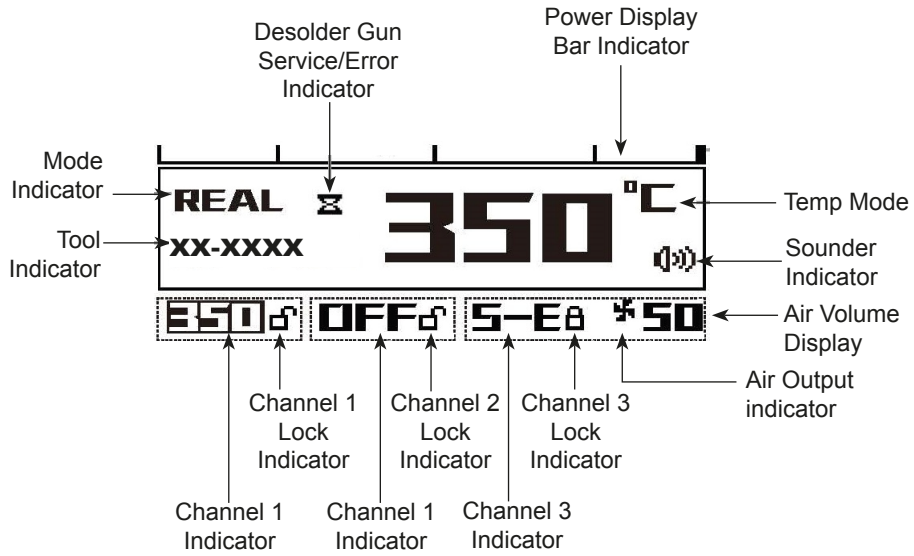

LCD Indicator Display

INSTALLATION

- Channels 1 and 2 can be used for either the Soldering Iron, Tweezers or Desoldering Gun to suit user preference.
- Channel 3 is for the Hot Air tool only.
- Attach the hot air gun support bracket to the side of the control station using the screws supplied.
- Assemble the vacuum pen as follows:
- Insert the end of the suction nozzle into the hole in the suction disc.
- Connect the nozzle assembly to the vacuum pen to complete the assembly.

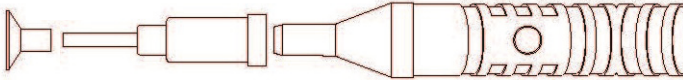

OPERATION

Note: The first time you use the soldering iron, it may smoke slightly as the heating element dries out. This is normal and should only last for a few minutes.

ONLY USE FOR ELECTRICAL WORK - Acidic solder will damage the iron tip.

- Long press button 1, 2 or 3 to turn channel the relevant channel on or off.
- The required temperature is displayed in the lower segment of the LCD for each channel when the channel is turned on.
- Short press either button 1, 2 or 3 to select the channel to make it active to make adjustments to the settings.
- The lower channel display on the LCD shows inverted to indicate which channel is currently active.
- The actual tip temperature for the active channel is displayed in large numerics on the LCD.
- The system detects which tool you have connected to the active channel and it's identification is displayed on the LH side of the LCD. If no tool is connected to that channel NO TOOL is displayed and the channel cannot be activated.
- Channel 3 is used for the hot air gun tool only and has additional displays to indicate when the air fan is on and the airflow rate.

Temperature Adjustment

- Select the channel you require to make adjustment to by pressing either buttons 1, 2 or 3.
- The power bar display at the top of the LCD shows the output power status for the chosen channel.
- Press UP or DOWN buttons to increase or decrease the required temperature.
- REAL is displayed on the LH side of the LCD and the large numerics indicate the current tip temperature.
- To lock the channel so setting cannot be changed press and hold the LOCK/ VACUUM button until the padlock display indicator changes mode.

Temperature Mode

- To switch between Celsius or Fahrenheit display, press and hold the LOCK/VACUUM button when powering on the station.
- The mode is displayed on the RH side of the LCD.
- The previously used setting is retained on subsequent use.

Hot Air Tool Adjustment (Channel 3 only)

- Long press to turn on channel 3.
- Press button 3 to activate and make adjustments to the temperature or air flow rate.
- Press button 1 to select temperature adjustment mode then use the UP or DOWN buttons to adjust the required temperature.
- Press button 2 to select the fan mode then use the UP or DOWN buttons to adjust the required air flow rate.
- To lock the channel so settings cannot be changed press and hold the LOCK/VACUUM button until the padlock display changes mode.

Key Beep Function

- To switch the key sound feature on or off press and hold the UP and DOWN buttons while powering on the station.
- The speaker symbol displays on the RH side of the LCD when the feature is active.
- The previously used setting is retained on subsequent use.

Desoldering Gun Maintenance

- If the desoldering gun requires maintenance the symbol  displays. The waste collector needs emptying.

Removing solder waste:

The collector tube must be emptied of solder waste as required or the efficiency of operation will be impaired.

- Switch off the mains power and allow the desoldering gun to cool fully.

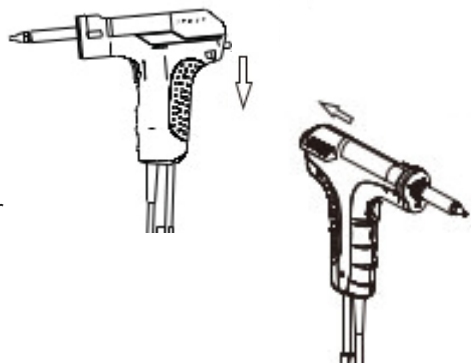

- Press the latch down on the rear of the gun and slide the rear cover clear from the collection tube.

- Lift out the collector tube while retaining the spring and rubber plug.

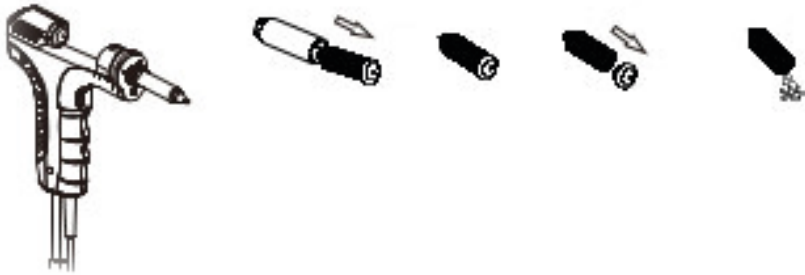

- Remove the spring and separate the rubber plug and empty the collected solder waste.
- Replace the spring and the rubber plug. Replace the collection tube into the recess in the desoldering gun.

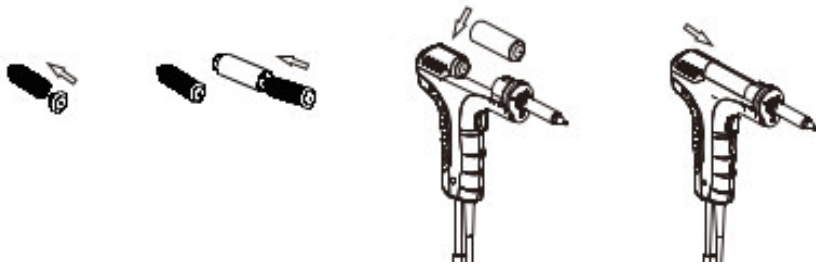

- Press on the end of the rear cover and slide it back into position. The latch will return to the locked position.

CALIBRATION

- Switch to the channel you wish to calibrate with the required tool connected and placed in the holder with a temperature measurement meter set up appropriately.
- Press and hold the LOCK/VACUUM button and Button 1 for 3 seconds to enter calibration mode.
- With a temperature set (e.g. 350°C), measure the actual tool tip then having calculated the difference between the actual temperature and the displayed temperature, use the UP or DOWN buttons to enter the value.
(e.g. actual tip temp 350°C and display showing 335°C, enter a value of 15)
- Press Button 1 to store the setting for that channel and tool.
- The station will then enter sleep timer mode setting and if you do not wish to alter the sleep default time (zero) then press Button 1 again to exit.
- The method is the same for all channels.



Sleep Mode

- Switch to the channel you wish to change.

Note: Only Channels 1 and 2 can have a sleep setting.

- To switch the sleep duration from the factory default of no sleep, then enter the calibration mode by press and holding the LOCK/VACUUM button and Button 1 for 3 seconds.
- Do not enter any calibration value and press Button 1 to enter sleep setting mode.
- SLP and the tool identifier connected to the channel chosen will display on the LH side of the LCD.
- Press UP or DOWN buttons to increase or decrease the time (in minutes) before that channel will enter sleep mode.

Note: Sleep default temperature is set to 200°C so when the working temperature is greater it will reduce to 200°C, but if the working temperature is less it will remain at the working temperature.

- Press Button 1 to resume from sleep mode.
- The method is the same for either channel.

CLEANING

- Cleaning should only be done when the iron is switched off and at room temperature.
- The irons and station case may be cleaned with a damp cloth and a small amount of liquid detergent if necessary.
- Never submerge the soldering irons in liquid or allow any liquid to enter the station casing.
- Do not use any chemicals, abrasives or solvents that could damage the soldering irons or station casing.

TROUBLESHOOTING

- If the symbol  displays, the tool attached to the channel currently active is failing to reach the required temperature. The tool heater element may have failed and requires replacement, or replace the complete tool.

SPECIFICATIONS

Tool Model	Soldering Pen	Soldering Tweezers	Desoldering Gun	Hot Air Tool
Rated Voltage	24V	12V	24V	As Input
Heating Power	130W	100W	150W heating/ 15W vacuum	550W heating/ 25W vacuum
Temperature Range	150-500°C	150-500°C	300-500°C	150-500°C
Temp Stability	±5°C	±2°C	±2°C	±2°C
Air Flow	-	-	-	5-23 litres/min
Heater Core	Integrated Element			
Temperature Sensor	Thermocouple			

Mains Power	230V~50Hz
Power	900W Max
Sleep Mode Temp	200°C
Sleep Mode Timer	1-120minutes (default 0)
Temperature Compensation Range	-50°C - +50°C
Tip to Ground Impedance	<2 ohms
Tip to Ground Voltage	<2 mV
Working Environment	0°C ~ 40°C RH <80%
Storage Environment	-20°C ~ 80°C RH <80%
Dimensions (L x W x H)	310 x 309 x 146mm (inc hot air gun holder)
Weight	8270g (all included)



INFORMATION ON WASTE DISPOSAL FOR CONSUMERS OF ELECTRICAL & ELECTRONIC EQUIPMENT.

When this product has reached the end of its life it must be treated as Waste Electrical & Electronics Equipment (WEEE). Any WEEE marked products must not be mixed with general household waste, but kept separate for the treatment, recovery and recycling of the materials used. Contact your local authority for details of recycling schemes in your area.



Made in China. LS12 2QQ

Man Rev 1.1