

**PLEASE CHECK WWW.MOLEX.COM FOR LATEST PART INFORMATION**

**Part Number:** [0747260001](#)  
**Status:** **Active**  
**Overview:** SFP+ and SFP Interconnect Solutions  
**Description:** SFP Cage Lightpipe Cover Assembly, 1-by-1, Rear Mount

**Documents:**

[Drawing \(PDF\)](#) [RoHS Certificate of Compliance \(PDF\)](#)  
[Packaging Specification 747260001-PK \(PDF\)](#)

**General**

Product Family	EMI Cages
Series	<a href="#">74726</a>
Application	N/A
Comments	Rear mount lightpipe location, Rear mount lightpipe location
Component Type	Lightpipe
Overview	<a href="#">SFP+ and SFP Interconnect Solutions</a>
Product Name	SFP
UPC	822348616657

**Physical**

EMI Panel / Bezel Mount	N/A
Light Pipes per Port	N/A
Material - Metal	N/A
Net Weight	0.300/g
Orientation	Horizontal
Packaging Type	Tray
Port Configuration	1x1
Rear Legs	0
Termination Interface: Style	N/A
Thermal Height	N/A
Thermal Solutions	N/A

**Solder Process Data**

Lead-freeProcess Capability	N/A
Process Temperature max. C	070

**Material Info**

**Reference - Drawing Numbers**

Packaging Specification	747260001-PK
-------------------------	--------------

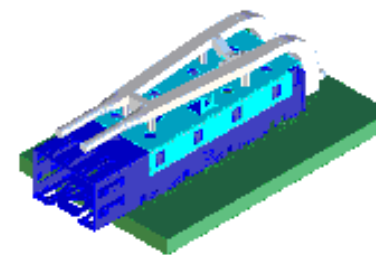

*Series image - Reference only*

**EU ELV**

**Compliant**

**EU RoHS**

**Compliant**

**REACH SVHC**

Not Contained Per  
-ED/88/2018 (15  
January 2019)

**Halogen-Free**

**Status**

**Not Low-Halogen**

For more information, please visit [Contact US](#)

China ROHS

ELV

RoHS Phthalates

**China RoHS**

Green Image

Compliant

Not Contained

**Search Parts in this Series**

[74726 Series](#)

**Use With**

[74737](#)