



Hardware for Plastic and Metal Shell "D" Connectors 9-37 Position

Product Description

Screw sets and mounting accessories are available for all Thomas & Betts "D" Connectors, facilitating any type of installation (e.g. front panel mounting, coupling, combination of Thomas & Betts "D" Connectors and standard "D" connectors employing other connection techniques).

Dimensions shown are for reference only.
Dimensions are in millimeters (inches)

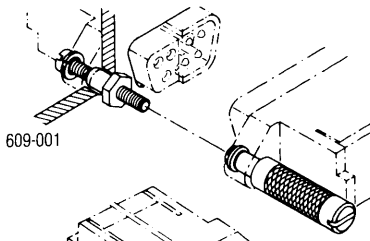
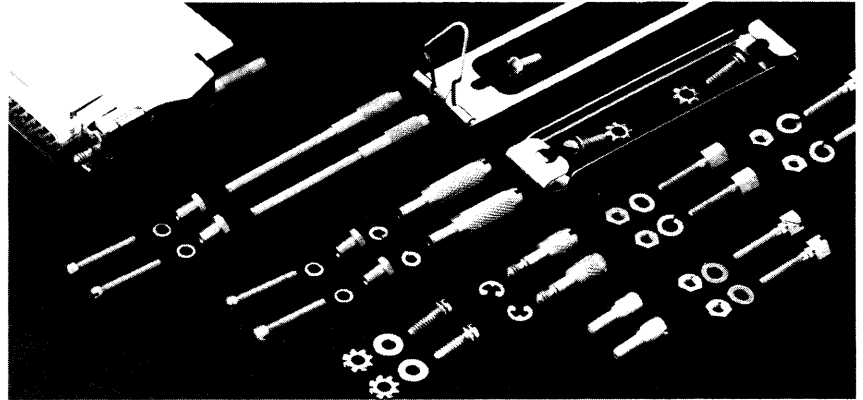

609-001



609-002

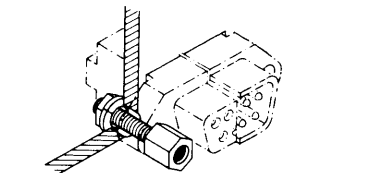

609-003

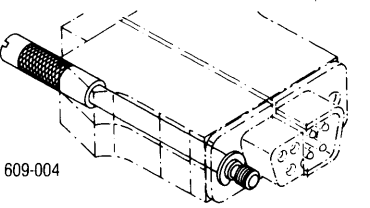

609-004

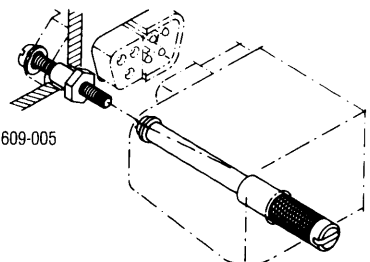

609-005

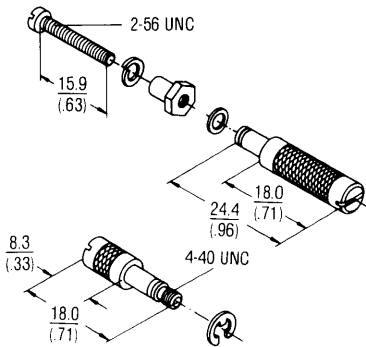

CAN BE USED WITH:
609-003
609-006-1
609-007-1

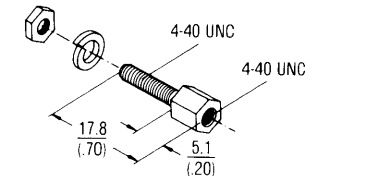

CAN BE USED WITH:
609-002
609-004

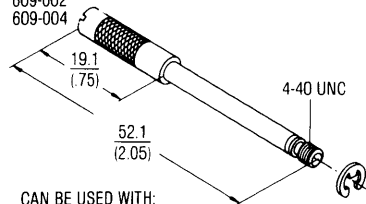

CAN BE USED WITH:
609-003
609-006-1
609-007-1

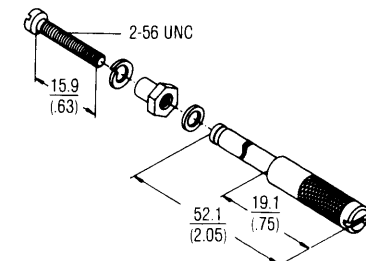

609-001

Screwlock Assembly
 • locks a plastic or metal shell "D" connector to another rear panel mounted plastic or metal shell "D" connector

Panel thickness 3.2 (.13) mm max.
Use 779-6211 retaining ring installation tool

609-002

Jackscrew Assembly
 • locks a plastic or metal shell "D" connector to a jacksocket

Use 779-6210 retaining ring installation tool

609-003

Jacksocket Assembly
 • locks a plastic or metal shell "D" connector with a jackscrew to any other front panel mounted "D" connector

Panel thickness 5.0 (.196) mm max.

609-004

Jackscrew Assembly
 • locks plastic "D" connectors with backshells or metal "D" connectors with backshells with a jackscrew assembly to any "D" connector

Use 779-6210 retaining ring installation tool

609-005

Backshell Screwlock Assembly
 • locks plastic "D" connector to another rear panel mounted plastic "D" connector with backshell

Panel thickness 3.2 (.13) mm max.
Use 779-6211 retaining ring installation tool

Hardware for Plastic and Metal Shell "D" Connectors 50 Position

Dimensions shown are for reference only.
Dimensions are in millimeters.
(inches)

609-006-1
609-007-1

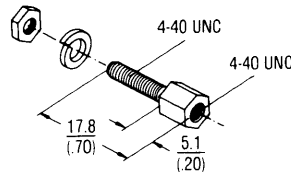
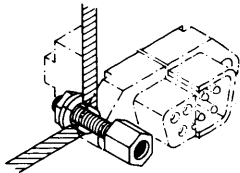

CAN BE USED WITH:
609-002
609-004

609-006-1 1.3 (.05)
609-007-1 2.2 (.09)

Application for 50 position "D" connectors

609-008-50

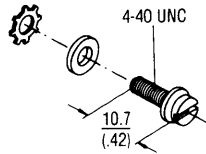
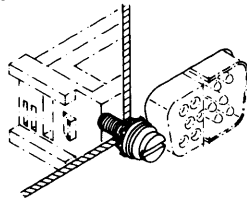

CAN BE USED WITH:
609-50SL

609-009-50

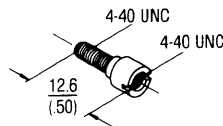
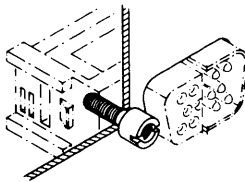

CAN BE USED WITH:
4-40 UNC
Jackscrews

609-50 BL

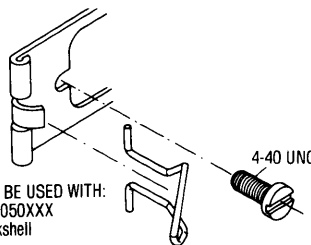
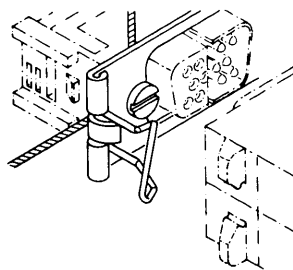

CAN BE USED WITH:
609-050XXX
Backshell

609-50 SL

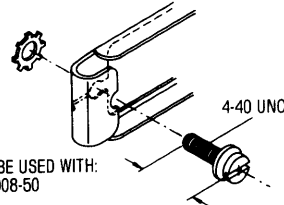
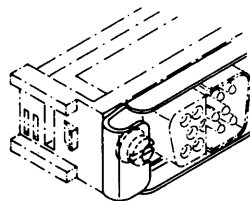

CAN BE USED WITH:
609-008-50

609-002

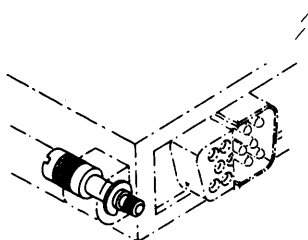

CAN BE USED WITH:
609-006-1
609-007-1

609-006-1

Jackscrew Assembly

- for plastic "D" connector and metal (622) "D" connector
 - connects rear panel mounted "D" connector through jackscrew assembly to any "D" connector
- Panel thickness 1.6 (.06) mm max.

609-007-1

Jackscrew Assembly

- similar to 622-003, but for
- Panel thickness 2.4 (.09) to 3.2 (.13) mm max.

609-008-50

Slide Lock Post

- locks 50 position "D" connector (with or without rear panel mounting) through slide lock retainer to any 50 position "D" connector
- Panel thickness 2.4 (.09) mm max.

609-009-50

Jackscrew Assembly

- locks rear panel mounted 50 position "D" connector through a jackscrew assembly to discrete wire 50 position "D" connector
- Panel thickness 1.6 (.06) mm max.

609-50 BL

Bail Lock Assembly

- locks rear panel mounted 50 position "D" connector through backshell with bail mount ears for bail lock assembly 622-050XXX to any 50 position "D" connector
- Panel thickness 1.6 (.06) mm max.

609-50 SL

Slide Lock Retainer

- locks 50 position "D" connector through slide lock post to any 50 position "D" connector with or without rear panel mounting

609-002

Jackscrew Assembly

- retains 50 position "D" connectors with backshell for IPI-compatible interfaces through jackscrew assembly
- Use 779-6210 retaining ring installation tool