

## Fixing frame - EV-T2SF-EM - 1627637

Please be informed that the data shown in this PDF Document is generated from our Online Catalog. Please find the complete data in the user's documentation. Our General Terms of Use for Downloads are valid (<http://phoenixcontact.com/download>)



Fixing frame for Infrastructure Socket Outlet, Type 2, IEC 62196-2, Front mounting, screwed on the front, Front protective cover screw connection

### Product Description

Fixing frame for Infrastructure Socket Outlet

### Your advantages

- ✓ Certified in accordance with IATF 16949:2016 and ISO 9001:2015



### Key Commercial Data

Packing unit	1 pc
GTIN	 4 055626 346106
GTIN	4055626346106
Weight per Piece (excluding packing)	38.900 g
Custom tariff number	39269097
Country of origin	Germany

### Technical data

#### Product definition

Product type	Fixing frame for Infrastructure Socket Outlet
Type	Front protective cover screw connection
Standards/regulations	IEC 62196-2
Charging standard	Type 2
Charging mode	Mode 3, Case B

#### Dimensions

Height	77.4 mm
Width	77.2 mm
Depth	11.5 mm
Bore dimensions	60 mm x 60 mm

## Fixing frame - EV-T2SF-EM - 1627637

### Technical data

#### Ambient conditions

Ambient temperature (operation)	-30 °C ... 50 °C
Ambient temperature (storage/transport)	-40 °C ... 80 °C

#### Mounting

Possible mounting positions	Front mounting, screwed on the front
Mounting hole diameter	< 7.00 mm (Elongated hole, for spacing see hole pattern)
Screws included in the scope of delivery	M5x20 cylinder head screws

#### Design

Design line	Easy Mount
Housing color	black
Customer variations	On request

#### Material

Material	Plastic
----------	---------

#### Environmental Product Compliance

China RoHS	Environmentally friendly use period: unlimited = EFUP-e
	No hazardous substances above threshold values

### Drawings

# Fixing frame - EV-T2SF-EM - 1627637

Dimensional drawing

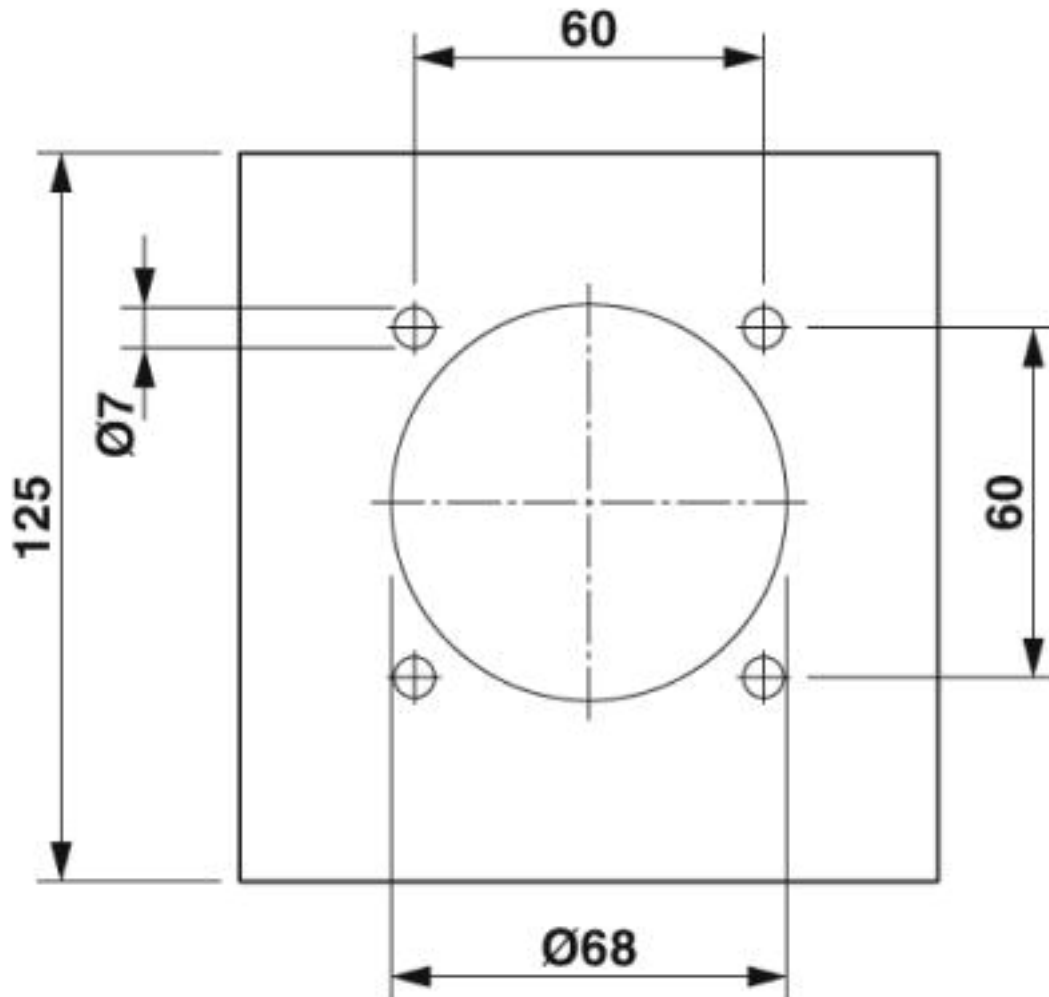

Hole image

# Fixing frame - EV-T2SF-EM - 1627637

Dimensional drawing

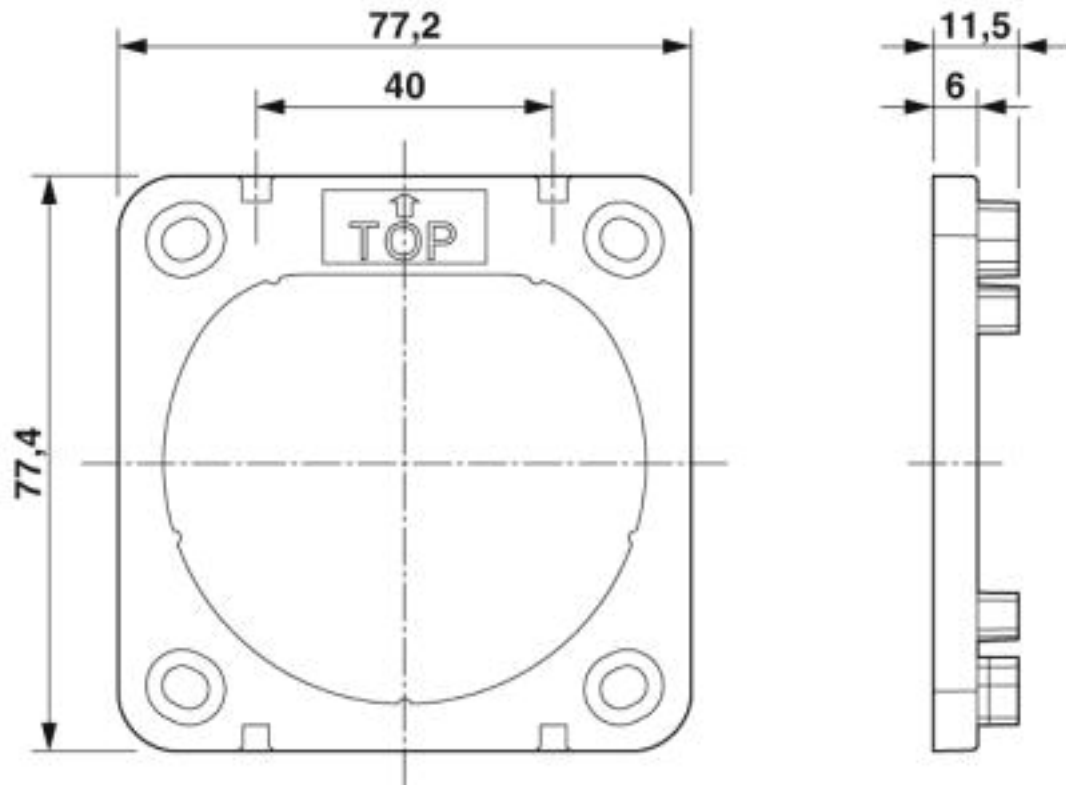

Dimensional drawing

## Fixing frame - EV-T2SF-EM - 1627637

Schematic diagram

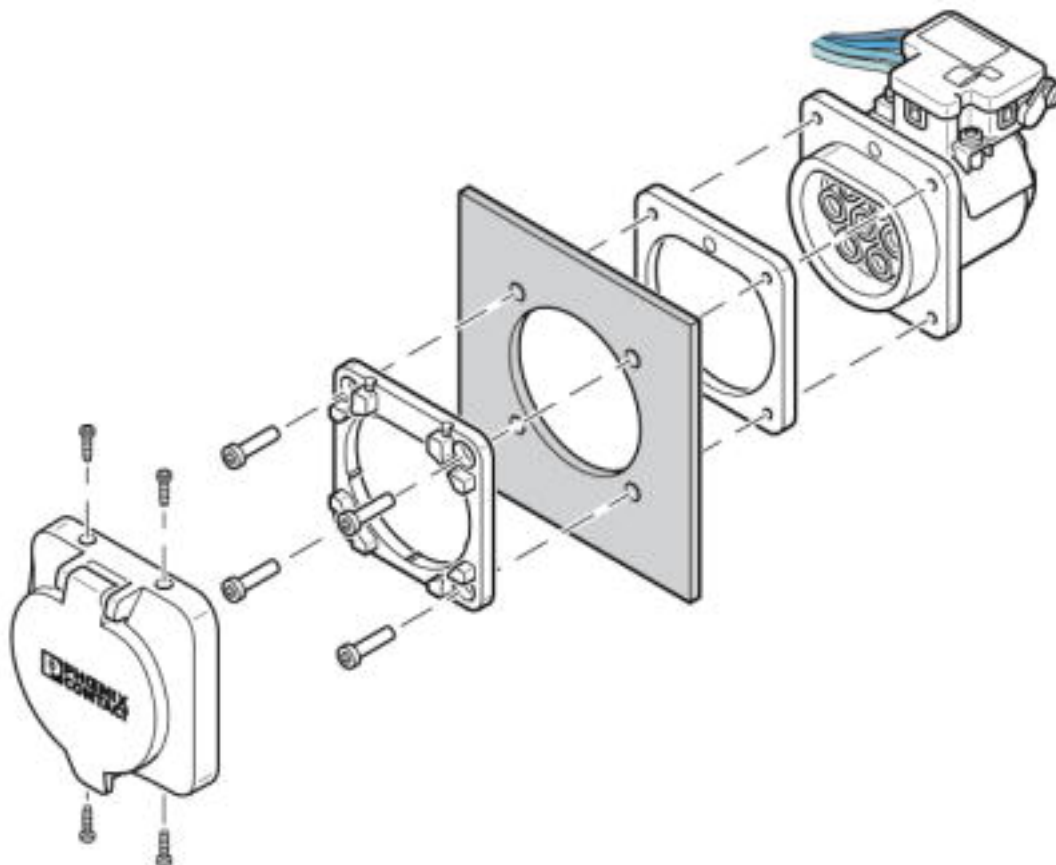

### Rear mounting with front protective cover screw connection

The screw connection for a protective cover (EV-T2SC-EM) from the accessories range only supports front mounting with a corresponding fixing frame (EV-T2SF-EM). The panel thickness must not exceed 5 mm. The sealing frame that is slid on from the rear must contact the housing panel flush with the flat side and must completely surround the infrastructure socket outlet.

## Classifications

### eCl@ss

eCl@ss 10.0.1	27144792
eCl@ss 4.0	272607xx
eCl@ss 4.1	27260701
eCl@ss 5.0	27260701
eCl@ss 5.1	27059110
eCl@ss 6.0	27261200
eCl@ss 7.0	27440208
eCl@ss 8.0	27440208
eCl@ss 9.0	27144792

### ETIM

ETIM 2.0	EC000241
----------	----------

# Fixing frame - EV-T2SF-EM - 1627637

## Classifications

### ETIM

ETIM 3.0	EC002061
ETIM 4.0	EC002061
ETIM 5.0	EC002314
ETIM 6.0	EC002884
ETIM 7.0	EC002884

### UNSPSC

UNSPSC 6.01	30211923
UNSPSC 7.0901	39121522
UNSPSC 11	39121522
UNSPSC 12.01	39121522
UNSPSC 13.2	39121522
UNSPSC 18.0	39121522
UNSPSC 19.0	39121522
UNSPSC 20.0	39121522
UNSPSC 21.0	39121522

## Accessories

### Accessories

#### Infrastructure socket outlet

Socket Outlet - EV-T2M3SE12-3AC32A-0,7M6,0E14 - 1627693



Infrastructure Socket Outlet for charging electric vehicles with alternating current (AC), compatible with Infrastructure Plugs, Type 2, IEC 62196-2, 32 A / 480 V (AC), 12 V Locking actuator, Single wires, length: 0.7 m, Rear panel mounting, Front protective cover screw connection, Optimized insertion and withdrawal forces

Socket Outlet - EV-T2M3SE12-3AC32A-0,7M6,0E12 - 1627633



Infrastructure Socket Outlet for charging electric vehicles with alternating current (AC), compatible with Infrastructure Plugs, Type 2, IEC 62196-2, 32 A / 480 V (AC), 12 V Locking actuator, Single wires, length: 0.7 m, Rear panel mounting, Front protective cover screw connection

#### Protective cover for Socket Outlet

## Fixing frame - EV-T2SF-EM - 1627637

### Accessories

Protective covers - EV-T2SC-EM - 1627635



Self-closing protective cover for infrastructure socket outlet, Type 2, IEC 62196-2, Front mounting, screwed on the front, Front protective cover screw connection, With imprinted Phoenix Contact logo