

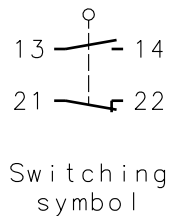

Positive opening operation according to DIN EN 60947-5-1 IEC 60947-5-1

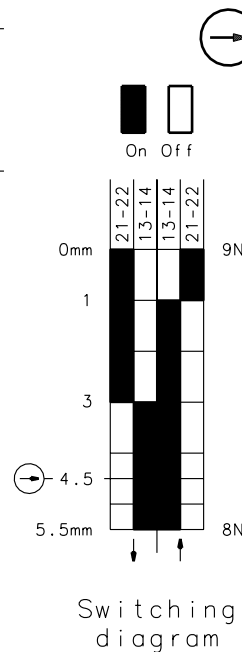
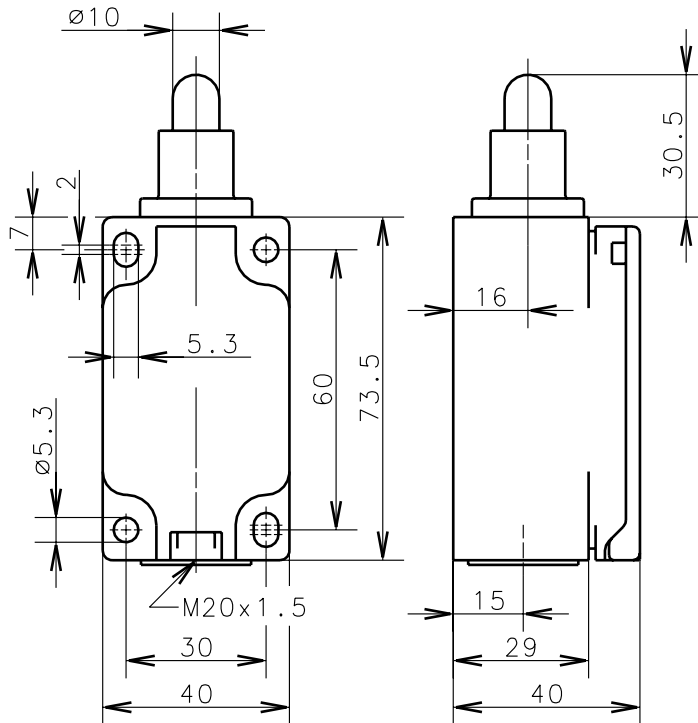

Tolerance: Operating point ±0.25mm; actuating force ±10%

**Mechanical features**

 Enclosure: Thermoplast, glass fiber reinforced  
 Cover: Thermoplast, glass fiber reinforced  
 Actuator: Push bolt (St)

 Ambient air temperature: -30°C up to +80°C  
 Contact type: 1 NC-contact - 1 NO-contact (Zb)

 Mechanical life: 10x10<sup>6</sup> switch operations  
 Switch frequency: max. 100/min  
 Mounting: 4 x M5  
 Connection type: 4 screw connections (M3.5)  
 Conductor cross-section: single core 0.5-1.5mm<sup>2</sup>/litz wire connector sleeve 0.5-1.5 mm<sup>2</sup>  
 Cable entry size: 1 x M20x1.5  
 Weight: approx. 0,15kg

**Electrical features**

 Rated insulation voltage: U<sub>i</sub> = 500 V AC  
 Conventional thermal current: I<sub>the</sub> = 10A  
 Max. inrush current: according to IEC 60947-5-1, AC 15, A300  
 Utilization categorie: AC 15, A300, U<sub>e</sub>/I<sub>e</sub> 240V/3A  
 Standards: according to EN 60947-1; EN 60947-5-1  
 Protection class (IP-Code): IP65 according to EN 60529, DIN VDE 0470 T1  
 CSA: 10A 300V AC, A300 (same polarity)  
 Short-circuit protection: Fuse 2A gL/gG, IEC/EN 60947-5-1, appendix K

**Approach possibilities**

The push bolt actuator is mainly intended to be actuated along it's axis. Side actuation will considerably reduce switch life.

**Remarks**

 The moving parts should be oiled periodically.  
 The rated protection class (IP-Code) is valid only at closed cover and when using an it least equivalent cabel gland.