

Air Ultrasonic Ceramic Transducers

400EP14D

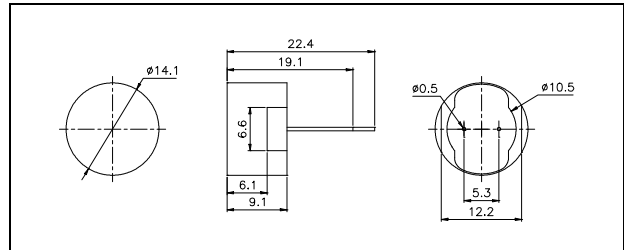

Dimensions: dimensions are in mm



Asymmetric Beam Patterns

Specification

400EP14D	Transceiver
Center Frequency	40.0±1.0Khz
Bandwidth (-6dB)	1.5Khz
Transmitting Sound Pressure Level	103dB min.
at resonant frequency; 0dB re 0.0002μbar per 10Vrms at 30cm	
Receiving Sensitivity	-78dB min.
at resonant frequency 0dB = 1 volt/μbar	
Nominal Impedance (Ohm)	1000
Ringing (ms)	1.2 max.
Capacitance at 1KHz ±20%	1250 pF
Max. Driving Voltage (cont.)	20Vrms
2% Duty (Bursts)	100Vpp
Total Beam Angle Wide	125° typ.
-6dB Narrow	65° typ.
Operation Temperature	-30 to 80°C
Storage Temperature	-40 to 85°C

All specification taken typical at 25°C
Both lead pins and lead wires output are available

Models available:

1	400EP14D	Black Al. Housing
2	400EP14D0	Natural Al. Housing

Impedance/Phase Angle vs. Frequency

Tested under 1Vrms Oscillation Level

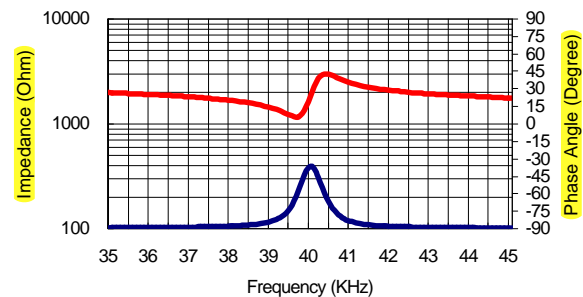

Sensitivity/Sound Pressure Level

Tested under 10Vrms @30cm

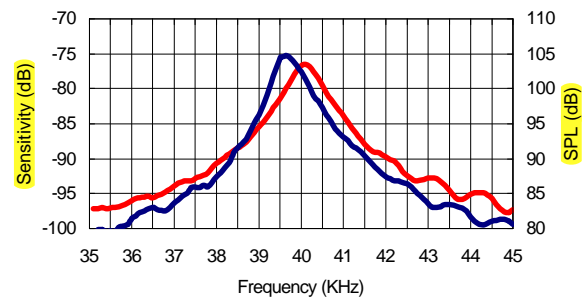

Beam Angle: Tested at 40.0Khz frequency

Wide Angle _____ Narrow Angle _____

