

**Connecting elements**  
**H35,0/30 BE**

**Weidmüller Interface GmbH & Co. KG**  
Klingenbergstraße 26  
D-32758 Detmold  
Germany  
Fon: +49 5231 14-0  
Fax: +49 5231 14-292083  
www.weidmueller.com

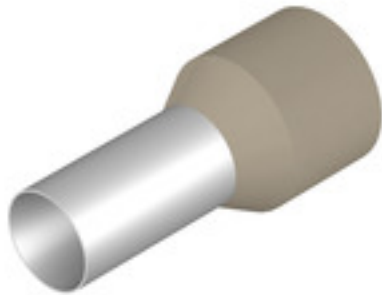

- supplied loose in poly-bag
- Weidmüller colour code
- DIN colour code

**General ordering data**

Type	H35,0/30 BE
Order No.	<a href="#">0317200000</a>
Version	Wire-end ferrule, insulated, 19 mm, 16 mm, beige
GTIN (EAN)	4008 190023904
Qty.	50 pc(s).
Packaging	loose

Creation date September 7, 2020 10:34:20 AM CEST

Catalogue status 05.09.2020 / We reserve the right to make technical changes.

**Data sheet**

**Connecting elements  
H35,0/30 BE**

**Weidmüller Interface GmbH & Co. KG**  
 Klingenbergstraße 26  
 D-32758 Detmold  
 Germany  
 Fon: +49 5231 14-0  
 Fax: +49 5231 14-292083  
 www.weidmueller.com

**Technical data**

**Dimensions and weights**

Net weight 1.18 g

**Technical data**

Version insulated

**Wire-end ferrules**

Collar diameter (D2)	12.7 mm	Colour code	Weidmüller
Conductor cross-section	35 mm <sup>2</sup>	Contact surface diameter (D1)	8.3 mm
Contact surface length (L2)	16 mm	L1 in mm	30 mm
Metal sleeve thickness (S1)	0.2 mm	Plastic collar thickness (S2)	0.4 mm
Stripping length	19 mm	Wire connection cross section AWG, max.	AWG 2

**Classifications**

ETIM 6.0	EC000005	ETIM 7.0	EC000005
eClass 9.0	27-40-02-01	eClass 9.1	27-40-02-01
eClass 10.0	27-40-02-01	UNSPSC	31-16-31-02

**Approvals**

Approvals



ROHS Conform

**Downloads**

Brochure/Catalogue	<a href="#">CAT 6 TOOLS 15/16 EN</a>
Engineering Data	<a href="#">EPLAN, WSCAD, Zuken E3.S</a>
Engineering Data	<a href="#">STEP</a>

**Data sheet**

**Connecting elements**  
**H35,0/30 BE**

**Weidmüller Interface GmbH & Co. KG**  
Klingenbergstraße 26  
D-32758 Detmold  
Germany  
Fon: +49 5231 14-0  
Fax: +49 5231 14-292083  
www.weidmueller.com

**Drawings**

**Drawing**

