

Pushbutton Switches

Sub-Miniature

multicomp PRO

**RoHS
Compliant**



Specifications

Contact Rating	: Dependent upon contact material
Mechanical life	: 50,000 make-and-break cycles
Max. Contact Resistance	: 20mΩ initial at 2-4V DC 100mA for both silver and gold plated contacts
Min. Insulation Resistance	: 1,000MΩ
Dielectric Strength	: 1,000Vrms at sea level
Operating Temperature	: -30°C to 85°C
Materials:	
Case and Bushing	: Glass filled nylon 4/6, flame retardant, heat stabilized
Plunger	: Thermoplastic Polyester with internal O-ring seal
Switch Support	: Brass tin plated
Contact / Terminals	: Silver or gold plated copper alloy

Switch Function

Number of Poles	Part Number	Switch Function		Connected Terminals / Schematic	
		Position 1	Position 2	Position 1	Position 2
SP	MC8BS8	ON	MOM	2-1 NC 1 → 2 (Comm) → 3 NO	2-3 NC 1 → 2 (Comm) → 3 NO
	MC8BS9	OFF	MOM	Open	1-3

MOM = Momentary

Pole Options SPDT



MC8BS8MTRES

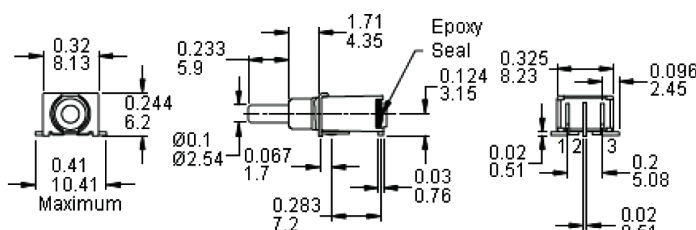

PC Mounting

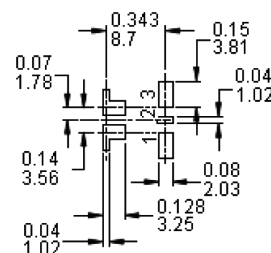

Dimensions : Inches (Millimetres)

Newark.com/multicomp-pro
Farnell.com/multicomp-pro
Element14.com/multicomp-pro

multicomp PRO

Pushbutton Switches

Sub-Miniature



Pole Options

SPST



MC8BS9MZRES

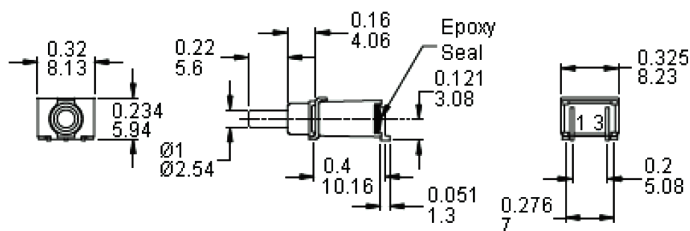

PC Mounting

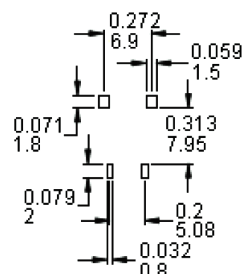

Dimensions : Inches (Millimetres)

Contact Material Options

	Contact Plating	Terminal Plating	Ratings
R	Gold	R = Gold	0.4 Volt - Amperes (VA) maximum at 20 V maximum (AC or DC)

Soldering Process:

- Manual Soldering : Use soldering iron of 30 watts, controlled at 350°C approximately 5 seconds while applying solder
- Wave Soldering : Recommended soldering temperature : 260 ±5°C
Duration of solder immersion : Maximum 5 seconds (PCB is 1.6mm in thickness)
- Soldering : Vapour phase and IR-reflow soldering can be applied

Temperature Profile

Zone	Room Temperature	Time (s)
Pre-heat (A)	150°C	Min. 120s
Soak (B)	180°C to 200°C	Min. 150s
Peak (C)	200°C to 235°C	Min. 30s
Peak (D)	235°C to 260°C	Min. 40s
Peak (E)	260°C	Max. 5s

Temperature Profile

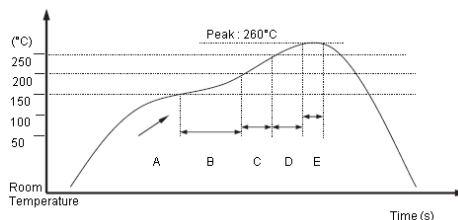

Part Number Table

Description	Part Number
Switch, SPDT, On-MOM, SMD, Sealed	MC8BS8MTRES
Switch, SPST, On-MOM, SMD, Right / Angle, Sealed	MC8BS9MZRES

Important Notice : This data sheet and its contents (the "Information") belong to the members of the AVNET group of companies (the "Group") or are licensed to it. No licence is granted for the use of it other than for information purposes in connection with the products to which it relates. No licence of any intellectual property rights is granted. The Information is subject to change without notice and replaces all data sheets previously supplied. The Information supplied is believed to be accurate but the Group assumes no responsibility for its accuracy or completeness, any error in or omission from it or for any use made of it. Users of this data sheet should check for themselves the Information and the suitability of the products for their purpose and not make any assumptions based on information included or omitted. Liability for loss or damage resulting from any reliance on the Information or use of it (including liability resulting from negligence or where the Group was aware of the possibility of such loss or damage arising) is excluded. This will not operate to limit or restrict the Group's liability for death or personal injury resulting from its negligence. Multicomp Pro is the registered trademark of Premier Farnell Limited 2019.

Newark.com/multicomp-pro
Farnell.com/multicomp-pro
Element14.com/multicomp-pro

