



<b>Title of Change:</b>	Tube design change for TO220 single gauge package in Nantong Huada
<b>Proposed First Ship date:</b>	05 Mar 2021 or earlier if approved by customer
<b>Contact Information:</b>	Contact your local ON Semiconductor Sales Office or <a href="mailto:Jaroslav.Supina@onsemi.com">Jaroslav.Supina@onsemi.com</a>
<b>PCN Samples Contact:</b>	Contact your local ON Semiconductor Sales Office or < <a href="mailto:PCN.samples@onsemi.com">PCN.samples@onsemi.com</a> >. Sample requests are to be submitted no later than 30 days from the date of first notification, Initial PCN or Final PCN, for this change. Samples delivery timing will be subject to request date, sample quantity and special customer packing/label requirements.
<b>Additional Reliability Data:</b>	Contact your local ON Semiconductor Sales Office
<b>Type of Notification:</b>	This is a Final Product/Process Change Notification (FPCN) sent to customers. FPCNs are issued 90 days prior to implementation of the change. ON Semiconductor will consider this change accepted, unless an inquiry is made in writing within 30 days of delivery of this notice. To do so, contact <a href="mailto:PCN.Support@onsemi.com">PCN.Support@onsemi.com</a>
<b>Marking of Parts/ Traceability of Change:</b>	The affected products will be identified with date code.
<b>Change Category:</b>	Shipping material change
<b>Change Sub-Category(s):</b>	Shipping/Packaging/Marking

**Sites Affected:**

ON Semiconductor Sites	External Foundry/Subcon Sites
None	Nantong Huada Microelectronics, China

**Description and Purpose:**

On Semiconductor is changing shipping material of tubes for TO220 single gauge package in Nantong Huada, China. Dimensions will be same as for products from alternative On Semiconductor location in Seremban, Malaysia

Dimensions B1 and D1 will be changed – see sectional view below.

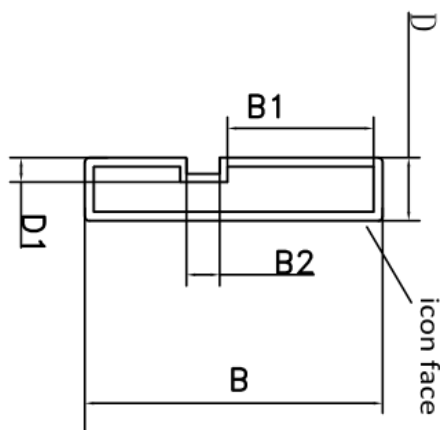



	Before Change Description	After Change Description
Dimension B1	17.4±0.25 mm	16.4-0/+0.5 mm
Dimension D1	2.65±0.25 mm	2.7±0.25 mm

Change of dimension B1 and D1 reduces the product movable space in tubes, less risk of rotated devices in tubes. No change for other dimensions.

There is no product marking change as a result of this change.

**Reliability Data Summary:**

No reliability tests on affected devices. Process acceptance tests have been performed only.

Test	Test Conditions	Specification	Sample Size	Results
Base material property	Product Spec	MSDS, ROHS & C of C Standard	-	PASS
Dimensions	Drawing	GHA.SZ.06.269	5 Tubes	PASS
ESD	Two points electrode test	ESD Standard	5 Tubes	PASS
Drop Test	drop test method	no PKG lying down Waggle each tube 10 times Drop each tube from 1m height 10 times	1 Tube	PASS
Functionality	Actual tape and reel setup	No jamming and No machine compatibility issues	60 tubes Every machine	PASS

**Electrical Characteristics Summary:**

Electrical characteristics are not impacted.

**List of Affected Parts:**

**Note:** Only the standard (off the shelf) part numbers are listed in the parts list. Any custom parts affected by this PCN are shown in the customer specific PCN addendum in the PCN email notification, or on the **PCN Customized Portal**.

Part Number	Qualification Vehicle
LM2931AT-5.0G	MC7805CTG
LM2931T-5.0G	MC7805CTG
MC7809ABTG	MC7805CTG
SCD317MABTG	MC7805CTG
SCD317MTG	MC7805CTG



SCD33269TG	MC7805CTG
SCD337TG	MC7805CTG
SCD7805ACTG	MC7805CTG
SCD7805BTG	MC7805CTG
SCD7805CTG	MC7805CTG
SCD7806CTG	MC7805CTG
SCD7809ACTG	MC7805CTG
SCD7809BTG	MC7805CTG
SCD7809CTG	MC7805CTG
SCD7812BTG	MC7805CTG
SCD7812CTG	MC7805CTG
SCD7815ACTG	MC7805CTG
SCD7815BTG	MC7805CTG
SCD7815CTG	MC7805CTG
SCD7818BTG	MC7805CTG
SCD7824BTG	MC7805CTG
SCD7824CTG	MC7805CTG
SCD78M05CTG	MC7805CTG
SCD78M09CTG	MC7805CTG
SCD78M12CTG	MC7805CTG
SCD78M15BTG	MC7805CTG
SCD7905ACTG	MC7805CTG
SCD7905CTG	MC7805CTG
SCD7912ACTG	MC7805CTG
SCD7912BTG	MC7805CTG
SCD7912CTG	MC7805CTG
SCD7915CTG	MC7805CTG
SCD79M12CTG	MC7805CTG
SC7805CTG	MC7805CTG
SC7812CTG	MC7805CTG
SCD33269T-5.0G	MC7805CTG
SCD337BTG	MC7805CTG
MC78M18CTG	MC7805CTG
LM317MABTG	MC7805CTG



LM317MBTG	MC7805CTG
MC33269T-012G	MC7805CTG
MC33269T-3.3G	MC7805CTG
MC33269T-3.5G	MC7805CTG
MC33269T-5.0G	MC7805CTG
MC33269TG	MC7805CTG
MC7806ACTG	MC7805CTG
MC7806BTG	MC7805CTG
MC7808ACTG	MC7805CTG
MC7809ACTG	MC7805CTG
MC7809BTG	MC7805CTG
MC7815ACTG	MC7805CTG
MC78M05ABTG	MC7805CTG
MC78M05ACTG	MC7805CTG
MC78M06BTG	MC7805CTG
MC78M06CTG	MC7805CTG
MC78M08ABTG	MC7805CTG
MC78M08BTG	MC7805CTG
MC78M08CTG	MC7805CTG
MC78M09CTG	MC7805CTG
MC78M12ACTG	MC7805CTG
MC78M15ABTG	MC7805CTG
MC78M15ACTG	MC7805CTG
MC78M18BTG	MC7805CTG
MC78M24BTG	MC7805CTG
MC78M24CTG	MC7805CTG
MC7905.2CTG	MC7805CTG
MC7905ACTG	MC7805CTG
MC7908ACTG	MC7805CTG
MC7908CTG	MC7805CTG
MC7912ACTG	MC7805CTG
MC79M05BTG	MC7805CTG
MC79M05CTG	MC7805CTG
MC79M08BTG	MC7805CTG



MC79M08CTG	MC7805CTG
SCD317BTG	MC7805CTG
LM317BTG	MC7805CTG
LM317MTG	MC7805CTG
LM317TG	MC7805CTG
LM337BTG	MC7805CTG
LM337TG	MC7805CTG
MC7805ABTG	MC7805CTG
MC7805ACTG	MC7805CTG
MC7805BTG	MC7805CTG
MC7805CTG	MC7805CTG
MC7806CTG	MC7805CTG
MC7808ABTG	MC7805CTG
MC7808BTG	MC7805CTG
MC7808CTG	MC7805CTG
MC7809CTG	MC7805CTG
MC7812ABTG	MC7805CTG
MC7812ACTG	MC7805CTG
MC7812BTG	MC7805CTG
MC7812CTG	MC7805CTG
MC7815ABTG	MC7805CTG
MC7815BTG	MC7805CTG
MC7815CTG	MC7805CTG
MC7818ACTG	MC7805CTG
MC7818BTG	MC7805CTG
MC7818CTG	MC7805CTG
MC7824ACTG	MC7805CTG
MC7824BTG	MC7805CTG
MC7824CTG	MC7805CTG
MC78M05BTG	MC7805CTG
MC78M05CTG	MC7805CTG
MC78M08ACTG	MC7805CTG
MC78M12ABTG	MC7805CTG
MC78M12BTG	MC7805CTG



MC78M12CTG	MC7805CTG
MC78M15BTG	MC7805CTG
MC78M15CTG	MC7805CTG
MC78M20CTG	MC7805CTG
MC7905BTG	MC7805CTG
MC7905CTG	MC7805CTG
MC7906CTG	MC7805CTG
MC7912BTG	MC7805CTG
MC7912CTG	MC7805CTG
MC7915ACTG	MC7805CTG
MC7915BTG	MC7805CTG
MC7915CTG	MC7805CTG
MC7918CTG	MC7805CTG
MC7924BTG	MC7805CTG
MC7924CTG	MC7805CTG
MC79M12BTG	MC7805CTG
MC79M12CTG	MC7805CTG
MC79M15BTG	MC7805CTG
MC79M15CTG	MC7805CTG